

Agenda

Licensing sub-committee

Date: **Wednesday 19 August 2020**

Time: **10.30 am**

Place: **Online meeting only**

Notes: Please note the time, date and venue of the meeting.

For any further information please contact:

Caroline Marshall, Democratic Services

Tel: 01432 260249

Email: caroline.marshall3@herefordshire.gov.uk

If you would like help to understand this document, or would like it in another format, please call Caroline Marshall, Democratic Services on 01432 260249 or e-mail caroline.marshall3@herefordshire.gov.uk in advance of the meeting.

Agenda for the Meeting of the Licensing sub-committee

Membership

Councillor Alan Seldon

Agenda

	Pages
1. APOLOGIES FOR ABSENCE To receive apologies for absence.	
2. NAMED SUBSTITUTES (IF ANY) To receive any details of Members nominated to attend the meeting in place of a Member of the committee.	
3. DECLARATIONS OF INTEREST To receive declarations of interests in respect of Schedule 1, Schedule 2 or Other Interests from members of the committee in respect of items on the agenda.	
4. APPLICATION FOR A GRANT OF A PREMISES LICENCE IN RESPECT OF 'REDBANK BARN EVENTS, REDBANK BARN, NEW GROVES LANE, HAMPTON BISHOP, HEREFORD. HR1 4LD'- LICENSING ACT 2003 To consider an application for a grant of a premise licence in respect of Redbank Barn Events, Redbank Barn, New Groves Lane, Hampton Bishop, Hereford. HR1 4LD. <i>Adjourned from 6 August 2020</i>	9 - 62
5. APPLICATION FOR A GRANT OF A PREMISES LICENCE IN RESPECT OF 'GILLOW CIDER, GILLOW MANOR, ST OWENS CROSS, HEREFORD. HR2 8LE'- LICENSING ACT 2003 To consider an application for a grant of a premise licence in respect of Gillow Cider, Gillow Manor, St Owens Cross, Hereford. HR2 8LE	63 - 164

The public's rights to information and attendance at meetings

You have a right to: -

- Attend all council, cabinet, committee and sub-committee meetings unless the business to be transacted would disclose 'confidential' or 'exempt' information. This meeting will be broadcast live on the Herefordshire Council's YouTube channel. Link: <https://www.youtube.com/HerefordshireCouncil>
- Inspect agenda and public reports at least five clear days before the date of the meeting via the website.
- Inspect minutes of the council and all committees and sub-committees and written statements of decisions taken by the cabinet or individual cabinet members for up to six years following a meeting.
- Inspect background papers used in the preparation of public reports for a period of up to four years from the date of the meeting. (A list of the background papers to a report is given at the end of each report). A background paper is a document on which the officer has relied in writing the report and which otherwise is not available to the public.
- Access to a public register stating the names, addresses and wards of all councillors with details of the membership of cabinet and of all committees and sub-committees.
- Have access to a list specifying those powers on which the council have delegated decision making to their officers identifying the officers concerned by title.
- Copy any of the documents mentioned above to which you have a right of access, subject to a reasonable charge (20p per sheet subject to a maximum of £5.00 per agenda plus a nominal fee of £1.50 for postage).
- Access to this summary of your rights as members of the public to attend meetings of the council, cabinet, committees and sub-committees and to inspect and copy documents.

Recording of this meeting

Please note that the council will be making an official recording of this public meeting. These recordings form part of the public record of the meeting and are made available for members of the public via the council's website.

To ensure that recording quality is maintained, could members and any attending members of the public speak as clearly as possible and keep background noise to a minimum while recording is in operation.

Please also note that other attendees are permitted to film, photograph and record our public meetings provided that it does not disrupt the business of the meeting.

If you do not wish to be filmed or photographed, please identify yourself so that anyone who intends to record the meeting can be made aware.

Please ensure that your mobile phones and other devices are turned to silent during the meeting.

The reporting of meetings is subject to the law and it is the responsibility of those doing the reporting to ensure that they comply.

Licensing Hearing Flowchart

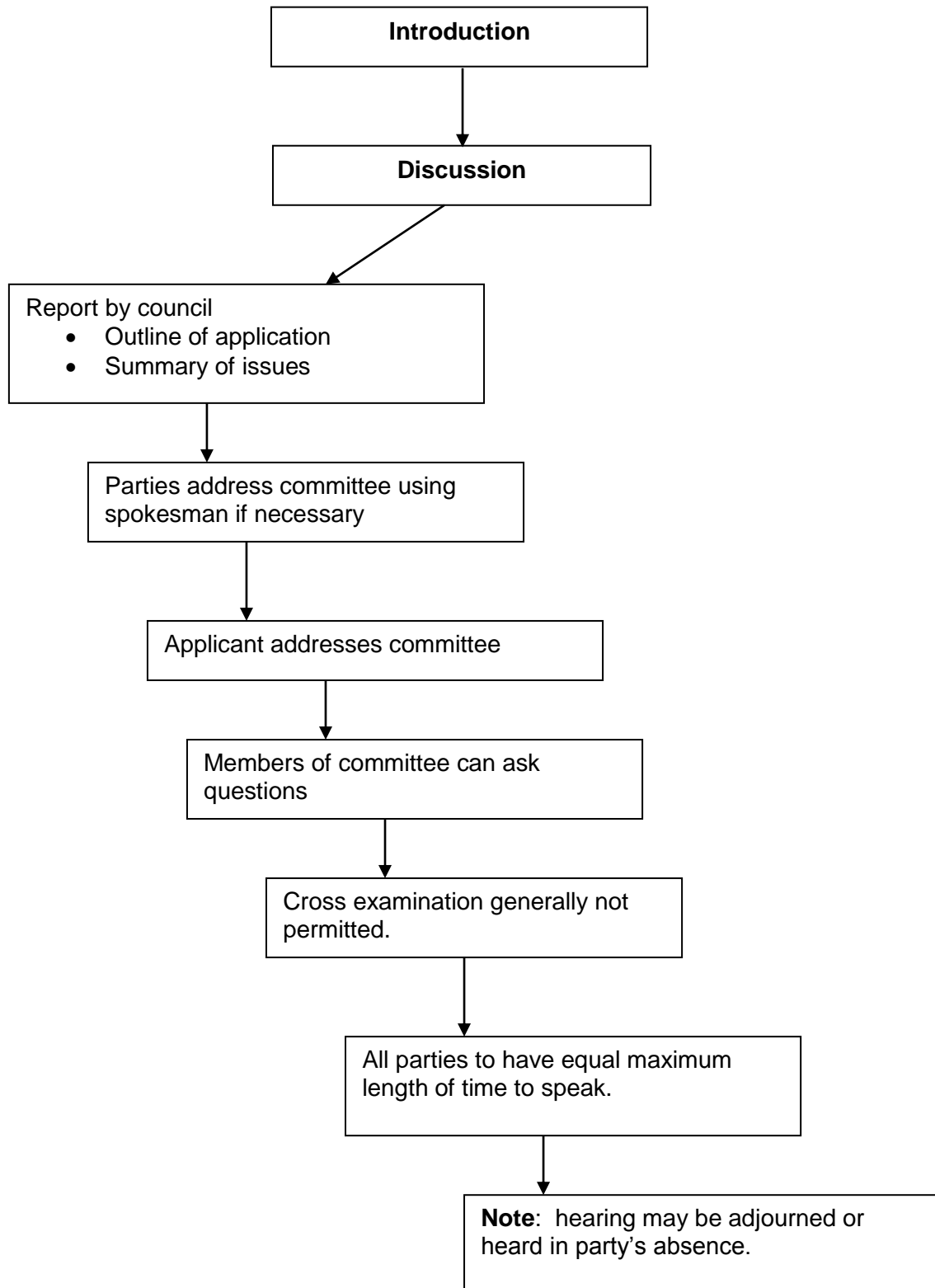



Meeting:	Licensing sub-committee
Meeting date:	19th August 2020
Title of report:	Application for a grant of a premises licence in respect of 'Redbank Barn Events, Redbank Barn, New Groves Lane, Hampton Bishop, Hereford. HR1 4LD' – Licensing Act 2003
Report by:	Licensing Technical Officer

Classification

Open

Key Decision

This is not an executive decision.

Wards Affected

Backbury

Purpose

To consider an application for a grant of a premise licence in respect of Redbank Barn Events, Redbank Barn, New Groves Lane, Hampton Bishop, Hereford. HR1 4LD

Recommendation

THAT:

The sub committee determine the application with a view to promoting the licensing objectives in the overall interests of the local community. They should give appropriate weight to:

- **The steps that are appropriate to promote the licensing objectives,**
- **The representations (including supporting information) presented by all parties,**
- **The guidance issued to local authorities under Section 182 of the Licensing Act 2003, and**
- **The Herefordshire Council Statement of Licensing Policy 2015 - 2020.**

Options

1. There are a number of options open to the sub-committee:

- a) Grant the licence subject to conditions that are consistent with the operating schedule accompanying the application and the mandatory conditions set out in the Licensing Act 2003,
- b) Grant the licence subject to modified conditions to that of the operating schedule where the sub-committee considers it appropriate for the promotion of the licensing objectives and add mandatory conditions set out in the Licensing Act 2003,
- c) To exclude from the scope of the licence any of the licensable activities to which the application relates
- d) To refuse to specify a person in the licence as the premise supervisor, or
- e) To reject the application.

Reasons for Recommendations

- 2. Ensures compliance with the Licensing Act 2003.

Key Considerations

Licence Application

- 3. The application for the grant of a premises licence has received relevant representations and is brought before the sub-committee for determination.
- 4. The details of the application are:

Applicant	Claypitt Limited	
Agent	The Licensing Guys	
Type of application: Grant	Date received: 10 th June 2020	28 Days consultation ended 8 th July 2020

Summary of Application

- 5. The application (appendix 1) requests the grant of a premises licence to allow the following licensable activities, during the hours shown, as follows:

Films (Indoors), Live Music (Indoors/Outdoors), Recorded Music (Indoors/Outdoors), Sale/Supply of Alcohol (consumption on and off the premises)

Sunday – Thursday 10:00 – 24:00

Friday – Saturday 10:00 – 01:00

Late Night Refreshment (Indoors/Outdoors)

Sunday – Thursday 23:00 – 24:00

Friday – Saturday 23:00 – 01:00

6. This matter appeared before this committee on 6th August 2020 and was deferred until today, due to the applicant and the applicant's agent not seeing sight of the supplement that was published on behalf of Environmental Health.

Summary of Representations

7. Two (2) representations have been received from the responsible authorities (Trading Standards and Environmental Health). The representation from Trading Standards has been agreed by the applicant and can be found at appendix 2.
8. Since the date the representation made by Environmental Health (appendix 3), there has been an on-site meeting with the applicant and applicant's agent. The applicant's agent has provided notes of the meeting (appendix 4) and a list of conditions has been complied by Environmental Health for consideration by the applicant and their agent (Appendix 5).
9. At the time of publishing the report, all but two (2) conditions have been agreed. The conditions that are left outstanding are in relation to the terminal hour for Live Music and a condition relating to a large double door remaining closed.
10. Environmental Health have provided further details and supporting evidence (Appendix 6) in relation to their objection.
11. As all the proposed Environmental Health conditions have not been agreed, their representation objecting to the application remains.
12. No other representations have been received from either the responsible authorities or members of the public.

Community Impact

13. Any decision is unlikely to have any impact on the local community.

Equality duty

14. There are no equality issues in relation to the content of this report.
15. This report has human rights implications for both the premises licence holder and the residents from the local neighbourhood. Any of the steps outlined in section 1 of this report may have financial implications for a licensee's business and livelihood and/or may have impact upon the day to day lives of residents living in close proximity to the premises.
16. Article 8(i) of the European Convention of Human Rights provides that everyone has the right to respect for his/her private and family life and his/her home (which includes business premises). This right may be interfered with by the council on a number of grounds including the protection of rights and freedoms of others. The First Protocol – Article 1 – also provides that every person is entitled to the peaceful enjoyment of his possessions and shall not be deprived of his possessions except in the public interest and conditions provided for by law. Members must accordingly make a decision which

is proportionate to the hearing and endeavour to find a balance between the rights of the applicant, residents and the community as a whole.

Financial implications

17. There are unlikely to be any financial implications for the authority at this time.

Legal Implications

18. As relevant representations have been received, the sub committee must determine the application under Section 3.5.7 (c) of the Herefordshire Council constitution. The representations must relate to the licensing objectives and the sub committee must determine the likely effect of the grant of the premises licences on the promotion of the licensing objectives.
19. The licensing authority must have regard to the promotion of the four licensing objectives namely; the prevention of crime and disorder; public safety; the prevention of public nuisance; and the protection of children from harm in exercising its functions under the Licensing Act 2003. Further regard should be had to the statutory guidance under Section 182 of the Act and the Council's own statement of licensing policy. The options available to the licensing authority are set out in section 1 of this report.
20. The sub committee should be aware of a number of stated cases which have appeared before the Administrative Court and are binding on the Licensing Authority.
21. The case of Daniel Thwaites Plc v Wirral Borough Magistrates' Court (Case No: CO/5533/2006) at the High Court of Justice Queen's Bench Division Administrative Court on 6 May 2008, [2008] EWHC 838 (Admin), 2008 WL 1968943, Before the Honourable Mrs Justice Black. In this case it was summed up that: -

A licensing authority must have regard to guidance issued by the Secretary of State under section 182. Licensing authorities may depart from it if they have reason to do so but will need to give full reasons for their actions.
22. Furthermore the Thwaites case established that only conditions should be attached to a licence with a view to promoting the Licensing objectives and that 'real evidence' must be presented to support the reason for imposing these conditions.
23. This judgement is further supported in the case of The Queen on the Application of Bristol Council v Bristol Magistrates' Court, CO/6920/2008 High Court of Justice Queen's Bench Division The Administrative Court, 24 February 2009, [2009] EWHC 625 (Admin) 2009 WL 648859 in which it was said:

'Licensing authorities should only impose conditions which are necessary and proportionate for the promotion for licensing objectives'.
24. In addition to this it was stated that any condition attached to the licence should be an enforceable condition.

Right of Appeal

25. Schedule 5 of the Licensing Act 2003 gives a right of appeal which states:

Decision to grant premises licence or impose conditions etc.

- (1) This paragraph applies where a licensing authority grants a premises licence under section 18.
 - (2) The holder of the licence may appeal against any decision—
 - (a) to impose conditions on the licence under subsection (2)(a) or (3)(b) of that section, or
 - (b) to take any step mentioned in subsection (4)(b) or (c) of that section (exclusion of licensable activity or refusal to specify person as premises supervisor).
 - (3) Where a person who made relevant representations in relation to the application desires to contend—
 - (a) that the licence ought not to have been granted, or
 - (b) that, on granting the licence, the licensing authority ought to have imposed different or additional conditions, or to have taken a step mentioned in subsection (4)(b) or (c) of that section,he may appeal against the decision.
 - (4) In sub-paragraph (3) “relevant representations” has the meaning given in section 18(6).
26. Appeals should be made to the Magistrates Court and must be made within 21 days beginning with the day on which the appellant was notified by the licensing authority of the decision appealed against

Risk Management

27. There is little risk associated with the decision at this time as the legislation allows a right of appeal to the Magistrates Court within a period of 21 days of being notified of the decision in writing.

Consultees

28. All responsible authorities and members of the public living within Herefordshire.

Appendices

Appendix 1 - Application Form
Appendix 2 – Trading Standards representation
Appendix 3 – Environmental Health Objection
Appendix 4 – Site Visit Meeting Notes
Appendix 5 – Environmental Health Proposed Conditions
Appendix 6 – Environmental Health Supporting evidence

Background Papers

None.



Herefordshire
Application for a premises licence
Licensing Act 2003

For help contact
licensing@herefordshire.gov.uk
Telephone: 01432 261761

* required information

Section 1 of 21

You can save the form at any time and resume it later. You do not need to be logged in when you resume.

System reference	<input type="text" value="Not Currently In Use"/>	This is the unique reference for this application generated by the system.
Your reference	<input type="text" value="50-20"/>	You can put what you want here to help you track applications if you make lots of them. It is passed to the authority.

Are you an agent acting on behalf of the applicant?

Yes No

Put "no" if you are applying on your own behalf or on behalf of a business you own or work for.

Applicant Details

* First name	<input type="text" value="Claypitt Limited"/>	
* Family name	<input type="text" value="Claypitt Limited"/>	
* E-mail	<input type="text" value="info@redbankevents.co.uk"/>	
Main telephone number	<input type="text" value="07770 376548"/>	Include country code.
Other telephone number	<input type="text" value="07770 376548"/>	

Indicate here if the applicant would prefer not to be contacted by telephone

Is the applicant:

Applying as a business or organisation, including as a sole trader

Applying as an individual

A sole trader is a business owned by one person without any special legal structure. Applying as an individual means the applicant is applying so the applicant can be employed, or for some other personal reason, such as following a hobby.

Applicant Business

Is the applicant's business registered in the UK with Companies House? Yes No

Note: completing the Applicant Business section is optional in this form.

Registration number	<input type="text" value="10450044"/>	
Business name	<input type="text" value="Claypitt Ltd"/>	If the applicant's business is registered, use its registered name.
VAT number	<input type="text" value="-"/> <input type="text" value="None"/>	Put "none" if the applicant is not registered for VAT.
Legal status	<input type="text" value="Private Limited Company"/>	

Continued from previous page...

Applicant's position in the business

Home country

The country where the applicant's headquarters are.

Registered Address

Address registered with Companies House.

Building number or name

Street

District

City or town

County or administrative area

Postcode

Country

Agent Details

* First name

* Family name

* E-mail

Main telephone number

Include country code.

Other telephone number

Indicate here if you would prefer not to be contacted by telephone

Are you:

An agent that is a business or organisation, including a sole trader

A sole trader is a business owned by one person without any special legal structure.

A private individual acting as an agent

Agent Business

Is your business registered in the UK with Companies House? Yes No

Note: completing the Applicant Business section is optional in this form.

Is your business registered outside the UK? Yes No

Business name

If your business is registered, use its registered name.

VAT number

Put "none" if you are not registered for VAT.

Legal status

Continued from previous page...

Your position in the business

Home country

The country where the headquarters of your business is located.

Agent Business Address

If you have one, this should be your official address - that is an address required of you by law for receiving communications.

Building number or name

Street

District

City or town

County or administrative area

Postcode

Country

Section 2 of 21

PREMISES DETAILS

I/we, as named in section 1, apply for a premises licence under section 17 of the Licensing Act 2003 for the premises described in section 2 below (the premises) and I/we are making this application to you as the relevant licensing authority in accordance with section 12 of the Licensing Act 2003.

Premises Address

Are you able to provide a postal address, OS map reference or description of the premises?

- Address OS map reference Description

Postal Address Of Premises

Building number or name

Street

District

City or town

County or administrative area

Postcode

Country

Further Details

Telephone number

Non-domestic rateable value of premises (£)

Section 3 of 21**APPLICATION DETAILS**

In what capacity are you applying for the premises licence?

- An individual or individuals
- A limited company / limited liability partnership
- A partnership (other than limited liability)
- An unincorporated association
- Other (for example a statutory corporation)
- A recognised club
- A charity
- The proprietor of an educational establishment
- A health service body
- A person who is registered under part 2 of the Care Standards Act 2000 (c14) in respect of an independent hospital in Wales
- A person who is registered under Chapter 2 of Part 1 of the Health and Social Care Act 2008 in respect of the carrying on of a regulated activity (within the meaning of that Part) in an independent hospital in England
- The chief officer of police of a police force in England and Wales

Confirm The Following

- I am carrying on or proposing to carry on a business which involves the use of the premises for licensable activities
- I am making the application pursuant to a statutory function
- I am making the application pursuant to a function discharged by virtue of Her Majesty's prerogative

Section 4 of 21**NON INDIVIDUAL APPLICANTS**

Provide name and registered address of applicant in full. Where appropriate give any registered number. In the case of a partnership or other joint venture (other than a body corporate), give the name and address of each party concerned.

Non Individual Applicant's Name

Name

Details

Registered number (where applicable)

Description of applicant (for example partnership, company, unincorporated association etc)

Continued from previous page...

Limited Company

Address

Building number or name

Street

District

City or town

County or administrative area

Postcode

Country

Contact Details

E-mail

Telephone number

Other telephone number

* Date of birth

* Nationality

Documents that demonstrate entitlement to work in the UK

Section 5 of 21

OPERATING SCHEDULE

When do you want the premises licence to start? / /
dd mm yyyy

If you wish the licence to be valid only for a limited period, when do you want it to end / /
dd mm yyyy

Provide a general description of the premises

For example the type of premises, its general situation and layout and any other information which could be relevant to the licensing objectives. Where your application includes off-supplies of alcohol and you intend to provide a place for consumption of these off- supplies you must include a description of where the place will be and its proximity to the premises.

The Red Barn is a business that provides barn wedding and event facilities on a working farm overlooking the River Wye. It is currently registered for Marriages and already operates under a succession of Temporary Event Notices. The volume of bookings has grown rapidly and has outgrown the current model of applying for TENs for individual events.

Continued from previous page...

If 5,000 or more people are expected to attend the premises at any one time, state the number expected to attend

Section 6 of 21

PROVISION OF PLAYS

See guidance on regulated entertainment

Will you be providing plays?

Yes

No

Section 7 of 21

PROVISION OF FILMS

See guidance on regulated entertainment

Will you be providing films?

Yes

No

Standard Days And Timings

MONDAY

Start

End

Start

End

Give timings in 24 hour clock. (e.g., 16:00) and only give details for the days of the week when you intend the premises to be used for the activity.

TUESDAY

Start

End

Start

End

WEDNESDAY

Start

End

Start

End

THURSDAY

Start

End

Start

End

FRIDAY

Start

End

Start

End

SATURDAY

Start

End

Start

End

Continued from previous page...

SUNDAY

Start

End

Start

End

Will the exhibition of films take place indoors or outdoors or both?

- Indoors Outdoors Both

Where taking place in a building or other structure tick as appropriate. Indoors may include a tent.

State type of activity to be authorised, if not already stated, and give relevant further details, for example (but not exclusively) whether or not music will be amplified or unamplified.

State any seasonal variations for the exhibition of film

For example (but not exclusively) where the activity will occur on additional days during the summer months.

Non standard timings. Where the premises will be used for the exhibition of film at different times from those listed in the column on the left, list below

For example (but not exclusively), where you wish the activity to go on longer on a particular day e.g. Christmas Eve.

Section 8 of 21

PROVISION OF INDOOR SPORTING EVENTS

See guidance on regulated entertainment

Will you be providing indoor sporting events?

- Yes No

Section 9 of 21

PROVISION OF BOXING OR WRESTLING ENTERTAINMENTS

See guidance on regulated entertainment

Will you be providing boxing or wrestling entertainments?

- Yes No

Section 10 of 21

PROVISION OF LIVE MUSIC

See guidance on regulated entertainment

Will you be providing live music?

Continued from previous page...

Standard Days And Timings

MONDAY

Start

End

Start

End

Give timings in 24 hour clock.
(e.g., 16:00) and only give details for the days
of the week when you intend the premises
to be used for the activity.

TUESDAY

Start

End

Start

End

WEDNESDAY

Start

End

Start

End

THURSDAY

Start

End

Start

End

FRIDAY

Start

End

Start

End

SATURDAY

Start

End

Start

End

SUNDAY

Start

End

Start

End

Will the performance of live music take place indoors or outdoors or both?

- Indoors Outdoors Both

Where taking place in a building or other
structure tick as appropriate. Indoors may
include a tent.

State type of activity to be authorised, if not already stated, and give relevant further details, for example (but not exclusively) whether or not music will be amplified or unamplified.

State any seasonal variations for the performance of live music

For example (but not exclusively) where the activity will occur on additional days during the summer months.

Continued from previous page...

Non-standard timings. Where the premises will be used for the performance of live music at different times from those listed in the column on the left, list below

For example (but not exclusively), where you wish the activity to go on longer on a particular day e.g. Christmas Eve.

Section 11 of 21

PROVISION OF RECORDED MUSIC

See guidance on regulated entertainment

Will you be providing recorded music?

Yes No

Standard Days And Timings

MONDAY

Start

End

Start

End

Give timings in 24 hour clock.
(e.g., 16:00) and only give details for the days
of the week when you intend the premises
to be used for the activity.

TUESDAY

Start

End

Start

End

WEDNESDAY

Start

End

Start

End

THURSDAY

Start

End

Start

End

FRIDAY

Start

End

Start

End

SATURDAY

Start

End

Start

End

Continued from previous page...

SUNDAY

Start

End

Start

End

Will the playing of recorded music take place indoors or outdoors or both?

- Indoors Outdoors Both

Where taking place in a building or other structure tick as appropriate. Indoors may include a tent.

State type of activity to be authorised, if not already stated, and give relevant further details, for example (but not exclusively) whether or not music will be amplified or unamplified.

State any seasonal variations for playing recorded music

For example (but not exclusively) where the activity will occur on additional days during the summer months.

Non-standard timings. Where the premises will be used for the playing of recorded music at different times from those listed in the column on the left, list below

For example (but not exclusively), where you wish the activity to go on longer on a particular day e.g. Christmas Eve.

Section 12 of 21

PROVISION OF PERFORMANCES OF DANCE

See guidance on regulated entertainment

Will you be providing performances of dance?

- Yes No

Section 13 of 21

PROVISION OF ANYTHING OF A SIMILAR DESCRIPTION TO LIVE MUSIC, RECORDED MUSIC OR PERFORMANCES OF DANCE

See guidance on regulated entertainment

Will you be providing anything similar to live music, recorded music or performances of dance?

- Yes No

Section 14 of 21

LATE NIGHT REFRESHMENT

Will you be providing late night refreshment?

Continued from previous page...

Standard Days And Timings

MONDAY

Start

End

Start

End

Give timings in 24 hour clock.
(e.g., 16:00) and only give details for the days
of the week when you intend the premises
to be used for the activity.

TUESDAY

Start

End

Start

End

WEDNESDAY

Start

End

Start

End

THURSDAY

Start

End

Start

End

FRIDAY

Start

End

Start

End

SATURDAY

Start

End

Start

End

SUNDAY

Start

End

Start

End

Will the provision of late night refreshment take place indoors or outdoors or both?

- Indoors Outdoors Both

Where taking place in a building or other structure tick as appropriate. Indoors may include a tent.

State type of activity to be authorised, if not already stated, and give relevant further details, for example (but not exclusively) whether or not music will be amplified or unamplified.

State any seasonal variations

Continued from previous page...

For example (but not exclusively) where the activity will occur on additional days during the summer months.

Non-standard timings. Where the premises will be used for the supply of late night refreshments at different times from those listed in the column on the left, list below

For example (but not exclusively), where you wish the activity to go on longer on a particular day e.g. Christmas Eve.

Section 15 of 21

SUPPLY OF ALCOHOL

Will you be selling or supplying alcohol?

Yes No

Standard Days And Timings

MONDAY

Start

End

Start

End

Give timings in 24 hour clock.
(e.g., 16:00) and only give details for the days
of the week when you intend the premises
to be used for the activity.

TUESDAY

Start

End

Start

End

WEDNESDAY

Start

End

Start

End

THURSDAY

Start

End

Start

End

FRIDAY

Start

End

Start

End

SATURDAY

Start

End

Start

End

Continued from previous page...

SUNDAY

Start

End

Start

End

Will the sale of alcohol be for consumption:

- On the premises Off the premises Both

If the sale of alcohol is for consumption on the premises select on, if the sale of alcohol is for consumption away from the premises select off. If the sale of alcohol is for consumption on the premises and away from the premises select both.

State any seasonal variations

For example (but not exclusively) where the activity will occur on additional days during the summer months.

None

Non-standard timings. Where the premises will be used for the supply of alcohol at different times from those listed in the column on the left, list below

For example (but not exclusively), where you wish the activity to go on longer on a particular day e.g. Christmas Eve.

State the name and details of the individual whom you wish to specify on the licence as premises supervisor

Name

First name

Family name

Date of birth

Continued from previous page...

Enter the contact's address

Building number or name

Street

District

City or town

County or administrative area

Postcode

Country

Personal Licence number
(if known)

Issuing licensing authority
(if known)

Herefordshire

PROPOSED DESIGNATED PREMISES SUPERVISOR CONSENT

How will the consent form of the proposed designated premises supervisor be supplied to the authority?

- Electronically, by the proposed designated premises supervisor
- As an attachment to this application

Reference number for consent form (if known)

50-20

If the consent form is already submitted, ask the proposed designated premises supervisor for its 'system reference' or 'your reference'.

Section 16 of 21

ADULT ENTERTAINMENT

Highlight any adult entertainment or services, activities, or other entertainment or matters ancillary to the use of the premises that may give rise to concern in respect of children

Give information about anything intended to occur at the premises or ancillary to the use of the premises which may give rise to concern in respect of children, regardless of whether you intend children to have access to the premises, for example (but not exclusively) nudity or semi-nudity, films for restricted age groups etc gambling machines etc.

None

Section 17 of 21

HOURS PREMISES ARE OPEN TO THE PUBLIC

Standard Days And Timings

MONDAY

Start 08:00

End 24:00

Start

End

Give timings in 24 hour clock. (e.g., 16:00) and only give details for the days of the week when you intend the premises to be used for the activity.

Continued from previous page...

TUESDAY

Start

End

Start

End

WEDNESDAY

Start

End

Start

End

THURSDAY

Start

End

Start

End

FRIDAY

Start

End

Start

End

SATURDAY

Start

End

Start

End

SUNDAY

Start

End

Start

End

State any seasonal variations

For example (but not exclusively) where the activity will occur on additional days during the summer months.

None

Non standard timings. Where you intend to use the premises to be open to the members and guests at different times from those listed in the column on the left, list below

For example (but not exclusively), where you wish the activity to go on longer on a particular day e.g. Christmas Eve.

Section 18 of 21

LICENSING OBJECTIVES

Describe the steps you intend to take to promote the four licensing objectives:

a) General – all four licensing objectives (b,c,d,e)

Continued from previous page...

List here steps you will take to promote all four licensing objectives together.

The Red Barn is an established business based within its own grounds at the Whitehall Farm - itself a small village in Herefordshire at the side of the River Wye. It is going from strength to strength and as such, this application for a premises licence is to allow the both on sale and off-sales to persons using the facility for recreation and leisure - primarily weddings. These activities will take place within the existing footprint of its grounds. We believe this will allow the business to grow and will provide a service to the wider customer base which they are attracting.

As part of this application process, we recognise that the premises is within a comparatively isolated, rural and stand alone location - and is unlikely to have any large and/or adverse effect on neighbouring properties. We have liaised with West Mercia Police and have explained to them what our intentions are, and when making this application have taken into account their suggestions i.e. both the requirements of the Licensing Act 2003 and the Herefordshire Council's licensing policy.

b) The prevention of crime and disorder

An incident log must be kept at the premises. Incident log records will be retained for a period of 12 months from the date it occurred. It will be made immediately available on request to an 'authorised person' (as defined by Section 13 of the Licensing Act 2003), an authorised Trading Standards Officer or the Police, and must record the following:

- (a) all crimes reported to the premises (where relevant to the licensing objectives)
- (b) all ejections of patrons
- (c) any complaints received (where relevant to the licensing objectives)
- (d) any incidents of disorder
- (e) any refusal of the sale of alcohol
- (f) any visit by a relevant authority or emergency services, noting time, date & purpose and those officials by name.

All staff engaged in the sale of alcohol to be trained in Responsible Alcohol Retailing to the minimum standard of BIIAB1 or any other training package equivalent to BIIAB level within one month of the date that this condition appears on this licence. (Where there are existing staff this training shall be completed within 3 months of the date that this condition first appears on the licence). Training records shall be kept on the premises, and shall be produced to the Police or an Authorised Person' (as defined by s13 of the Licensing Act 2003) or an authorised Trading Standards Officer of Herefordshire Council on demand.

c) Public safety

First Aid: A First Aid Kit for 21-50 people shall be kept fully stocked at the premises and kept behind the bar. Such kit shall contain:

- 1 x Guidance Leaflet,
- 60 x Washproof Plasters,
- 6 x Eye Pads with Bandage,
- 8 x Triangular Bandages,
- 12 x Safety Pins,
- 16 x Assorted Sterile Dressings,
- 20 Moist Wipes,
- 3 Pairs Disposable Gloves.

Electrical & Gas Installations: All electrical wiring and distribution systems shall be tested at least once a year and signed off by a competent person whose name is shown within the Local Authority Building Control Part P Competent Persons Register (<http://www.competentperson.co.uk/search.asp>). The sign off certificate shall be produced to an 'Authorised Person' (as defined by Section 13 of the Licensing Act 2003) or Police on demand.

Any and all gas appliances (except cellar gas) used in the premises must be tested at least once a year and signed off by a competent person whose name appears within the current Gas Safety register (GSR). The sign off certificate shall be produced to an 'Authorised Person' (as defined by Section 13 of the Licensing Act 2003) or Police on demand.

Continued from previous page...

d) The prevention of public nuisance

Prominent, clear and legible signage (in not less than 32 font bold) shall be displayed at all exits to the premises requesting the public to respect the needs of local residents and/or to leave the premises and the area quickly and quietly, as appropriate.

e) The protection of children from harm

The premises shall operate a Challenge 25 Policy. Such policy shall be written down and kept at the premises. The policy shall be produced on demand of the Police or an 'authorised person' (as defined by Section 13 of the Licensing Act 2003) or an authorised Trading Standards Officer the Local Authority/Council. Prominent, clear and legible signage (in not less than 32 font bold) shall also be displayed at all entrances to the premises as well as at, at least one location behind any counter advertising the scheme operated.

A written or electronic register of refusals will be kept including a description of the people who have been unable to provide required identification to prove their age. Such records shall be kept for a period of 12 months. It will be collected and reviewed on a weekly basis by the Designated Premises Supervisor and produced to the police or an 'authorised person' (as defined by Section 13 of the Licensing Act 2003) or an authorised Trading Standards Officer of Herefordshire Council on demand.

Section 19 of 21

NOTES ON DEMONSTRATING ENTITLEMENT TO WORK IN THE UK

Continued from previous page...

Entitlement to work/immigration status for individual applicants and applications from partnerships which are not limited liability partnerships:

A licence may not be held by an individual or an individual in a partnership who is resident in the UK who:

- does not have the right to live and work in the UK; or
- is subject to a condition preventing him or her from doing work relating to the carrying on of a licensable activity.

Any premises licence issued in respect of an application made on or after 6 April 2017 will become invalid if the holder ceases to be entitled to work in the UK.

Applicants must demonstrate that they have an entitlement to work in the UK and are not subject to a condition preventing them from doing work relating to the carrying on of a licensable activity. They do this by providing with this application copies or scanned copies of the following documents (which do not need to be certified).

Documents which demonstrate entitlement to work in the UK

- An expired or current passport showing the holder, or a person named in the passport as the child of the holder, is a British citizen or a citizen of the UK and Colonies having the right of abode in the UK [please see note below about which sections of the passport to copy].
- An expired or current passport or national identity card showing the holder, or a person named in the passport as the child of the holder, is a national of a European Economic Area country or Switzerland.
- A Registration Certificate or document certifying permanent residence issued by the Home Office to a national of a European Economic Area country or Switzerland.
- A Permanent Residence Card issued by the Home Office to the family member of a national of a European Economic Area country or Switzerland.
- A **current** Biometric Immigration Document (Biometric Residence Permit) issued by the Home Office to the holder indicating that the person named is allowed to stay indefinitely in the UK, or has no time limit on their stay in the UK.
- A **current** passport endorsed to show that the holder is exempt from immigration control, is allowed to stay indefinitely in the UK, has the right of abode in the UK, or has no time limit on their stay in the UK.
- A **current** Immigration Status Document issued by the Home Office to the holder with an endorsement indicating that the named person is allowed to stay indefinitely in the UK or has no time limit on their stay in the UK, **when produced in combination with** an official document giving the person's permanent National Insurance number and their name issued by a Government agency or a previous employer.
- A **full** birth or adoption certificate issued in the UK which includes the name(s) of at least one of the holder's parents or adoptive parents, **when produced in combination with** an official document giving the person's permanent National Insurance number and their name issued by a Government agency or a previous employer.
- A birth or adoption certificate issued in the Channel Islands, the Isle of Man or Ireland **when produced in combination with** an official document giving the person's permanent National Insurance number and their name issued by a Government agency or a previous employer.
- A certificate of registration or naturalisation as a British citizen, **when produced in combination with** an official document giving the person's permanent National Insurance number and their name issued by a Government agency or a previous employer.
- A **current** passport endorsed to show that the holder is allowed to stay in the UK and is currently allowed to work and is not subject to a condition preventing the holder from doing work relating to the carrying on of a licensable activity.

Continued from previous page...

- A **current** Biometric Immigration Document (Biometric Residence Permit) issued by the Home Office to the holder which indicates that the named person can currently stay in the UK and is allowed to work relation to the carrying on of a licensable activity.
- A **current** Residence Card issued by the Home Office to a person who is not a national of a European Economic Area state or Switzerland but who is a family member of such a national or who has derivative rights or residence.
- A **current** Immigration Status Document containing a photograph issued by the Home Office to the holder with an endorsement indicating that the named person may stay in the UK, and is allowed to work and is not subject to a condition preventing the holder from doing work relating to the carrying on of a licensable activity **when produced in combination with** an official document giving the person's permanent National Insurance number and their name issued by a Government agency or a previous employer.
- A Certificate of Application, **less than 6 months old**, issued by the Home Office under regulation 17(3) or 18A (2) of the Immigration (European Economic Area) Regulations 2006, to a person who is not a national of a European Economic Area state or Switzerland but who is a family member of such a national or who has derivative rights of residence.
- Reasonable evidence that the person has an outstanding application to vary their permission to be in the UK with the Home Office such as the Home Office acknowledgement letter or proof of postage evidence, or reasonable evidence that the person has an appeal or administrative review pending on an immigration decision, such as an appeal or administrative review reference number.
- Reasonable evidence that a person who is not a national of a European Economic Area state or Switzerland but who is a family member of such a national or who has derivative rights of residence in exercising treaty rights in the UK including:-
 - evidence of the applicant's own identity – such as a passport,
 - evidence of their relationship with the European Economic Area family member – e.g. a marriage certificate, civil partnership certificate or birth certificate, and
 - evidence that the European Economic Area national has a right of permanent residence in the UK or is one of the following if they have been in the UK for more than 3 months:
 - (i) working e.g. employment contract, wage slips, letter from the employer,
 - (ii) self-employed e.g. contracts, invoices, or audited accounts with a bank,
 - (iii) studying e.g. letter from the school, college or university and evidence of sufficient funds; or
 - (iv) self-sufficient e.g. bank statements.

Family members of European Economic Area nationals who are studying or financially independent must also provide evidence that the European Economic Area national and any family members hold comprehensive sickness insurance in the UK. This can include a private medical insurance policy, an EHIC card or an S1, S2 or S3 form.

Original documents must not be sent to licensing authorities. If the document copied is a passport, a copy of the following pages should be provided:-

- (i) any page containing the holder's personal details including nationality;
- (ii) any page containing the holder's photograph;
- (iii) any page containing the holder's signature;
- (iv) any page containing the date of expiry; and
- (v) any page containing information indicating the holder has permission to enter or remain in the UK and is permitted to work.

If the document is not a passport, a copy of the whole document should be provided.

Your right to work will be checked as part of your licensing application and this could involve us checking your immigration status with the Home Office. We may otherwise share information with the Home Office. Your licence application will not be determined until you have complied with this guidance.

Section 20 of 21

NOTES ON REGULATED ENTERTAINMENT

Continued from previous page...

In terms of specific **regulated entertainments** please note that:

- Plays: no licence is required for performances between 08:00 and 23.00 on any day, provided that the audience does not exceed 500.
- Films: no licence is required for 'not-for-profit' film exhibition held in community premises between 08.00 and 23.00 on any day provided that the audience does not exceed 500 and the organiser (a) gets consent to the screening from a person who is responsible for the premises; and (b) ensures that each such screening abides by age classification ratings.
- Indoor sporting events: no licence is required for performances between 08.00 and 23.00 on any day, provided that the audience does not exceed 1000.
- Boxing or Wrestling Entertainment: no licence is required for a contest, exhibition or display of Greco-Roman wrestling, or freestyle wrestling between 08.00 and 23.00 on any day, provided that the audience does not exceed 1000. Combined fighting sports – defined as a contest, exhibition or display which combines boxing or wrestling with one or more martial arts – are licensable as a boxing or wrestling entertainment rather than an indoor sporting event.
- Live music: no licence permission is required for:
 - o a performance of unamplified live music between 08.00 and 23.00 on any day, on any premises.
 - o a performance of amplified live music between 08.00 and 23.00 on any day on premises authorised to sell alcohol for consumption on those premises, provided that the audience does not exceed 500.
 - o a performance of amplified live music between 08.00 and 23.00 on any day, in a workplace that is not licensed to sell alcohol on those premises, provided that the audience does not exceed 500.
 - o a performance of amplified live music between 08.00 and 23.00 on any day, in a church hall, village hall, community hall, or other similar community premises, that is not licensed by a premises licence to sell alcohol, provided that (a) the audience does not exceed 500, and (b) the organiser gets consent for the performance from a person who is responsible for the premises.
 - o a performance of amplified live music between 08.00 and 23.00 on any day, at the non-residential premises of (i) a local authority, or (ii) a school, or (iii) a hospital, provided that (a) the audience does not exceed 500, and (b) the organiser gets consent for the performance on the relevant premises from: (i) the local authority concerned, or (ii) the school or (iii) the health care provider for the hospital.
- Recorded Music: no licence permission is required for:
 - o any playing of recorded music between 08.00 and 23.00 on any day on premises authorised to sell alcohol for consumption on those premises, provided that the audience does not exceed 500.
 - o any playing of recorded music between 08.00 and 23.00 on any day, in a church hall, village hall, community hall, or other similar community premises, that is not licensed by a premises licence to sell alcohol, provided that (a) the audience does not exceed 500, and (b) the organiser gets consent for the performance from a person who is responsible for the premises.
 - o any playing of recorded music between 08.00 and 23.00 on any day, at the non-residential premises of (i) a local authority, or (ii) a school, or (iii) a hospital, provided that (a) the audience does not exceed 500, and (b) the organiser gets consent for the performance on the relevant premises from: (i) the local authority concerned, or (ii) the school proprietor or (iii) the health care provider for the hospital.

Continued from previous page...

- Dance: no licence is required for performances between 08.00 and 23.00 on any day, provided that the audience does not exceed 500. However, a performance which amounts to adult entertainment remains licensable.
- Cross activity exemptions: no licence is required between 08.00 and 23.00 on any day, with no limit on audience size for:
 - o any entertainment taking place on the premises of the local authority where the entertainment is provided by or on behalf of the local authority;
 - o any entertainment taking place on the hospital premises of the health care provider where the entertainment is provided by or on behalf of the health care provider;
 - o any entertainment taking place on the premises of the school where the entertainment is provided by or on behalf of the school proprietor; and
 - o any entertainment (excluding films and a boxing or wrestling entertainment) taking place at a travelling circus, provided that (a) it takes place within a moveable structure that accommodates the audience, and (b) that the travelling circus has not been located on the same site for more than 28 consecutive days.

Section 21 of 21

PAYMENT DETAILS

This fee must be paid to the authority. If you complete the application online, you must pay it by debit or credit card.

Premises Licence Fees are determined by the non-domestic rateable value of the premises.

To find out a premises non domestic rateable value go to the Valuation Office Agency site at http://www.voa.gov.uk/business_rates/index.htm

Band A - No RV to £4300 £100.00

Band B - £4301 to £33000 £190.00

Band C - £33001 to £87000 £315.00

Band D - £87001 to £125000 £450.00*

Band E - £125001 and over £635.00*

*If the premises rateable value is in Bands D or E and the premises is primarily used for the consumption of alcohol on the premises then you are required to pay a higher fee.

Band D - £87001 to £125000 £900.00

Band E - £125001 and over £1,905.00

There is an exemption from the payment of fees in relation to the provision of regulated entertainment at church halls, chapel halls or premises of a similar nature, village halls, parish or community halls, or other premises of a similar nature. The costs associated with these licences will be met by central Government. If, however, the licence also authorises the use of the premises for the supply of alcohol or the provision of late night refreshment, a fee will be required.

Schools and sixth form colleges are exempt from the fees associated with the authorisation of regulated entertainment where the entertainment is provided by and at the school or college and for the purposes of the school or college.

If you operate a large event you are subject to ADDITIONAL fees based upon the number in attendance at any one time.

Capacity 5000-9999 £1,000.00

Capacity 10000 -14999 £2,000.00

Capacity 15000-19999 £4,000.00

Capacity 20000-29999 £8,000.00

Capacity 30000-39999 £16,000.00

Capacity 40000-49999 £24,000.00

Capacity 50000-59999 £32,000.00

Capacity 60000-69999 £40,000.00

Capacity 70000-79999 £48,000.00

Capacity 80000-89999 £56,000.00

Capacity 90000 and over £64,000.00

* Fee amount (£)

190.00

DECLARATION

1

Continued from previous page...

* I/we understand it is an offence, liable on conviction to a fine up to level 5 on the standard scale, under section 158 of the licensing act 2003, to make a false statement in or in connection with this application.

[Applicable to individual applicants only, including those in a partnership which is not a limited liability partnership] I understand I am not entitled to be issued with a licence if I do not have the entitlement to live and work in the UK (or if I am subject to a condition preventing me from doing work relating to the carrying on of a licensable activity) and that my licence will become invalid if I cease to be entitled to live and work in the UK (please read guidance note 15).

The DPS named in this application form is entitled to work in the UK (and is not subject to conditions preventing him or her from doing work relating to a licensable activity) and I have seen a copy of his or her proof of entitlement to work, if appropriate (please see note 15)

Ticking this box indicates you have read and understood the above declaration

This section should be completed by the applicant, unless you answered "Yes" to the question "Are you an agent acting on behalf of the applicant?"

* Full name

* Capacity

* Date / /
dd mm yyyy

Once you're finished you need to do the following:

1. Save this form to your computer by clicking file/save as...
2. Go back to <https://www.gov.uk/apply-for-a-licence/premises-licence/herefordshire/apply-1> to upload this file and continue with your application.

Don't forget to make sure you have all your supporting documentation to hand.

IT IS AN OFFENCE LIABLE TO SUMMARY CONVICTION TO A FINE OF ANY AMOUNT UNDER SECTION 158 OF THE LICENSING ACT 2003, TO MAKE A FALSE STATEMENT IN OR IN CONNECTION WITH THIS APPLICATION

IT IS AN OFFENCE UNDER SECTION 24B OF THE IMMIGRATION ACT 1971 FOR A PERSON TO WORK WHEN THEY KNOW, OR HAVE REASONABLE CAUSE TO BELIEVE, THAT THEY ARE DISQUALIFIED FROM DOING SO BY REASON OF THEIR IMMIGRATION STATUS. THOSE WHO EMPLOY AN ADULT WITHOUT LEAVE OR WHO IS SUBJECT TO CONDITIONS AS TO EMPLOYMENT WILL BE LIABLE TO A CIVIL PENALTY UNDER SECTION 15 OF THE IMMIGRATION, ASYLUM AND NATIONALITY ACT 2006 AND PURSUANT TO SECTION 21 OF THE SAME ACT, WILL BE COMMITTING AN OFFENCE WHERE THEY DO SO IN THE KNOWLEDGE, OR WITH REASONABLE CAUSE TO BELIEVE, THAT THE EMPLOYEE IS DISQUALIFIED

OFFICE USE ONLY

Applicant reference number	<input type="text" value="50-20"/>
Fee paid	<input type="text"/>
Payment provider reference	<input type="text"/>
ELMS Payment Reference	<input type="text"/>
Payment status	<input type="text"/>
Payment authorisation code	<input type="text"/>
Payment authorisation date	<input type="text"/>
Date and time submitted	<input type="text"/>
Approval deadline	<input type="text"/>
Error message	<input type="text"/>
Is Digitally signed	<input type="checkbox"/>

[1](#) [2](#) [3](#) [4](#) [5](#) [6](#) [7](#) [8](#) [9](#) [10](#) [11](#) [12](#) [13](#) [14](#) [15](#) [16](#) [17](#) [18](#) [19](#) [20](#) [21](#) [Next >](#)

Consent of individual to being specified as premises supervisor

James Andrew Jonathon ROGERS

I

[full name of prospective premises supervisor]

of



[home address of prospective premises supervisor]

hereby confirm that I give my consent to be specified as the designated premises supervisor in relation to the application for

Grant of a Premises Licence

[type of application]

by

Claypitt Ltd

[name of applicant]

relating to a premises licence

tba

[number of existing licence, if any]

for

Redbank Barn
New Groves Lane
Hampton Bishop
HEREFORD
HR1 9LD

[name and address of premises to which the application relates]

and any premises licence to be granted or varied in respect of this application made by

Claypitt Ltd

[name of applicant]

concerning the supply of alcohol at

Redbank Barn
New Groves Lane
Hampton Bishop
HEREFORD
HR1 9LD

[name and address of premises to which application relates]

I also confirm that I am applying for, intend to apply for or currently hold a personal licence, details of which I set out below.

Personal licence number



[insert personal licence number, if any]

Personal licence issuing authority

Herefordshire Council

[insert name and address and telephone number of personal licence issuing authority, if any]

Signed

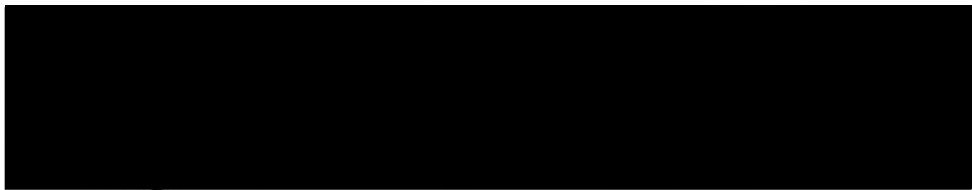

Name (please print)

James Andrew Jonathon ROGERS

Date

9th June 2020

Redbank Barn, New Groves Lane, Hampton Bishop, Herefordshire. HR19LD

Extinguisher Point Water



Licensable Activity



Consumption Area

Scale 1:1000

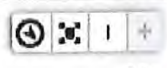





Leaflet | Open copyright and database rights (2020) Ordnance Survey (100024168)

Redbank Barn, New Groves Lane,
Hampton Bishop, Herefordshire, HR19LD



KEY

- Emergency Lighting 
- Fire Call Point & Beacon 
- Fire Extinguisher Foam 
- Fire Extinguisher Powder 

Scale 1:100

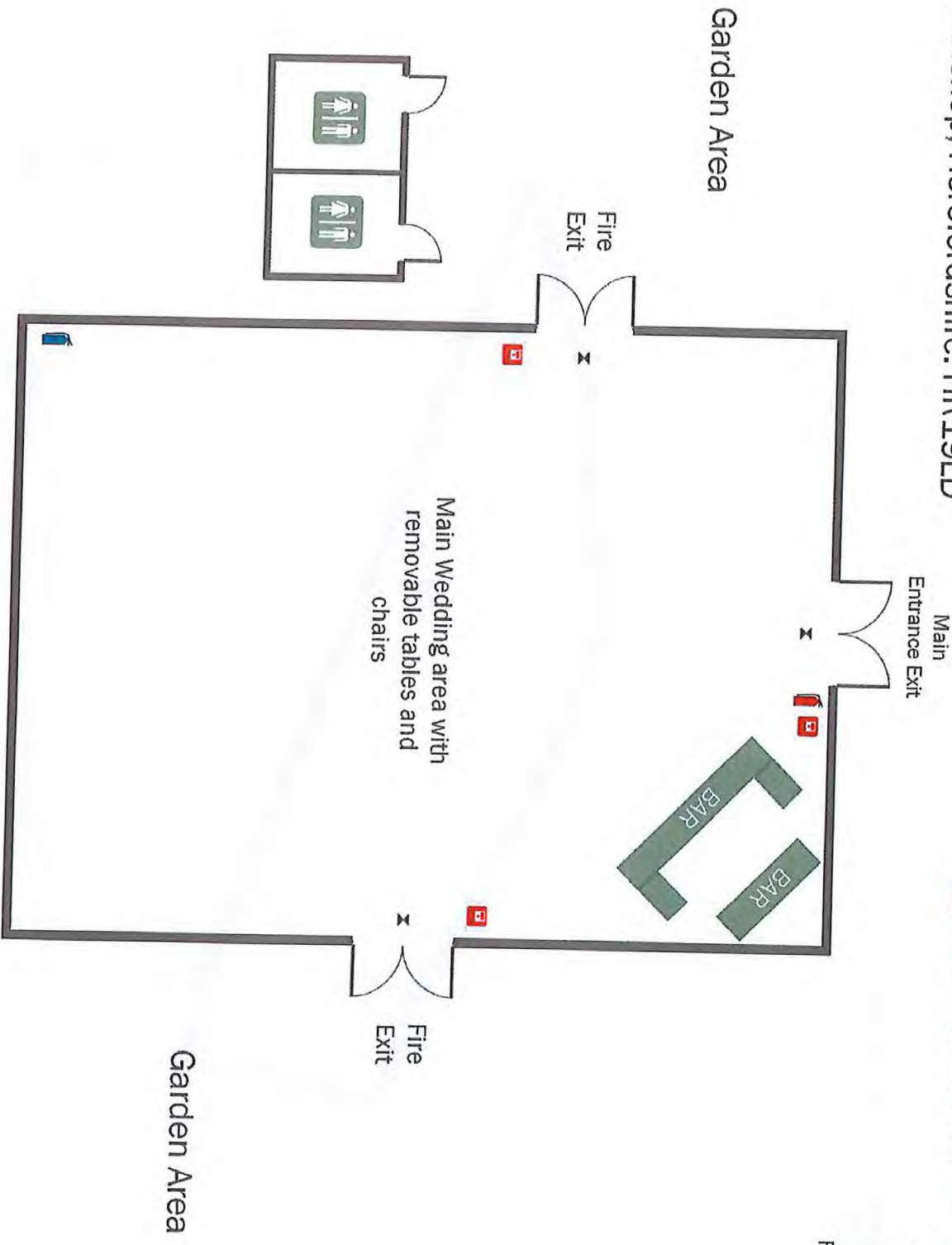

From: Trading Standards
Sent: 11 June 2020 11:53
To: Applicant's Agent
Subject: Redbank Events licence application

As discussed, we would wish to see the following condition on the above licence. I have highlighted in red the differences from the condition included in your app.

- **All staff engaged in the sale of alcohol to be trained in responsible alcohol retailing to the minimum standard of BIIAB Level 1 or any equivalent training course within 1 month of commencing employment at the premises. Where there are existing staff this training shall be completed within 3 months of the date that this condition first appears on the licence. No person shall be authorised to sell or supply alcohol until this training is completed. Refresher training will be conducted at no more than 12 monthly intervals.** Training records shall be kept on the premises and produced to the police of an 'authorised person' (as defined by Section 13 of the Licensing Act 2003) or an authorised Trading Standards Officer of Herefordshire Council on demand.

Principal Trading Standards Officer

MEMORANDUM

To : LICENSING OFFICER

From : Environmental Protection

Tel : 01432 260664

My Ref : CHT/308116/

Date : 06/07/2020

Your Ref :

LICENSING ACT 2003

APPLICATION FOR NEW OR VARIATION OF PREMISES LICENCE

Redbank Barn Events Redbank Barn, New Groves Lane, Hampton Bishop, Hereford, HR1 4LD

Having assessed the above application, I would like to make the following representation:

Representation	Industry Guidance
PREVENTION OF CRIME & DISORDER	
PUBLIC SAFETY	
PREVENTION OF PUBLIC NUISANCE	<ul style="list-style-type: none">• Environmental Protection Act 1990, Part III, Section 79 Statutory Nuisance• Insufficient noise nuisance mitigation control in place, lack noise management plan and poor sound insulation.• Extensive operating hours, 7 days a week and beyond 11pm, with live entertainment. Increased risk of noise nuisance complaint• Previous noise complaint
PROTECTION OF CHILDREN FROM HARM	

GRADUATE ENVIRONMENTAL HEALTH OFFICER
HEREFORDSHIRE COUNCIL

Redbank Site Meeting – Notes

Date - 3rd July 2020

Attendees -

Ms LAUGHLAND and Mr CHEUNG for Environmental Health Office

Mr NEADES for The Licensing Guys

Mrs ROGERS for Redbank Events

EHO Objection –

EHO states putting in objection against application as they don't have enough time to deal with it.

LG why taken three weeks to arrange a site visit when they knew the statutory time limit for representations were 28 days.

EHO responded that they didn't have time to deal with it due to annual leave, they were entitled to put in an objection and were going to. They would write to request more information before submitting their response and any conditions, if not acceptable, would have to go to hearing.

Hours of Music –

EHO criticised the application stating the hours for live music requested as unreasonable. Stated had looked at Redbank website, flagged it was a wedding venue and they caused lots of noise. Needed to bring hours in line as a wedding venue. Hours should be 11/11.30pm

LG said it was a valid application but open to discuss hours.

RB agreed hours open for discussion but stated carried out other events not just weddings, limiting hours would lose business. Questioned why there a need to when there had been no objections from any other parties or noise complaints.

Noise Complaint –

EHO stated there had been a noise complaint.

RB asked for more information as had never received or been made aware of any noise complaints at Redbank from EHO office or any residents.

LG asked had it been followed up or substantiated.

RB Asked whether it had been checked or proven that it was Redbank.

EHO unable to give any information as said it hadn't been investigated or followed up.

Redbank Barn –

RB explained general layout of where live music was usually positioned in barn at back. EHO stated RB to install own music sound system, insulate large front double doors and keep closed, keep music at back of barn. Asked if a Noise Management Plan was in place. RB stated very expensive to install own sound system, confirmed Noise Management was already in place and doors were having internal boards being made and insulated was already in place to be fitted when refitted.

Conclusion –

EHO will issue objection to give them more time to deal with the application. Matter will automatically go to a hearing unless RB accept EHO's conditions. EHO to write to LG requesting information. LG/RB to respond and provide info. EHO will provide their response and conditions and if not acceptable RB will go to hearing.

From: Environmental Protection
Sent: 16 July 2020 11:07
To: Agent
Cc:
Subject: RE: Redbarn Application, Hampton Bishop Hereford

Thank you for your time in arranging the on-site meeting. We appreciate your proposed conditions as well as the Noise Management Plan. Please find below our proposed condition for your consideration. We have taken into account of the nature of the event, locality and any past history of complaints.

Conditions:

No live entertainment should be permitted after 23:00 Sun-Thurs and 23:30 Fri-Sat

Noise and vibration shall not emanate from the premises so as to cause a nuisance.

The Premises Licence Holder or DPS must immediately comply with any request to adjust noise levels / frequency spectra made by an 'authorised person' (as defined by Section 13 of the Licensing Act 2003) or the Police.

There shall be a written agreed Noise Management Plan with Environmental Protection team no later than 60 days after the granting of licence. The premises licence holder must comply with the written agreed Noise Management Plan.

All doors and windows at the premises shall be kept closed after 23:00 except during immediate access and egress.

Large double front door shall remain closed during the main event except for emergency access and egress.

Loudspeakers shall not be located in the entrance lobby or external to any part of the premises.

Prominent, clear and legible signage (in not less than 32 font bold) shall be displayed at all exits to the premises requesting the public to respect the needs of local residents and to leave the premises and the area quietly.

Please let us know if the above proposed condition could be agreed by your client.

Yours faithfully

**Graduate Environmental Health Officer
Economy and Place Directorate**

MEMORANDUM

To : **LICENSING OFFICER**

From : **Environmental Health**

Tel : **01432 261761** My Ref : **CHT/308116/**

Date : **04/08/2020** Your Ref :

LICENSING ACT 2003

APPLICATION FOR NEW OR VARIATION OF PREMISES LICENCE

Redbank Barn Events Redbank Barn, New Groves Lane, Hampton Bishop, Hereford, HR1 4LD

Having assessed the above application, I would like to make the following representation:

Environmental Health – Environmental Protection Service was consulted on the application in June 2020 through the licensing process for a premise licence in pursuant of the licensing objectives Prevention of Public Nuisance as laid out in the Licensing Act 2003.

The Redbank Barn Event application details it is ‘A business that provides barn wedding and event facilities on a working farm overlooking the River Wye’. The application outline the operating hours for Sun-Thurs 10:00 till 00:00 and Fri-Sat 10:00 till 01:00, including live entertaining such as live bands and DJ.

Following a site visit and discussions with the applicant, concerns were raised over the premises structure, activities, and potential frequency of events and proposed hours of entertainment with regards to public noise nuisance considering the rural location and history of noise complaints regarding past events from this location. During these discussions some additional conditions were agreed, however the proposed entertainment hours and door control measures have not hence our objection to this application as it currently stands.

Further details and supporting evidence detailed below.

Supporting Evidence

Location: The premises is situated in the South of Hampton Bishop, North of Holme Lacy with the River Wye in between. Residential properties at River View Close, Holme Lacy are situated on a raised cliff, roughly 450m away from the premises, Figure 1, Figure 2 and Figure 3.



Figure 1 Large double door to the front of the building is directly facing the residential properties at Holme Lacy. Two smaller doors to the rear sides of the premises



Figure 2 Redbank Barn is situated at the South side of Hampton Bishop, North of Holme Lacy with the River Wye in between.

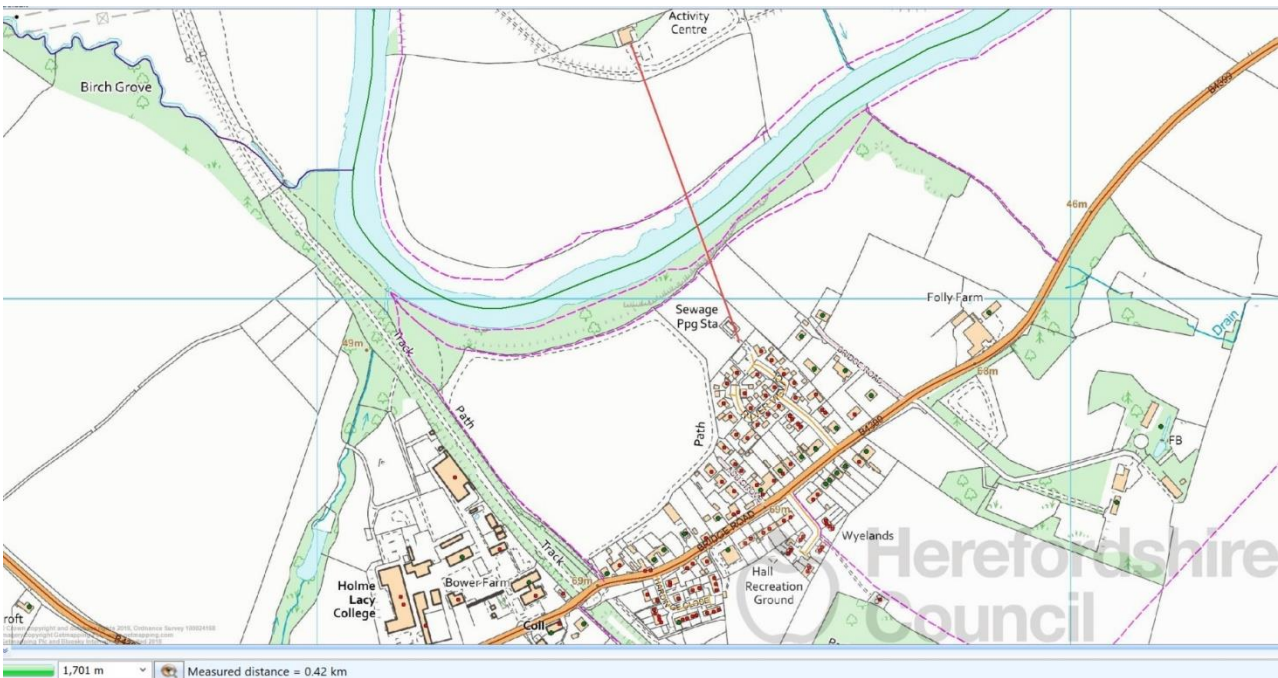

Figure 3 Redbank Barn is roughly 420m away from the residents in Holme Lacy the closest noise sensitive premises

Structure of Building: The premises is a metal sheet and steel frame agricultural style building with additional wood cladding on the front and rear gable ends Figure 4 . There are three door entrances, a large double door to the front Figure 5, and two side doors located to the rear Figure 6. The entertainments are proposed to be held inside the premises, with the entertainment area, live band, DJ and loud speaker to be located at the far end of the building. A bar near the entrance Figure 8, with dining table across the middle and rear section of the building Figure 9.

The main entrance to the premises was detailed as the large double doors to the south side, which face in the direction of the properties at Holme Lacy. There are also two smaller side doors to the west and east side of the building allow access to the outside. There a gaps on the front door which would allow sound to leak from within the premises. The roof and walls of the premises are of a poor sound attenuation properties with the doors closed and further significant reduction with the doors open. Music events of this nature usually operate between 80 -95dB in the entertainment area and crown noise can further increase these noise levels (especially in wedding events). Due to the rural location of this venue the back-ground levels will be very low (below 30dB) and the noise will carry over large distances due to few structures in its pathway to absorb the sound.



Figure 4 Front of the barn view from the outside, with large double door in the middle and toilets to the right.



Figure 5 Large front wooden door with gaps that could lead to sound leakage



Figure 6 Left rear side door



Figure 7 Barn structure interior, metal sheet cladding material laying on top of a wooden frame. Sitting area at the front of the building, next to the dance floor.



Figure 8 Bar near the front entrance, next to the dance floor area

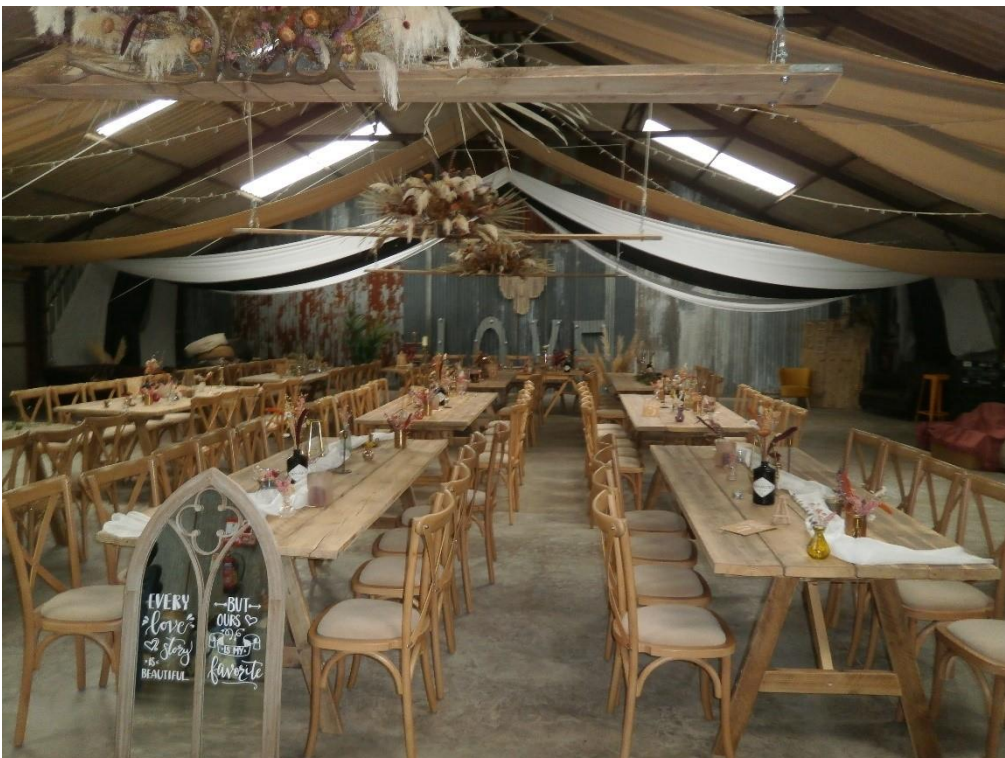

Figure 9 Dining table across the middle and rear of the building- entertainments to be set up at the rear of the premises facing on to the tables and double door.

Sequence of events

date	notes
June 2020	Application received, 28 days consultation period begin. Reviewed application, previous noise complaint from the area, and thus concerned with potential noise creating public nuisance.
3 rd July	<p>Site visit with Paul Neades (Licensing Guys) and Alison Roger (Business Owner). Discussed the noise issues, structure of the building and operating hours. Advised the applicant to review the proposed conditions in addition to the single condition laid out before, including reduced operating hours and other noise nuisance mitigation measures.</p> <p>Enquired with the Planning Department with regard to the structure of the building and the need for a planning permission for such venue.</p>
10 th July	Email from Paul Neades with revised proposed conditions, including a Noise Management Plan and reduced live entertainment hours Fri/Sat till 12am, Sun/Thurs till 11pm as per previously discussed with Business Owner
16 th July	<p>Chaser email to Planning department with regard to the planning permission for the venue.</p> <p>Email to Paul Neades with revised proposed conditions, including a reduced live entertainment hours Fri/Sat till 11:30pm and Sun/Thurs till 11pm</p>
28 th July	<p>Email from Nick Semper (Licensing Guys), ask to reconsider the condition EP proposed previously, direct quote from email:</p> <p>All the provisions and proposals submitted by EHO in the latest email are acceptable with two exceptions and the following amendments are requested:</p> <p>(1) Ingress (as well as egress) be given through the double doors as this is the main disabled access for the Premises and is needed for access to the toilet. The side door leading to the toilets have steps.</p> <p>(2) the original application times for the playing of live music be allowed to continue to 1pm, save for wedding events where it will be restricted to midnight</p> <p>Additional Request for Information: Please may we have copies of all noise complaints held by the Council regarding our premises specifically? I'm sure you will have no problems providing this information as it forms the basis of your objection. In any event, we require that you treat this as a Freedom of Information request in the event that you cannot comply with disclosure in good time before the Hearing</p>

Previous Complaints	
SRU 235435	July 2017, Tipi Adventures Ltd (Previous complaint for that location) Complaint date: 10/07/2017 Noise complaint from residents at Holme Lacy reporting loud music from Pond Barn area, from 9pm till 4:30am over the weekend. Called police but they didn't attend the site.
SRU 235551	July 2017, Tipi Adventures Ltd (Previous complaint for that location) Complaint date: 10/07//2017 Noise complaint from residents at Holme Lacy reporting loud music going on till 03:30am. Noise came from a barn at the Tipi Adventure site.
SRU 287334	July 2019, Redbank Barn Event Complaint date: 27/07/2019 Noise complaint from residents at Holme Lacy for loud music and party noise from Redbank Barn. Noise had continued past 11pm. Out of hours noise team on 29/07/2019, 1am no noise Out of hours noise team on 30/07/2019, 1am no noise TENS SRU 286440, linked to TEN27072019, 17 th July 2019 application date, for event on 27 th July 2019, barn wedding. Wedding hours 14:00 – 00:00 with Live Band Music between 20:00 to 23:00.

7 TENS application in 2019, 1 complaint, with Live Band Music past 23:00.

TENS	Hours of operation
TEN07092019	Band from 19:00 – 00:00
TEN17082019	Band from 19:00 – 00:00
TEN03082019	Band from 20:00 – 23:00
TEN27072019	Band from 20:00 – 23:00
TEN13072019	Band from 20:00 – 23:00
TEN20072019	Band from 20:00 – 23:00
TEN01062019	Band from 20:00 – 23:00

Conclusion

The current proposed licensing conditions do not in our opinion ensure the premises meets the licensing objectives to prevent public nuisance. Our main concerns are being the poor structure of the building that provide poor sound attenuation quality, with extensive operating hours beyond sensitive hours (11pm – 7am) and frequent events up to 7 days a week. As such we proposed the committee to consider the following options for the licence conditions:

Grant of the licence with the following conditions

- 1. Noise and vibration shall not emanate from the premises so as to cause a nuisance.*
- 2. The Premises Licence Holder or DPS must immediately comply with any request to adjust noise levels / frequency spectra made by an 'authorised person' (as defined by Section 13 of the Licensing Act 2003) or the Police.*
- 3. There shall be a written agreed Noise Management Plan with Environmental Protection team no later than 60 days after the granting of licence. The premises licence holder must comply with the written agreed Noise Management Plan.*
- 4. All doors and windows at the premises shall be kept closed after 23:00 except during immediate access and egress.*
- 5. Loudspeakers shall not be located in the entrance lobby or external to any part of the premises.*
- 6. Prominent, clear and legible signage (in not less than 32 font bold) shall be displayed at all exits to the premises requesting the public to respect the needs of local residents and to leave the premises and the area quietly.*
- 7. Large double front door shall remain closed during the main event except for access and egress by disabled persons or in the event of an emergency*
- 8. No regulated entertainment should be permitted after 23:00 Sun-Thurs and 23:30 Fri-Sat with the current premises structure. We would accept a terminal hours of 12am, providing the applicant has carried out a noise impact assessment undertaken by a competent person, to the satisfaction of the Local Authority and any recommended works to a suitable sound attenuation standard.*

Environmental Health Officer

Date 03/08/2020



Meeting:	Licensing sub-committee
Meeting date:	19th August 2020
Title of report:	Application for a grant of a premises licence in respect of 'Gillow Cider, Gillow Manor, St Owens Cross, Hereford. HR2 8LE' – Licensing Act 2003
Report by:	Licensing Technical Officer

Classification

Open

Key Decision

This is not an executive decision.

Wards Affected

Dinedor Hill

Purpose

To consider an application for a grant of a premise licence in respect of Gillow Cider, Gillow Manor, St Owens Cross, Hereford. HR2 8LE

Recommendation

THAT:

The sub committee determine the application with a view to promoting the licensing objectives in the overall interests of the local community. They should give appropriate weight to:

- **The steps that are appropriate to promote the licensing objectives,**
- **The representations (including supporting information) presented by all parties,**
- **The guidance issued to local authorities under Section 182 of the Licensing Act 2003, and**
- **The Herefordshire Council Statement of Licensing Policy 2015 - 2020.**

Options

1. There are a number of options open to the sub-committee:

- a) Grant the licence subject to conditions that are consistent with the operating schedule accompanying the application and the mandatory conditions set out in the Licensing Act 2003,
- b) Grant the licence subject to modified conditions to that of the operating schedule where the sub-committee considers it appropriate for the promotion of the licensing objectives and add mandatory conditions set out in the Licensing Act 2003,
- c) To exclude from the scope of the licence any of the licensable activities to which the application relates
- d) To refuse to specify a person in the licence as the premise supervisor, or
- e) To reject the application.

Reasons for Recommendations

- 2. Ensures compliance with the Licensing Act 2003.

Key Considerations

Licence Application

- 3. The application for the grant of a premises licence has received relevant representations and is therefore brought before the sub-committee for determination.
- 4. The details of the application are:

Applicant	David Fletcher	
Agent	The Licensing Guys	
Type of application: Grant	Date received: 24 th June 2020	28 Days consultation ended 22 nd July 2020

Summary of Application

- 5. The application (appendix 1) requests the grant of a premises licence to allow the following licensable activities, during the hours shown, as follows:

Live Music (Indoors/Outdoors); Recorded Music (Indoors);
Friday – Saturday 09:00 – 01:00

Sale/Supply of alcohol (consumption on and off the premises)
Sunday – Thursday 09:00 – 23:00
Friday – Saturday 09:00 – 01:00

Late Night Refreshment (Indoors/Outdoors)

Friday – Saturday 23:00 – 01:00

For all licensable activities mentioned above

09:00 - 01:00 Valentine's Day, Christmas Eve, New Year's Eve, Bank Holidays and Sundays preceding Bank Holidays

(Although Live and Recorded Music has been applied for between the hours of 0900 to 2300 Sunday to Thursday it would only be licensable if there were more than 500 people)

Summary of Representations

6. One (1) representation has been received from the responsible authorities (Environmental Health). This was an objection to the application and can be found at Appendix 2.
7. Twenty seven (27) relevant representations have been received from members of the public that the licensing authority has accepted as being relevant and can be found at appendix 4.
8. Twelve (12) representations were received from members of the public opposing the application which have been rejected by the Licensing Authority as not being relevant.
9. Three (3) representations were received from members of the public but were rejected as they were received outside of the consultation dates.

Community Impact

11. Any decision may have an impact on the local community.

Equality duty

12. There are no equality issues in relation to the content of this report.
13. This report has human rights implications for both the premises licence holder and the residents from the local neighbourhood. Any of the steps outlined in section 1 of this report may have financial implications for a licensee's business and livelihood and/or may have impact upon the day to day lives of residents living in close proximity to the premises.
14. Article 8(i) of the European Convention of Human Rights provides that everyone has the right to respect for his/her private and family life and his/her home (which includes business premises). This right may be interfered with by the council on a number of grounds including the protection of rights and freedoms of others. The First Protocol – Article 1 – also provides that every person is entitled to the peaceful enjoyment of his possessions and shall not be deprived of his possessions except in the public interest and conditions provided for by law. Members must accordingly make a decision which is proportionate to the hearing and endeavour to find a balance between the rights of the applicant, residents and the community as a whole.

Financial implications

15. There are unlikely to be any financial implications for the authority at this time.

Legal Implications

16. As relevant representations have been received, the sub committee must determine the application under Section 3.5.7 (c) of the Herefordshire Council constitution. The representations must relate to the licensing objectives and the sub committee must determine the likely effect of the grant of the premises licences on the promotion of the licensing objectives.
17. The licensing authority must have regard to the promotion of the four licensing objectives namely; the prevention of crime and disorder; public safety; the prevention of public nuisance; and the protection of children from harm in exercising its functions under the Licensing Act 2003. Further regard should be had to the statutory guidance under Section 182 of the Act and the Council's own statement of licensing policy. The options available to the licensing authority are set out in section 1 of this report.
18. The sub committee should be aware of a number of stated cases which have appeared before the Administrative Court and are binding on the Licensing Authority.
19. The case of *Daniel Thwaites Plc v Wirral Borough Magistrates' Court* (Case No: CO/5533/2006) at the High Court of Justice Queen's Bench Division Administrative Court on 6 May 2008, [2008] EWHC 838 (Admin), 2008 WL 1968943, Before the Honourable Mrs Justice Black. In this case it was summed up that: -

A licensing authority must have regard to guidance issued by the Secretary of State under section 182. Licensing authorities may depart from it if they have reason to do so but will need to give full reasons for their actions.
20. Furthermore the Thwaites case established that only conditions should be attached to a licence with a view to promoting the Licensing objectives and that 'real evidence' must be presented to support the reason for imposing these conditions.
21. This judgement is further supported in the case of *The Queen on the Application of Bristol Council v Bristol Magistrates' Court*, CO/6920/2008 High Court of Justice Queen's Bench Division The Administrative Court, 24 February 2009, [2009] EWHC 625 (Admin) 2009 WL 648859 in which it was said:

'Licensing authorities should only impose conditions which are necessary and proportionate for the promotion for licensing objectives'.
22. In addition to this it was stated that any condition attached to the licence should be an enforceable condition.

Right of Appeal

23. Schedule 5 of the Licensing Act 2003 gives a right of appeal which states:

Decision to grant premises licence or impose conditions etc.

- (1) This paragraph applies where a licensing authority grants a premises licence under section 18.
 - (2) The holder of the licence may appeal against any decision—
 - (a) to impose conditions on the licence under subsection (2)(a) or (3)(b) of that section, or
 - (b) to take any step mentioned in subsection (4)(b) or (c) of that section (exclusion of licensable activity or refusal to specify person as premises supervisor).
 - (3) Where a person who made relevant representations in relation to the application desires to contend—
 - (a) that the licence ought not to have been granted, or
 - (b) that, on granting the licence, the licensing authority ought to have imposed different or additional conditions, or to have taken a step mentioned in subsection (4)(b) or (c) of that section,he may appeal against the decision.
 - (4) In sub-paragraph (3) “relevant representations” has the meaning given in section 18(6).
24. Appeals should be made to the Magistrates Court and must be made within 21 days beginning with the day on which the appellant was notified by the licensing authority of the decision appealed against

Risk Management

25. There is little risk associated with the decision at this time as the legislation allows a right of appeal to the Magistrates Court within a period of 21 days of being notified of the decision in writing.

Consultees

26. All responsible authorities and members of the public living within Herefordshire.

Appendices

Appendix 1 - Application Form
Appendix 2 – Environmental Health Objection
Appendix 3 – Public Representations

Background Papers

None.

* required information

Section 1 of 21

You can save the form at any time and resume it later. You do not need to be logged in when you resume.

System reference

Not Currently In Use

This is the unique reference for this application generated by the system.

Your reference

56-20

You can put what you want here to help you track applications if you make lots of them. It is passed to the authority.

Are you an agent acting on behalf of the applicant?

Yes No

Put "no" if you are applying on your own behalf or on behalf of a business you own or work for.

Applicant Details

* First name

David Stuart

* Family name

FLETCHER

* E-mail

[REDACTED]

Main telephone number

[REDACTED]

Include country code.

Other telephone number

[REDACTED]

Indicate here if the applicant would prefer not to be contacted by telephone

Is the applicant:

Applying as a business or organisation, including as a sole trader
 Applying as an individual

A sole trader is a business owned by one person without any special legal structure. Applying as an individual means the applicant is applying so the applicant can be employed, or for some other personal reason, such as following a hobby.

Applicant Business

Is the applicant's business registered in the UK with Companies House?

Yes No

Note: completing the Applicant Business section is optional in this form.

Is the applicant's business registered outside the UK?

Yes No

Business name

Gillow Cider

If the applicant's business is registered, use its registered name.

VAT number

-

None

Put "none" if the applicant is not registered for VAT.

Continued from previous page...

Legal status

Applicant's position in the business

Home country

The country where the applicant's headquarters are.

Applicant Business Address

Building number or name

Street

District

City or town

County or administrative area

Postcode

Country

If the applicant has one, this should be the applicant's official address - that is an address required of the applicant by law for receiving communications.

Agent Details

* First name

* Family name

* E-mail

Main telephone number

Include country code.

Other telephone number

Indicate here if you would prefer not to be contacted by telephone

Are you:

- An agent that is a business or organisation, including a sole trader
- A private individual acting as an agent

A sole trader is a business owned by one person without any special legal structure.

Agent Business

Is your business registered in the UK with Companies House? Yes No

Note: completing the Applicant Business section is optional in this form.

Is your business registered outside the UK? Yes No

Business name

If your business is registered, use its registered name.

VAT number

Put "none" if you are not registered for VAT.

Legal status

Continued from previous page...

Your position in the business

Home country

The country where the headquarters of your business is located.

Agent Business Address

If you have one, this should be your official address - that is an address required of you by law for receiving communications.

Building number or name

Street

District

City or town

County or administrative area

Postcode

Country

Section 2 of 21

PREMISES DETAILS

I/we, as named in section 1, apply for a premises licence under section 17 of the Licensing Act 2003 for the premises described in section 2 below (the premises) and I/we are making this application to you as the relevant licensing authority in accordance with section 12 of the Licensing Act 2003.

Premises Address

Are you able to provide a postal address, OS map reference or description of the premises?

- Address OS map reference Description

Postal Address Of Premises

Building number or name

Street

District

City or town

County or administrative area

Postcode

Country

Further Details

Telephone number

Non-domestic rateable value of premises (£)

Section 3 of 21

APPLICATION DETAILS

In what capacity are you applying for the premises licence?

- An individual or individuals
- A limited company / limited liability partnership
- A partnership (other than limited liability)
- An unincorporated association
- Other (for example a statutory corporation)
- A recognised club
- A charity
- The proprietor of an educational establishment
- A health service body
- A person who is registered under part 2 of the Care Standards Act 2000 (c14) in respect of an independent hospital in Wales
- A person who is registered under Chapter 2 of Part 1 of the Health and Social Care Act 2008 in respect of the carrying on of a regulated activity (within the meaning of that Part) in an independent hospital in England
- The chief officer of police of a police force in England and Wales

Confirm The Following

- I am carrying on or proposing to carry on a business which involves the use of the premises for licensable activities
- I am making the application pursuant to a statutory function
- I am making the application pursuant to a function discharged by virtue of Her Majesty's prerogative

Section 4 of 21

INDIVIDUAL APPLICANT DETAILS

Applicant Name

Is the name the same as (or similar to) the details given in section one?

- Yes No

If "Yes" is selected you can re-use the details from section one, or amend them as required. Select "No" to enter a completely new set of details.

First name

Family name

Is the applicant 18 years of age or older?

- Yes No

Continued from previous page...

Current Residential Address

Is the address the same as (or similar to) the address given in section one?

If "Yes" is selected you can re-use the details from section one, or amend them as required. Select "No" to enter a completely new set of details.

Yes No

Building number or name	<input type="text"/>
Street	<input type="text"/>
District	<input type="text"/>
City or town	<input type="text"/>
<input type="text"/> administrative area	<input type="text"/>
Postcode	<input type="text"/>
Country	<input type="text" value="United Kingdom"/>

Applicant Contact Details

Are the contact details the same as (or similar to) those given in section one?

If "Yes" is selected you can re-use the details from section one, or amend them as required. Select "No" to enter a completely new set of details.

Yes No

E-mail	<input type="text"/>
Telephone number	<input type="text"/>
Other telephone number	<input type="text"/>
* Date of birth	<input type="text" value="dd"/> / <input type="text" value="mm"/> / <input type="text" value="yyyy"/>
* Nationality	<input type="text"/>
Right to work share code	<input type="text"/>

[Documents that demonstrate entitlement to work in the UK](#)
[Right to work share code if not submitting scanned documents](#)

Section 5 of 21

OPERATING SCHEDULE

When do you want the premises licence to start? / /
dd mm yyyy

If you wish the licence to be valid only for a limited period, when do you want it to end / /
dd mm yyyy

Provide a general description of the premises

Continued from previous page...

For example the type of premises, its general situation and layout and any other information which could be relevant to the licensing objectives. Where your application includes off-supplies of alcohol and you intend to provide a place for consumption of these off- supplies you must include a description of where the place will be and its proximity to the premises.

Gillow Cider have been producing ciders for many years. In light of recent national developments they would now like to create a taproom on site for ON sales, regularise the facility for their annual Cider Festival involving no more than 500 attendees which has so far been hosted under TENs, and in the meantime develop an OFF sale offering through internet, mail order and telephone sales with home delivery.

If 5,000 or more people are expected to attend the premises at any one time, state the number expected to attend

Section 6 of 21

PROVISION OF PLAYS

[See guidance on regulated entertainment](#)

Will you be providing plays?

- Yes No

Section 7 of 21

PROVISION OF FILMS

[See guidance on regulated entertainment](#)

Will you be providing films?

- Yes No

Section 8 of 21

PROVISION OF INDOOR SPORTING EVENTS

[See guidance on regulated entertainment](#)

Will you be providing indoor sporting events?

- Yes No

Section 9 of 21

PROVISION OF BOXING OR WRESTLING ENTERTAINMENTS

[See guidance on regulated entertainment](#)

Will you be providing boxing or wrestling entertainments?

- Yes No

Section 10 of 21

PROVISION OF LIVE MUSIC

[See guidance on regulated entertainment](#)

Will you be providing live music?

- Yes No

Standard Days And Timings

Continued from previous page...

MONDAY

Start

End

Start

End

Give timings in 24 hour clock.
(e.g., 16:00) and only give details for the days
of the week when you intend the premises
to be used for the activity.

TUESDAY

Start

End

Start

End

WEDNESDAY

Start

End

Start

End

THURSDAY

Start

End

Start

End

FRIDAY

Start

End

Start

End

SATURDAY

Start

End

Start

End

SUNDAY

Start

End

Start

End

Will the performance of live music take place indoors or outdoors or both?

- Indoors Outdoors Both

Where taking place in a building or other
structure tick as appropriate. Indoors may
include a tent.

State type of activity to be authorised, if not already stated, and give relevant further details, for example (but not
exclusively) whether or not music will be amplified or unamplified.

State any seasonal variations for the performance of live music

For example (but not exclusively) where the activity will occur on additional days during the summer months.

Continued from previous page...

Non-standard timings. Where the premises will be used for the performance of live music at different times from those listed in the column on the left, list below

For example (but not exclusively), where you wish the activity to go on longer on a particular day e.g. Christmas Eve.

09:00hrs x 01:00hrs - Valentine's Day, Christmas Eve, New Year's Eve, Bank Holidays and Sundays preceding Bank Holidays.

Section 11 of 21

PROVISION OF RECORDED MUSIC

[See guidance on regulated entertainment](#)

Will you be providing recorded music?

- Yes No

Standard Days And Timings

MONDAY

Start

End

Start

End

Give timings in 24 hour clock.
(e.g., 16:00) and only give details for the days
of the week when you intend the premises
to be used for the activity.

TUESDAY

Start

End

Start

End

WEDNESDAY

Start

End

Start

End

THURSDAY

Start

End

Start

End

FRIDAY

Start

End

Start

End

SATURDAY

Start

End

Start

End

Continued from previous page...

SUNDAY

Start

End

Start

End

Will the playing of recorded music take place indoors or outdoors or both?

- Indoors Outdoors Both

Where taking place in a building or other structure tick as appropriate. Indoors may include a tent.

State type of activity to be authorised, if not already stated, and give relevant further details, for example (but not exclusively) whether or not music will be amplified or unamplified.

State any seasonal variations for playing recorded music

For example (but not exclusively) where the activity will occur on additional days during the summer months.

Non-standard timings. Where the premises will be used for the playing of recorded music at different times from those listed in the column on the left, list below

For example (but not exclusively), where you wish the activity to go on longer on a particular day e.g. Christmas Eve.

09:00hrs x 01:00hrs - Valentine's Day, Christmas Eve, New Year's Eve, Bank Holidays and Sundays preceding Bank Holidays.

Section 12 of 21

PROVISION OF PERFORMANCES OF DANCE

[See guidance on regulated entertainment](#)

Will you be providing performances of dance?

- Yes No

Section 13 of 21

PROVISION OF ANYTHING OF A SIMILAR DESCRIPTION TO LIVE MUSIC, RECORDED MUSIC OR PERFORMANCES OF DANCE

[See guidance on regulated entertainment](#)

Will you be providing anything similar to live music, recorded music or performances of dance?

- Yes No

Section 14 of 21

LATE NIGHT REFRESHMENT

Will you be providing late night refreshment?

Continued from previous page...

Standard Days And Timings

MONDAY

Start

End

Start

End

Give timings in 24 hour clock.
(e.g., 16:00) and only give details for the days
of the week when you intend the premises
to be used for the activity.

TUESDAY

Start

End

Start

End

WEDNESDAY

Start

End

Start

End

THURSDAY

Start

End

Start

End

FRIDAY

Start

End

Start

End

SATURDAY

Start

End

Start

End

SUNDAY

Start

End

Start

End

Will the provision of late night refreshment take place indoors or outdoors or both?

- Indoors Outdoors Both

Where taking place in a building or other structure tick as appropriate. Indoors may include a tent.

State type of activity to be authorised, if not already stated, and give relevant further details, for example (but not exclusively) whether or not music will be amplified or unamplified.

State any seasonal variations

Continued from previous page...

For example (but not exclusively) where the activity will occur on additional days during the summer months.

Non-standard timings. Where the premises will be used for the supply of late night refreshments at different times from those listed in the column on the left, list below

For example (but not exclusively), where you wish the activity to go on longer on a particular day e.g. Christmas Eve.

09:00hrs x 01:00hrs - Valentine's Day, Christmas Eve, New Year's Eve, Bank Holidays and Sundays preceding Bank Holidays.

Section 15 of 21

SUPPLY OF ALCOHOL

Will you be selling or supplying alcohol?

- Yes No

Standard Days And Timings

MONDAY

Start

End

Start

End

Give timings in 24 hour clock.
(e.g., 16:00) and only give details for the days
of the week when you intend the premises
to be used for the activity.

TUESDAY

Start

End

Start

End

WEDNESDAY

Start

End

Start

End

THURSDAY

Start

End

Start

End

FRIDAY

Start

End

Start

End

SATURDAY

Start

End

Start

End

Continued from previous page...

SUNDAY

Start

End

Start

End

Will the sale of alcohol be for consumption:

- On the premises Off the premises Both

If the sale of alcohol is for consumption on the premises select on, if the sale of alcohol is for consumption away from the premises select off. If the sale of alcohol is for consumption on the premises and away from the premises select both.

State any seasonal variations

For example (but not exclusively) where the activity will occur on additional days during the summer months.

Non-standard timings. Where the premises will be used for the supply of alcohol at different times from those listed in the column on the left, list below

For example (but not exclusively), where you wish the activity to go on longer on a particular day e.g. Christmas Eve.

09:00hrs x 01:00hrs - Valentine's Day, Christmas Eve, New Year's Eve, Bank Holidays and Sundays preceding Bank Holidays.

State the name and details of the individual whom you wish to specify on the licence as premises supervisor

Name

First name

Family name

Date of birth / /

Continued from previous page...

Enter the contact's address

Building number or name

Street

District

City or town

County or administrative area

Postcode

Country

Personal Licence number (if known)

Issuing licensing authority (if known)

PROPOSED DESIGNATED PREMISES SUPERVISOR CONSENT

How will the consent form of the proposed designated premises supervisor be supplied to the authority?

- Electronically, by the proposed designated premises supervisor
- As an attachment to this application

Reference number for consent form (if known)

If the consent form is already submitted, ask the proposed designated premises supervisor for its 'system reference' or 'your reference'.

Section 16 of 21

ADULT ENTERTAINMENT

Highlight any adult entertainment or services, activities, or other entertainment or matters ancillary to the use of the premises that may give rise to concern in respect of children

Give information about anything intended to occur at the premises or ancillary to the use of the premises which may give rise to concern in respect of children, regardless of whether you intend children to have access to the premises, for example (but not exclusively) nudity or semi-nudity, films for restricted age groups etc gambling machines etc.

n/a

Section 17 of 21

HOURS PREMISES ARE OPEN TO THE PUBLIC

Standard Days And Timings

MONDAY

Start

End

Start

End

Give timings in 24 hour clock. (e.g., 16:00) and only give details for the days of the week when you intend the premises to be used for the activity.

Continued from previous page...

TUESDAY

Start	<input type="text" value="08:00"/>	End	<input type="text" value="00:00"/>
Start	<input type="text"/>	End	<input type="text"/>

WEDNESDAY

Start	<input type="text" value="08:00"/>	End	<input type="text" value="00:00"/>
Start	<input type="text"/>	End	<input type="text"/>

THURSDAY

Start	<input type="text" value="08:00"/>	End	<input type="text" value="00:00"/>
Start	<input type="text"/>	End	<input type="text"/>

FRIDAY

Start	<input type="text" value="08:00"/>	End	<input type="text" value="01:00"/>
Start	<input type="text"/>	End	<input type="text"/>

SATURDAY

Start	<input type="text" value="08:00"/>	End	<input type="text" value="01:00"/>
Start	<input type="text"/>	End	<input type="text"/>

SUNDAY

Start	<input type="text" value="08:00"/>	End	<input type="text" value="00:00"/>
Start	<input type="text"/>	End	<input type="text"/>

State any seasonal variations

For example (but not exclusively) where the activity will occur on additional days during the summer months.

Non standard timings. Where you intend to use the premises to be open to the members and guests at different times from those listed in the column on the left, list below

For example (but not exclusively), where you wish the activity to go on longer on a particular day e.g. Christmas Eve.

08:00hrs x 01:00hrs - Valentine's Day, Christmas Eve, New Year's Eve, Bank Holidays and Sundays preceding Bank Holidays.

Section 18 of 21

LICENSING OBJECTIVES

Describe the steps you intend to take to promote the four licensing objectives:

a) General – all four licensing objectives (b,c,d,e)

Continued from previous page...

List here steps you will take to promote all four licensing objectives together.

This is an established cider producer that wishes to develop their business model to include On Sales via a Taproom/Bottle Shop and Off Sales via Internet, Mail Order, Telephone with additional Home Delivery Service. We also wish to regularise an annual Cider Festival that occurs on the grounds, with an attendance of no more than 500 persons.

b) The prevention of crime and disorder

1. An incident log must be kept at the premises. Incident log records will be retained for a period of 12 months from the date it occurred. It will be made immediately available on request to an 'authorised person' (as defined by Section 13 of the Licensing Act 2003), an authorised Trading Standards Officer or the Police, and must record the following:

(a) all crimes reported to the premises (where relevant to the licensing objectives)

(b) all ejections of patrons

(c) any complaints received (where relevant to the licensing objectives)

(d) any incidents of disorder

(e) any refusal of the sale of alcohol

(f) any visit by a relevant authority or emergency services, noting time, date & purpose and those officials by name.

2. All staff engaged in the sale of alcohol to be trained in Responsible Alcohol Retailing to the minimum standard of BIIAB1 or any equivalent training course within one month of commencing employment at the premises. No person shall be authorised to sell or supply alcohol until this training is completed. Refresher training will be carried out at 6 monthly intervals. Training records shall be kept on the premises and produced to the police or an 'authorised person' (as defined by Section 13 of the Licensing Act 2003) or an authorised Trading Standards Officer of the Local Authority/ Council) on demand.

c) Public safety

d) The prevention of public nuisance

3. Noise or vibration shall not emanate from the premises so as to cause a nuisance.

4. The Premises Licence Holder or DPS or the responsible person must immediately comply with any request to adjust noise levels/ frequency spectra made by an 'authorised person' (as defined by Section 13 of the Licensing Act 2003) or the Police.

e) The protection of children from harm

5. The premises shall operate a Challenge 25 Policy. Such policy shall be written down and kept at the premises. The policy shall be produced on demand of the Police or an 'authorised person' (as defined by Section 13 of the Licensing Act 2003) or an authorised Trading Standards Officer the Local Authority/Council. Prominent, clear and legible signage (in not less than 32 font bold) shall also be displayed at all entrances to the premises as well as at, at least one location behind any counter advertising the scheme operated.

6. A written register of Refusals will be kept including a description of the people who have been unable to provide required identification to prove their age. Such records shall be kept for a period of 12 months and will be collected by the Designated Premises Supervisor and produced to the police or an 'authorised person' (as defined by Section 13 of the Licensing Act 2003) or an authorised Trading Standards Officer the Local Authority/Council on demand.

INTERNET SALES:

7. The Premises Licence Holder shall ensure that any person who purchases from the site shall register with the site. Such registration details shall include the person's full name, full address, date of birth and phone number. Records of such registrations shall be kept for a period of 12 months and shall be produced on demand of the police or an 'authorised

Continued from previous page...

person' (as defined by Section 13 of the Licensing Act 2003) or an authorised Trading Standards Officer of Herefordshire Council. The website shall contain a declaration to the fact that purchasers' details will be checked to ensure eligibility to the sale.

8. The terms and conditions of the company website will contain the following: -

- a) The company will not sell alcohol to any person until it has been verified that the person is over 18 years of age.
- b) An age confirmation requirement when registering to purchase.
- c) The only payment acceptable shall be 'PayPal' or bank payment card or any other similar type of payment which requires the person to be aged 18 years old or over to obtain such method of payment. Debit cards will not be acceptable.
- d) Reference to the operating of a Challenge 25 policy.
- e) That no parcels will be left by the courier if the person at the delivery address is under 18 years of age.

DELIVERIES:

9. The person delivering the alcohol to the premises shall operate a Challenge 25 policy and shall require proof of age prior to the alcohol being handed over. No alcohol shall be handed over to a person under 18. The only acceptable proof of identity shall be a photographic driver's licence, a passport or an Identity Card containing the PASS Hologram. The website shall contain a declaration to this effect.

Section 19 of 21

NOTES ON DEMONSTRATING ENTITLEMENT TO WORK IN THE UK

Continued from previous page...

Entitlement to work/immigration status for individual applicants and applications from partnerships which are not limited liability partnerships:

A licence may not be held by an individual or an individual in a partnership who is resident in the UK who:

- does not have the right to live and work in the UK; or
- is subject to a condition preventing him or her from doing work relating to the carrying on of a licensable activity.

Any premises licence issued in respect of an application made on or after 6 April 2017 will become invalid if the holder ceases to be entitled to work in the UK.

Applicants must demonstrate that they have an entitlement to work in the UK and are not subject to a condition preventing them from doing work relating to the carrying on of a licensable activity. They do this in one of two ways: 1) by providing with this application copies or scanned copies of the documents listed below (which do not need to be certified), or 2) by providing their 'share code' to enable the licensing authority to carry out a check using the Home Office online right to work checking service (see below).

Documents which demonstrate entitlement to work in the UK

- An expired or current passport showing the holder, or a person named in the passport as the child of the holder, is a British citizen or a citizen of the UK and Colonies having the right of abode in the UK [please see note below about which sections of the passport to copy].
- An expired or current passport or national identity card showing the holder, or a person named in the passport as the child of the holder, is a national of a European Economic Area country or Switzerland.
- A Registration Certificate or document certifying permanent residence issued by the Home Office to a national of a European Economic Area country or Switzerland.
- A Permanent Residence Card issued by the Home Office to the family member of a national of a European Economic Area country or Switzerland.
- A **current** Biometric Immigration Document (Biometric Residence Permit) issued by the Home Office to the holder indicating that the person named is allowed to stay indefinitely in the UK, or has no time limit on their stay in the UK.
- A **current** passport endorsed to show that the holder is exempt from immigration control, is allowed to stay indefinitely in the UK, has the right of abode in the UK, or has no time limit on their stay in the UK.
- A **current** Immigration Status Document issued by the Home Office to the holder with an endorsement indicating that the named person is allowed to stay indefinitely in the UK or has no time limit on their stay in the UK, **when produced in combination with** an official document giving the person's permanent National Insurance number and their name issued by a Government agency or a previous employer.
- A birth or adoption certificate issued in the UK, **when produced in combination with** an official document giving the person's permanent National Insurance number and their name issued by a Government agency or a previous employer.
- A birth or adoption certificate issued in the Channel Islands, the Isle of Man or Ireland **when produced in combination with** an official document giving the person's permanent National Insurance number and their name issued by a Government agency or a previous employer.
- A certificate of registration or naturalisation as a British citizen, **when produced in combination with** an official document giving the person's permanent National Insurance number and their name issued by a Government agency or a previous employer.

Continued from previous page...

- A **current** passport endorsed to show that the holder is allowed to stay in the UK and is currently allowed to work and is not subject to a condition preventing the holder from doing work relating to the carrying on of a licensable activity.
- A **current** Biometric Immigration Document (Biometric Residence Permit) issued by the Home Office to the holder which indicates that the named person can currently stay in the UK and is allowed to work relation to the carrying on of a licensable activity.
- A **current** Residence Card issued by the Home Office to a person who is not a national of a European Economic Area state or Switzerland but who is a family member of such a national or who has derivative rights or residence.
- A **current** Immigration Status Document containing a photograph issued by the Home Office to the holder with an endorsement indicating that the named person may stay in the UK, and is allowed to work and is not subject to a condition preventing the holder from doing work relating to the carrying on of a licensable activity **when produced in combination with** an official document giving the person's permanent National Insurance number and their name issued by a Government agency or a previous employer.
- A Certificate of Application, **less than 6 months old**, issued by the Home Office under regulation 18(3) or 20(2) of the Immigration (European Economic Area) Regulations 2016, to a person who is not a national of a European Economic Area state or Switzerland but who is a family member of such a national or who has derivative rights of residence.
- Reasonable evidence that the person has an outstanding application to vary their permission to be in the UK with the Home Office such as the Home Office acknowledgement letter or proof of postage evidence, or reasonable evidence that the person has an appeal or administrative review pending on an immigration decision, such as an appeal or administrative review reference number.
- Reasonable evidence that a person who is not a national of a European Economic Area state or Switzerland but who is a family member of such a national or who has derivative rights of residence in exercising treaty rights in the UK including:-
 - evidence of the applicant's own identity – such as a passport,
 - evidence of their relationship with the European Economic Area family member – e.g. a marriage certificate, civil partnership certificate or birth certificate, and
 - evidence that the European Economic Area national has a right of permanent residence in the UK or is one of the following if they have been in the UK for more than 3 months:
 - (i) working e.g. employment contract, wage slips, letter from the employer,
 - (ii) self-employed e.g. contracts, invoices, or audited accounts with a bank,
 - (iii) studying e.g. letter from the school, college or university and evidence of sufficient funds; or
 - (iv) self-sufficient e.g. bank statements.

Family members of European Economic Area nationals who are studying or financially independent must also provide evidence that the European Economic Area national and any family members hold comprehensive sickness insurance in the UK. This can include a private medical insurance policy, an EHIC card or an S1, S2 or S3 form.

Original documents must not be sent to licensing authorities. If the document copied is a passport, a copy of the following pages should be provided:-

- (i) any page containing the holder's personal details including nationality;
- (ii) any page containing the holder's photograph;
- (iii) any page containing the holder's signature;
- (iv) any page containing the date of expiry; and
- (v) any page containing information indicating the holder has permission to enter or remain in the UK and is permitted to work.

Continued from previous page...

If the document is not a passport, a copy of the whole document should be provided.

Your right to work will be checked as part of your licensing application and this could involve us checking your immigration status with the Home Office. We may otherwise share information with the Home Office. Your licence application will not be determined until you have complied with this guidance.

Home Office online right to work checking service

As an alternative to providing a copy of the documents listed above, applicants may demonstrate their right to work by allowing the licensing authority to carry out a check with the Home Office online right to work checking service.

To demonstrate their right to work via the Home Office online right to work checking service, applicants should include in this application their 9-digit share code (provided to them upon accessing the service at <https://www.gov.uk/prove-right-to-work>) which, along with the applicant's date of birth (provided within this application), will allow the licensing authority to carry out the check.

In order to establish the applicant's right to work, the check will need to indicate that the applicant is allowed to work in the United Kingdom and is not subject to a condition preventing them from doing work relating to the carrying on of a licensable activity.

An online check will not be possible in all circumstances because not all applicants will have an immigration status that can be checked online. The Home Office online right to work checking service sets out what information and/or documentation applicants will need in order to access the service. Applicants who are unable to obtain a share code from the service should submit copy documents as set out above.

Section 20 of 21

NOTES ON REGULATED ENTERTAINMENT

Continued from previous page...

In terms of specific **regulated entertainments** please note that:

- Plays: no licence is required for performances between 08:00 and 23.00 on any day, provided that the audience does not exceed 500.
- Films: no licence is required for 'not-for-profit' film exhibition held in community premises between 08.00 and 23.00 on any day provided that the audience does not exceed 500 and the organiser (a) gets consent to the screening from a person who is responsible for the premises; and (b) ensures that each such screening abides by age classification ratings.
- Indoor sporting events: no licence is required for performances between 08.00 and 23.00 on any day, provided that the audience does not exceed 1000.
- Boxing or Wrestling Entertainment: no licence is required for a contest, exhibition or display of Greco-Roman wrestling, or freestyle wrestling between 08.00 and 23.00 on any day, provided that the audience does not exceed 1000. Combined fighting sports – defined as a contest, exhibition or display which combines boxing or wrestling with one or more martial arts – are licensable as a boxing or wrestling entertainment rather than an indoor sporting event.
- Live music: no licence permission is required for:
 - o a performance of unamplified live music between 08.00 and 23.00 on any day, on any premises.
 - o a performance of amplified live music between 08.00 and 23.00 on any day on premises authorised to sell alcohol for consumption on those premises, provided that the audience does not exceed 500.
 - o a performance of amplified live music between 08.00 and 23.00 on any day, in a workplace that is not licensed to sell alcohol on those premises, provided that the audience does not exceed 500.
 - o a performance of amplified live music between 08.00 and 23.00 on any day, in a church hall, village hall, community hall, or other similar community premises, that is not licensed by a premises licence to sell alcohol, provided that (a) the audience does not exceed 500, and (b) the organiser gets consent for the performance from a person who is responsible for the premises.
 - o a performance of amplified live music between 08.00 and 23.00 on any day, at the non-residential premises of (i) a local authority, or (ii) a school, or (iii) a hospital, provided that (a) the audience does not exceed 500, and (b) the organiser gets consent for the performance on the relevant premises from: (i) the local authority concerned, or (ii) the school or (iii) the health care provider for the hospital.
- Recorded Music: no licence permission is required for:
 - o any playing of recorded music between 08.00 and 23.00 on any day on premises authorised to sell alcohol for consumption on those premises, provided that the audience does not exceed 500.
 - o any playing of recorded music between 08.00 and 23.00 on any day, in a church hall, village hall, community hall, or other similar community premises, that is not licensed by a premises licence to sell alcohol, provided that (a) the audience does not exceed 500, and (b) the organiser gets consent for the performance from a person who is responsible for the premises.
 - o any playing of recorded music between 08.00 and 23.00 on any day, at the non-residential premises of (i) a local authority, or (ii) a school, or (iii) a hospital, provided that (a) the audience does not exceed 500, and (b) the organiser gets consent for the performance on the relevant premises from: (i) the local authority concerned, or (ii) the school proprietor or (iii) the health care provider for the hospital.

Continued from previous page...

- Dance: no licence is required for performances between 08.00 and 23.00 on any day, provided that the audience does not exceed 500. However, a performance which amounts to adult entertainment remains licensable.
- Cross activity exemptions: no licence is required between 08.00 and 23.00 on any day, with no limit on audience size for:
 - o any entertainment taking place on the premises of the local authority where the entertainment is provided by or on behalf of the local authority;
 - o any entertainment taking place on the hospital premises of the health care provider where the entertainment is provided by or on behalf of the health care provider;
 - o any entertainment taking place on the premises of the school where the entertainment is provided by or on behalf of the school proprietor; and
 - o any entertainment (excluding films and a boxing or wrestling entertainment) taking place at a travelling circus, provided that (a) it takes place within a moveable structure that accommodates the audience, and (b) that the travelling circus has not been located on the same site for more than 28 consecutive days.

Section 21 of 21

PAYMENT DETAILS

This fee must be paid to the authority. If you complete the application online, you must pay it by debit or credit card.

Premises Licence Fees are determined by the non domestic rateable value of the premises.

To find out a premises non domestic rateable value go to the Valuation Office Agency site at http://www.voa.gov.uk/business_rates/index.htm

Band A - No RV to £4300 £100.00

Band B - £4301 to £33000 £190.00

Band C - £33001 to £87000 £315.00

Band D - £87001 to £125000 £450.00*

Band E - £125001 and over £635.00*

*If the premises rateable value is in Bands D or E and the premises is primarily used for the consumption of alcohol on the premises then you are required to pay a higher fee.

Band D - £87001 to £125000 £900.00

Band E - £125001 and over £1,905.00

There is an exemption from the payment of fees in relation to the provision of regulated entertainment at church halls, chapel halls or premises of a similar nature, village halls, parish or community halls, or other premises of a similar nature. The costs associated with these licences will be met by central Government. If, however, the licence also authorises the use of the premises for the supply of alcohol or the provision of late night refreshment, a fee will be required.

Schools and sixth form colleges are exempt from the fees associated with the authorisation of regulated entertainment where the entertainment is provided by and at the school or college and for the purposes of the school or college.

If you operate a large event you are subject to ADDITIONAL fees based upon the number in attendance at any one time.

Capacity 5000-9999 £1,000.00

Capacity 10000 -14999 £2,000.00

Capacity 15000-19999 £4,000.00

Capacity 20000-29999 £8,000.00

Capacity 30000-39999 £16,000.00

Capacity 40000-49999 £24,000.00

Capacity 50000-59999 £32,000.00

Capacity 60000-69999 £40,000.00

Capacity 70000-79999 £48,000.00

Capacity 80000-89999 £56,000.00

Capacity 90000 and over £64,000.00

* Fee amount (£)

100.00

DECLARATION

Continued from previous page...

* I/we understand it is an offence, liable on conviction to a fine up to level 5 on the standard scale, under section 158 of the licensing act 2003, to make a false statement in or in connection with this application.

[Applicable to individual applicants only, including those in a partnership which is not a limited liability partnership] I understand I am not entitled to be issued with a licence if I do not have the entitlement to live and work in the UK (or if I am subject to a condition preventing me from doing work relating to the carrying on of a licensable activity) and that my licence will become invalid if I cease to be entitled to live and work in the UK (please read guidance note 15).

The DPS named in this application form is entitled to work in the UK (and is not subject to conditions preventing him or her from doing work relating to a licensable activity) and I have seen a copy of his or her proof of entitlement to work, if appropriate (please see note 15)

Ticking this box indicates you have read and understood the above declaration

This section should be completed by the applicant, unless you answered "Yes" to the question "Are you an agent acting on behalf of the applicant?"

* Full name

* Capacity

* Date / /
dd mm yyyy

Once you're finished you need to do the following:

1. Save this form to your computer by clicking file/save as...
2. Go back to <https://www.gov.uk/apply-for-a-licence/premises-licence/herefordshire/apply-1> to upload this file and continue with your application.

Don't forget to make sure you have all your supporting documentation to hand.

IT IS AN OFFENCE LIABLE TO SUMMARY CONVICTION TO A FINE OF ANY AMOUNT UNDER SECTION 158 OF THE LICENSING ACT 2003, TO MAKE A FALSE STATEMENT IN OR IN CONNECTION WITH THIS APPLICATION

IT IS AN OFFENCE UNDER SECTION 24B OF THE IMMIGRATION ACT 1971 FOR A PERSON TO WORK WHEN THEY KNOW, OR HAVE REASONABLE CAUSE TO BELIEVE, THAT THEY ARE DISQUALIFIED FROM DOING SO BY REASON OF THEIR IMMIGRATION STATUS. THOSE WHO EMPLOY AN ADULT WITHOUT LEAVE OR WHO IS SUBJECT TO CONDITIONS AS TO EMPLOYMENT WILL BE LIABLE TO A CIVIL PENALTY UNDER SECTION 15 OF THE IMMIGRATION, ASYLUM AND NATIONALITY ACT 2006 AND PURSUANT TO SECTION 21 OF THE SAME ACT, WILL BE COMMITTING AN OFFENCE WHERE THEY DO SO IN THE KNOWLEDGE, OR WITH REASONABLE CAUSE TO BELIEVE, THAT THE EMPLOYEE IS DISQUALIFIED

OFFICE USE ONLY

Applicant reference number	<input type="text" value="56-20"/>
Fee paid	<input type="text"/>
Payment provider reference	<input type="text"/>
ELMS Payment Reference	<input type="text"/>
Payment status	<input type="text"/>
Payment authorisation code	<input type="text"/>
Payment authorisation date	<input type="text"/>
Date and time submitted	<input type="text"/>
Approval deadline	<input type="text"/>
Error message	<input type="text"/>
Is Digitally signed	<input type="checkbox"/>

[1](#) [2](#) [3](#) [4](#) [5](#) [6](#) [7](#) [8](#) [9](#) [10](#) [11](#) [12](#) [13](#) [14](#) [15](#) [16](#) [17](#) [18](#) [19](#) [20](#) [21](#) [Next >](#)

Consent of Individual to being specified as Premises Supervisor

David Stuart FLETCHER

I
[full name of prospective premises supervisor]

of

[REDACTED]
[REDACTED]
[REDACTED]
[REDACTED]
[REDACTED]

[home address of prospective premises supervisor]

hereby confirm that I give my consent to be specified as the designated premises supervisor in relation to the application for:

Grant of a Premises Licence

[type of application]

by

Gillow Cider

[name of applicant]

tba

relating to a premises licence
[number of existing licence, if any]

for a premises called

Gillow Manor
St Owen's Cross
HEREFORD
Herefordshire
HR2 8LE

[name and address of premises to which the application relates]

and any premises licence to be granted or varied in respect of this application made by

Gillow Cider

[name of applicant]

concerning the supply of alcohol at

Gillow Manor
St Owen's Cross
HEREFORD
Herefordshire
HR2 8LE

[name and address of premises to which application relates]

I also confirm that I am entitled to work in the United Kingdom and am applying for a personal licence, details of which I set out below.

Personal licence number



[insert personal licence number, if any]

Personal Licence Issuing Authority

Herefordshire Council

[insert name and address and telephone number of personal licence issuing authority, if any]

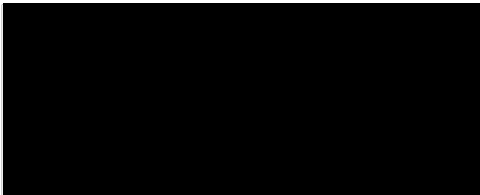

Signed

David Stuart FLETCHER

Name (please print)

23rd June 2020

Date

1

Gillow Cider, Gillow Manor, St Owens Cross, Herefordshire. HR281E
Scale 1:1000

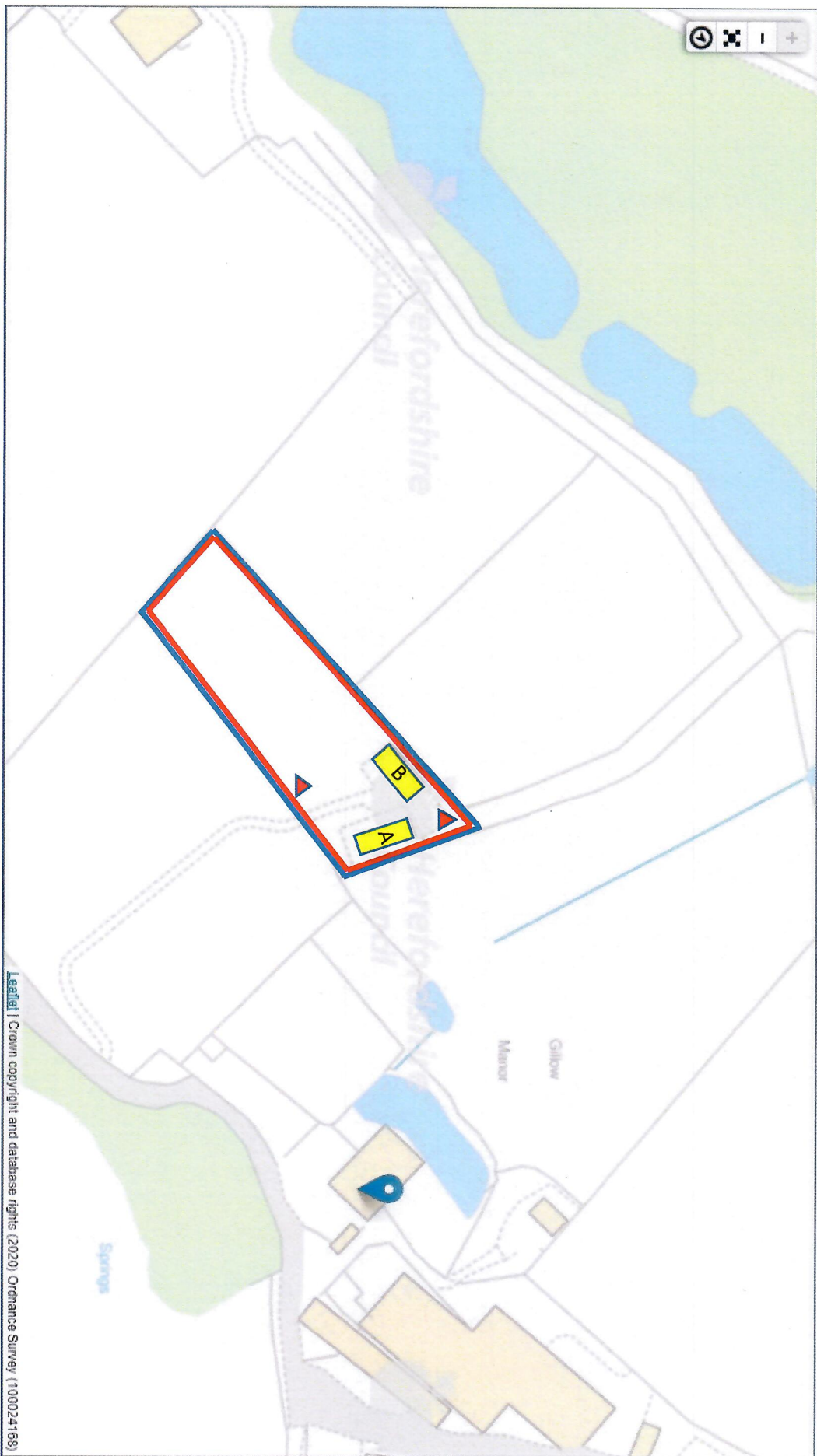

-  Licensable Activity
-  Consumption Area
-  Fire Point 2 x Water Extinguisher 1 x Sand Bucket

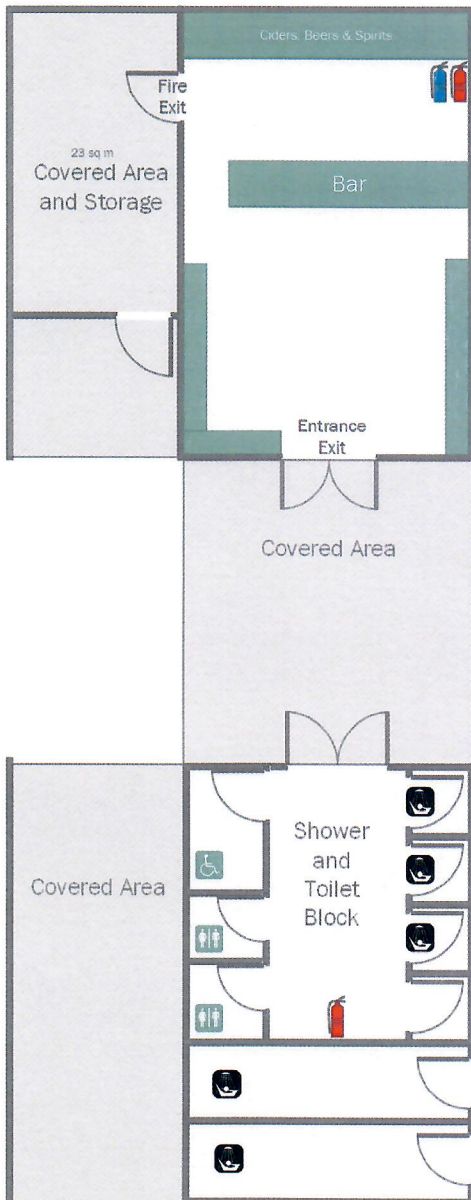

Leaflet | Crown copyright and database rights (2020) Ordnance Survey (100024189)

Building A



-  Fire Extinguisher Water
-  Fire Extinguisher Co2
-  Wooden Pillar

Scale 1:100

Gillow Cider,
Gillow Farm,
St Owens Cross,
Herefordshire
HR2 8LE

Building B

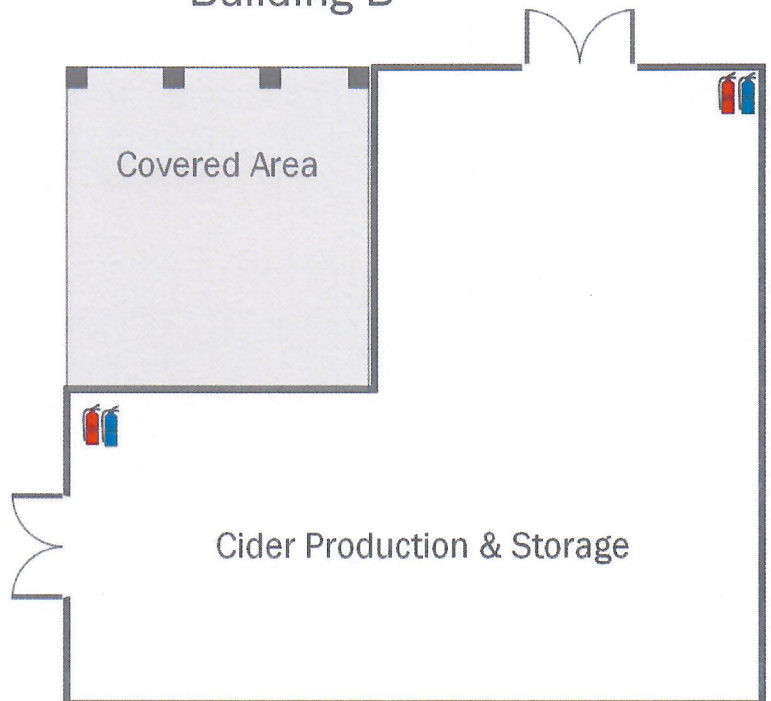

MEMORANDUM

To : LICENSING OFFICER

From : Environmental Health

Tel : 01432 261914 My Ref : JOM/309147/

Date : 22 July 2020 Your Ref :

LICENSING ACT 2003
APPLICATION FOR NEW PREMISES LICENCE
Gillow Cider, Gillow Manor, St Owens Cross, Hereford, Herefordshire, HR2 8LE

Having assessed the above application, I would like to make the following representation ; this is a holding objection:

Representation	Industry Guidance
PREVENTION OF CRIME & DISORDER	
PUBLIC SAFETY	
<p>PREVENTION OF PUBLIC NUISANCE</p> <p>The application is for:</p> <ul style="list-style-type: none"> (i) operating hours 09:00 – 23:00hrs 7 days a week, Friday and Saturdays extending to 01:00hrs, and extras on bank holidays and Sundays immediately prior. (ii) Live Music indoors and outside for the above hours (iii) Recorded music indoors for the above hours. <p>The location is rural, where usual background noise can be much lower than urban areas particularly after 23:00hrs.</p> <p>Considering the proposed extensive hours of operation, the rural location, the playing of live music both inside & outside with associated amplification systems, customer vehicular traffic, deliveries and rattling of bottles/recycling, seating areas (needing to be expanded now to conform with COVID -19 social distancing), smoking areas, people noise and the proximity of neighbouring dwellings, etc,; there is an increased risk of noise complaints to this service. There may also be complaints about artificial light.</p> <p>The EH-Environmental Protection team was not consulted prior to this application nor was a suitable and sufficient comprehensive Noise Management Plan (NMP) provided to assist consideration of the application. Submission of such an NMP for approval by the Environmental Health Noise Team is considered necessary for this application.</p>	<p>s.79 Environmental Protection Act 1990: Statutory Nuisance (Noise and artificial light)</p> <p>Noise Management Plans (NMP)</p>

REFERENCES

Please Reference the industry guidance from which your representation has been sourced.

**ENVIRONMENTAL HEALTH OFFICER
HEREFORDSHIRE COUNCIL**

Public Reps

From: [REDACTED]
Sent: 22 July 2020 13:52
To: Licensing
Subject: Gillow Cider - Extension to Licensing Hours

Dear Sir/Madam,

The current licensing application from Gillow Cider has only just come to our attention!

We hope the council reject this application and say No.

We live at 2 Meadow Heights Saint Owens Cross HR2 8NP and whilst we can accept and put up with the Cider Festival which is only once a year - the thought of having live or recorded music played whenever Gillow Farm wants is totally unacceptable.

This would definitely be a Public Nuisance to us since the noise (which is extremely loud) would disturb us whenever it was played as well as hearing the introductions to the acts.

The loud noise is what we've experienced in the past (moved here in 2014) and what we anticipate it will be like in the future.

Outside and with the windows open we can hear the introductions word for word, the loud music with audience appreciation and/or joining in getting more raucous as the evening progresses!

With the windows shut we can hear muffled voices and the loud/heavy beat of the music which is very disturbing going on for so long into the night. This is bearable once a year – But not more frequently.

Please do Not allow this extension to Gillow Farm's Licensing Hours.

Thank you,

-----Original Message-----

From: [REDACTED]
Sent: 12 July 2020 17:44
To: Licensing <licensing@herefordshire.gov.uk>
Subject: Gillow manor licence application

Dear Sirs

We object to this application on following grounds 1/ our single track road cannot cope with 20 vehicles it would be an absolute grid lock with a 100 let alone 500. If there is an incident on A49 this lane gets unbearable with the diverted traffic coming through added to the increased traffic involved with Manor events we would become prisoners in our own home 2/ The noise after 10:00 pm is unacceptable now when they have events the increase in events would make life unbearable. Especially with the fireworks after midnight.

Yours faithfully

From: [REDACTED]
Sent: 20 July 2020 08:08
To: Licensing <licensing@herefordshire.gov.uk>
Subject: Application for a premises licence - Gillow Cider, St Owens Cross, HR2 8LE PRO1912

Dear Sirs

Application for a premises licence – Gillow Cider, St Owens Cross, HR2 8LE - PRO1912

I write in connection with the above application and the adverse impact it will have on the local community.

At present there is a three day festival which one lives with as it is a one off annual event even though noise nuisance is encountered, however if this application is agreed it will have a very detrimental effect on the quality of life as the noise levels will be experienced on a regular basis.

Road safety also needs to be taken into consideration, the access to the site itself is via a one-track road, which comes off a major road the A4137 – this is a very dangerous road with many accidents occurring. The access follows a blind bend, coming out of a speed-restricted area.

I am surprised that there is such a radical change in the licensing request to go from a few days per year to practically the entire year, which is quite disproportionate.

I am not sure if ecologists have to comment on the application, but the grounds are very historic with old buildings and not sure if any colonies of bats are present, if they will also be affected by this proposed change.

Yours faithfully

From: [REDACTED]
Sent: 18 July 2020 13:35
To: Licensing <licensing@herefordshire.gov.uk>
Subject: Gillow Cider

Good evening,

I am writing on behalf of myself, my mother and step father who lives 0.5miles from Gillow Manor, where they have applied for an extension of Licensing Hours until 23.00 everyday of the week and 1.00am on Bank Holidays etc.

As a house hold we would like to object to this extension.

Our reasons are as follows;

When they have the Gillow Cider Festive each year, we can hear it from our house, and all of us struggle to sleep.

Both my mum and step dad work as support worker in the shared lives scheme for hereford Council and will soon be having an individual with learning disabilities living with us and I work as a senior support worker, so we all work unsociable hours.

So we would not be willing to sacrifice our sleep everyday of the year, especially as in the hot weather, we all sleep with the windows open, and we do not want any repercussions of the loud

music, causing any challenging behaviour with the individual that will be living with us at the above dress.

Kind regards

From: [REDACTED]
Sent: 19 July 2020 19:58
To: Licensing <licensing@herefordshire.gov.uk>
Subject: Gillow cider- Extension to Licensing Hours

To whom it may concern,

Regarding the application to play music on almost any day of the year at Gillow Farm, I and my husband live in St Owens Cross and can hear the festival quite clearly from our house. We put up with it as it is only once a year. However the possibility of it being any or every day of the year is an awful prospect, especially for anyone with young children trying to get them to bed. We feel the application is completely unreasonable.

So I cannot stress too strongly that we very much object to this application.

-----Original Message-----

From: [REDACTED]
Sent: 21 July 2020 16:26
To: Licensing <licensing@herefordshire.gov.uk>
Subject: Gillow Cider License Application

Regarding the Gillow Cider license application. I wish to oppose the granting of a license to play music, I have no objection to the sale of alcohol. I live about 1.7 Km direct line from the premises and in previous years during the festival the noise has been obtrusive to the extent that it made sleeping difficult even with the windows closed. The license application appears to allow them to do this every day of the year. I can't see any reason why they should play music outdoors except during the festival.

From: [REDACTED]
Sent: 22 July 2020 11:02
To: Licensing <licensing@herefordshire.gov.uk>
Subject: Gillow Cider - Extension to licensing hours

To whom it may concern,

I would like to raise an objection to the proposal by Gillow Cider to extend licensing hours until 1am on friday and saturday nights due to the public nuisance caused by the noise of live music.

The Gillow Cider festival is extremely loud, we can clearly hear the words to music while lying in bed at midnight. This is tolerable because it is an event that occurs once a year, however this would be a significant nuisance to endure every weekend.

I support the license for the proposed cider tap without music past 11pm.

regards

Ballingham Bolstone & Hentland Group Parish Council

[REDACTED]
[REDACTED]
[REDACTED]
[REDACTED]

20/07/2020

Dear Sirs,

**Application for a premises licence – Gillow Cider, St Owens Cross, HR2 8LE
Licensing Act 2003**

The Group Parish Council strongly objects to the application in its present form. We wish to make representations regarding the adverse impact on the local community, farm owners and businesses, were the above application to be granted in full or part. After discussion at a recent Group Parish Council meeting, we submit that any substantial expansion of activity involving music and/or vehicle movements at Gillow Manor/Gillow Cider would be significantly detrimental to local residents, businesses, road safety and public health.

The Group Parish Council also wishes to submit amendments to the application for your consideration, should you be minded to grant the application in part. These amendments follow our representations, below.

Representations

Our representations relate to:

1. Prevention of Public Nuisance.

The noise level and disturbance likely to be generated by an increase in events held at Gillow Manor/Gillow Cider, were the application to be granted.

Inadequate sanitation for 500 people will inevitably result in visitors to events using trees and bushes in the vicinity as makeshift toilets, causing a public nuisance.

2. Public Safety.

Traffic and vehicle movements. The danger of frequent vehicle movements from the A4137 into and out of the Gillow Manor/Gillow Cider premises, accessed along a narrow road.

Sanitation and waste management. As a matter of Public Safety, we are also concerned that Gillow Cider has failed to provide any assurances regarding sanitation and waste management at the site.

1) Prevention of Public Nuisance

The settlement of St Owens Cross lies 500 metres away from Gillow Manor, location of the Gillow Cider enterprise and will be directly adversely affected by the proposed changes to licensing hours and the use of live and/or recorded music. Other agricultural businesses lie even closer and will be severely affected by noise and traffic increases.

For many years the residents of St Owens Cross have tolerated the high noise level during the annual Gillow Cider Festival. When music is played at the festival, it can be heard clearly well over 2 kilometres away in this and adjoining Parishes throughout the three day festival from before lunchtime until very late evening. Music is normally played outdoors or in marquee tents. These afford no muffling, suppression or mitigation of the sound generated. Such is the level of sound produced that we feel even a solidly-built event hall would not suppress the noise level to a tolerable extent.

The sound level during the Gillow Cider Festival is loud enough to preclude residents up to 1.5 kilometres away from sitting in their gardens and can be heard indoors sufficiently to drown out television volume at a normal level. For the sake of tourism and support to a local event – The Gillow Festival - the residents have shown great forbearance in past years.

A recently renovated coaching inn – The New Inn – has a beer garden that will be adversely affected by the excessive noise levels from Gillow Manor/Gillow Cider. The present Covid-19 situation means that most visitors to The New Inn will be obliged to sit in the beer garden and will be exposed to unwelcome and excessive sound levels in what is supposed to be a tranquil environment.

Many of the residents in the area of St Owens Cross area are agricultural workers who, typically, get up early and go to bed early. The Gillow Cider application seeks permission to play music to an audience of up to 500 from 0900hrs to 2300hrs, or later on particular days. This is excessive and a disruptive nuisance to local residents, their reasonable enjoyment of the environment and their general health and wellbeing.

The area of St Owens Cross contains many established holiday letting businesses. Loud music and disturbance from traffic will discourage the local tourist trade because visitors come to the area for peace and tranquillity.

2) Public Safety

Traffic and Vehicle Movements

The nearest public transport (a bus service) is approximately 1 kilometre from Gillow Cider. Attendees at events are more likely to arrive by car, chartered coach or motor caravan. This fact is reflected on Gillow Cider's website. The approach to Gillow Cider is narrow, precarious and used, in the main, by agricultural machinery. There are very few passing places.

For most attendees at Gillow Cider, access will be from the A4137. When approaching Gillow Cider from the South, vehicles are required to turn left off the A4137, just after a blind bend with a well-established history of accidents. Although at the edge of a 40mph limit through St Owens Cross, a recent traffic survey indicated that vehicle speeds near this left turn exceed 50mph, on average.

It follows, of course, that vehicles leaving Gillow Cider to go South must make a right turn at the same, dangerous junction. This would be a precarious manoeuvre for any motorist, festival goer or not.

When approaching from the North, vehicles are required to turn immediately right down a narrow track after turning from the A49 on to the A4137. In the past, this manoeuvre has also caused accidents at the busy A49/A4137 junction. This route to the Gillow Manor event site passes a busy farm and agricultural contracting business where large vehicles are in use at all times. The movement of, say 250 cars (500 event attendees, 2 in each car), motor caravans, catering vehicles, live bands, disc jockeys with their entourages and support services amounts to a great deal of traffic on a narrow road, intended for agricultural rather than festival use on a regular basis. This may have been sustainable for three days a year but the applicant seeks to make this possible every day of the year.

Entry to the Gillow Cider site is possible from the West with great care. However, the route is tortuous and narrow. It is unlikely to be used.

Sanitation and Waste Management

The applicant has included plan drawings of two event buildings, said to include three showers and three toilets for the 500 event attendees. However, the Parish Council can find no planning application for these buildings, or mention of the arrangements for safe and effective disposal of waste that the events will generate. It is not enough to say that local services have coped with the annual, three-day, cider festival; this application would cause significantly greater amounts of waste. In view of the inadequate sanitary facilities, public health and safety will be compromised. There is also potential; for a public nuisance caused by the lack of adequate toilet facilities.

Suggested conditions to be placed on the license, if you are minded to grant it at all.

Should you be minded to grant the Gillow Cider application in whole or part, The Group Parish Council would like to make the following submissions on behalf of the Parish residents so that consideration can be given to conditions being imposed:

- a) The times between which the applicant seeks to sell alcohol on site extend beyond those of a 'normal' public house and without limitation as to when this facility can be offered. The applicant is, essentially, creating a public house without the constraints under which adjacent public houses must operate. **We submit that licensed hours should not commence before 1100hrs and, except for Bank Holidays, should cease at 2300hrs. During the Gillow Cider Festival and New Year's Eve, there may be a case for extending licensed hours to midnight, addressed under the TEN system. This is a reasonable compromise between Gillow Cider and the local residents.**
- b) Off sales, internet sales, mail order, telephone ordering and home delivery do not require the extent of licensing that the applicant seeks, or the playing of music. Permitting long hours of

entertainment without consideration of each event will cause disturbance to residents and visitors, as well as road safety issues. **We submit that off-sales, internet sales, mail order and home delivery should be treated as a separate issue to the blanket authorisation for alcohol sales and music during specific events, already adequately addressed under the TEN system.**

- c) To expect local residents, tourist visitors and local businesses to tolerate music being played all day and into the following morning is unreasonable. Each event at Gillow Cider should be scrutinised on its merits before being authorised. The TEN system addresses the issue. **We submit that there should be no blanket approval for events that involve music, live or recorded.**
- d) If you are minded to grant a license for on-sales, there should be some constraint placed on the period during which music can be played and the volume at which it is played. This is to avoid disturbance to residents, tourist visitors, agricultural workers and shift workers. **We submit that, having regard to the location of Gillow Cider, music should only be played between 1000hrs and 2200hrs except when an event is approved under the TEN system.**
- e) The Licensing Authority is at liberty to impose such conditions as they see fit on the playing of live or recorded music. The Live Music Act 2012 allows amplified live music to be played to an audience of less than 500 people between 8am and 11pm, recorded music to be played to an audience of less than 500 people between 8am and 11pm and, unamplified live music to be played between 8am and 11pm to an unlimited audience as long as the venue is licensed for the sale of alcohol for consumption on the premises and where alcohol is on sale during the performance. Where live/recorded music is played which meets these conditions all licence conditions relating to the playing of music are suspended. *In order to meet public order concerns however, the licensing authority may reactivate such conditions or impose new ones. Conditions can be imposed in support of the licensing objectives which include the prevention of crime and disorder and public nuisance* (our emphasis). Experience of the Gillow Cider Festival shows that live and/or recorded music played during that event can be a significant nuisance to residents as far as two kilometres away from the venue. Unless restrictions are placed on the playing of music, there are likely to be a significant number of complaints with concomitant costs and resource issues for the Police and Local Authority.
- f) In the context of noise nuisance and as a precedent, you may wish to consider the comments of the Environmental Health Officer regarding noise issues at Pengethely Manor Hotel, only 1.3 kilometres from Gillow Cider. Complaints had been received from local residents regarding music sound levels from a marquee in the hotel grounds, especially during wedding parties. The hotel sought planning permission for an orangerie to replace the marquee (P190920/F and P190921/L).

In April 2019, the Environmental Health Officer wrote about the (planning) application:

'My comments are with regard to potential noise and nuisance issues that might arise from development.

Please be advised that our department is supplying a holding objection to this proposal as the applicant has not been able to outline how they will control noise on site.

The applicant has applied for planning permission to replace the current marquee housing weddings with a purpose built orangerie.... The current marquee arrangements have not proved satisfactory and our department has received a number of noise complaints so in principle we welcome the establishment of an orangerie as an alternative if it can be demonstrated that it is a well thought through project which at the moment it is not....

...As with the previous application there is a woeful lack of supporting information supplied by the applicant....

We are requesting a noise management plan be supplied by the applicant which details how it is intended to control noise.... This needs to be detailed and specific and outline how it is intended to control noise from outside voices, amplified and non amplified music, circulation space outside of the front (of the orangerie), parking arrangements and associated noise controls... The plan should also contain a complaints procedure and outline how noise will be monitored.'

In the light of (e) and (f), above, we submit that a noise management plan should be submitted by the applicant which details how it is intended to control noise on the Gillow Cider site. This needs to be detailed and specific and outline how it is intended to control noise from outside voices, amplified and non amplified music, parking arrangements and associated noise controls. The plan should also contain a complaints procedure and outline how noise will be monitored.

It is for the Licensing Authority to use its knowledge and expertise to keep the community safe from excessive noise and nuisance.

Yours Faithfully,



Parish Clerk

Ballingham Bolstone & Hentland Group Parish Council

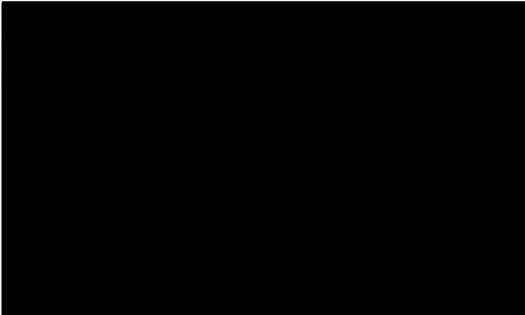

Dear Sir/Madam

Please find enclosed our presentation form +
supporting information regarding our objections to
the licensing application made by MR Dave Fletcher
of Gillow Cider Gillow Manor HR2 8LE

Kind Regards

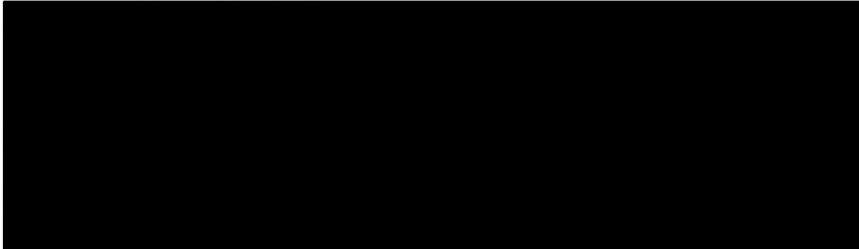



Please return this form, and any additional information within the statutory period to:
**The Licensing Section,
 Herefordshire Council,
 8 St Owen Street,
 Hereford,
 HR1 2PJ**
 licensing@herefordshire.gov.uk

**HEREFORDSHIRE COUNCIL
 Licensing Act 2003**

REPRESENTATION FORM – INTERESTED PARTIES

On making your representation please have regard to the 'Making Representations Guidance Notes' which further explains the process and the information that can be considered by the licensing authority.

When completing this form please print clearly and legibly.

[Redacted]	[Redacted]
[Redacted]	[Redacted]
[Redacted]	local resident
Gillow Cider ,Gillow Manor ,St Owens Cross, Hereford HR2 8LE	

DATA PROTECTION ACT 1998. Please indicate by ticking here if you are not content for your personal details to be circulated as necessary prior to any hearing .

A representation must reflect one or more of the licensing objectives, therefore please write the details of your representation in the relevant boxes below:

To Prevent Crime & Disorder:

This proposed business will encourage and introduce many strangers from far and wide to the area on a regular basis, potentially affecting the security of properties and outbuildings in the area around Gillow manor. When the Cider festival takes place people knock for directions ,and inebriated members of the public wander around the surrounding lanes. This increase in people could lead to increase in crime around the area if happening throughout the year.

Public Safety:

Having a licensed premises that is open to the public 7 days a week will substantially increase the volume of traffic on a single lane, unclassified lane that is the only access to Gillow Manor. There are no official passing places and several blind bends. There are also no public footpaths for pedestrians. The volume of traffic is presently low as mainly used by residents, post and deliveries etc. This application, if granted will substantially increase the volume of traffic on a daily basis. The current annual cider festival that takes place at Gillow Manor has highlighted the increase of traffic using the lane. All this traffic will go directly in front of my house.

This increase in traffic will also severely affect pedestrian safety due to the narrowness of the road being no more than the width of a car. Many walkers use this lane regularly. The entrance to the lane from the A4137 is concealed just beyond a blind bend. The A4137 is a very busy road between Monmouth and Hereford and used by lorries, and is a known accident blackspot.

(photographs of lane are attached)

In conclusion the local lanes cannot take the increases in traffic from up to 500 extra people for these proposed events throughout the year. The extra traffic would be a severe risk to public safety for the reasons outlined above

To Prevent Public Nuisance:

Increased numbers of delivery vehicles will be constantly passing my home.

People visiting the premises day and night in vehicles. Vehicles stopping outside my home to drop people off and pick them up in taxis etc. Slamming of doors and revving of engines potentially up to 1.00 am every night is not acceptable for nearby residents.

Music live and taped can be heard from our home and the vibrations created are intolerable. Once a year at the cider festival is a real nuisance ,but as only once a year can be coped with .

Shouting and singing from events can be heard clearly from our home and exposure to this all year round is not acceptable.

People camping at these events carry on shouting and singing throughout the night. I see from the application there appears to be a toilet and shower block on the site. I believe this has recently been erected and have seen no planning notice for this. I would like to see the planning application for this facility, if there was one ,and the change of use applications of the outbuildings.

We as local residents were given no indication of this new change of use by the owner at any time..

Having a 7 day a week bar/tap room opening up next door to residential properties is totally unacceptable. We have several good public houses nearby and do not need another right next door to our home. And if this application if successful , will enable the applicant to have events throughout the year creating nuisance to all residents.

This is a quiet and rural area that is unsuited to a business of this kind, and residents live here for peace and tranquility, not to be inundated with traffic, people and noise throughout the year.

Will the authorities be prepared to have a police presence at these proposed events?

No consideration has been given to the neighbours and residents surrounding Gillow Manor by the applicant, nor have they have been consulted about this proposal at any time before the application was made.

To Protect Children from Harm



**Representation Form – Interested Parties
Suggested Conditions**

Premise Gillow Manor/Gillow Cider

Your name: _____

It would help us with this application if you could suggest conditions you would be happy for the premise to operate under to rectify the problems you are experiencing.

All suggested conditions shall be considered in line with the Herefordshire Council Licensing Policy, the Licensing Act 2003 and the Licensing Objectives.

To Prevent Crime and Disorder: One weekend event per year only.
Public Safety: As above
Prevent Public Nuisance: As above
Protect Children from Harm

Signed:



Date:

If you have any queries about this form or are unsure of when the statutory period ends please contact the **Licensing Helpline on 01432 261761**



These photographs illustrate the access roads to Gillow Manor from just one direction. (From A4137)

Traffic coming from the other direction will have the same if not worse problems, as it is all ~~is~~ one lane roads in this area, with many blind bends etc.

From: [REDACTED]
Subject: Gillow Manor.pages
Date: 3 Jul 2020 at 12:11:18
To: [REDACTED]



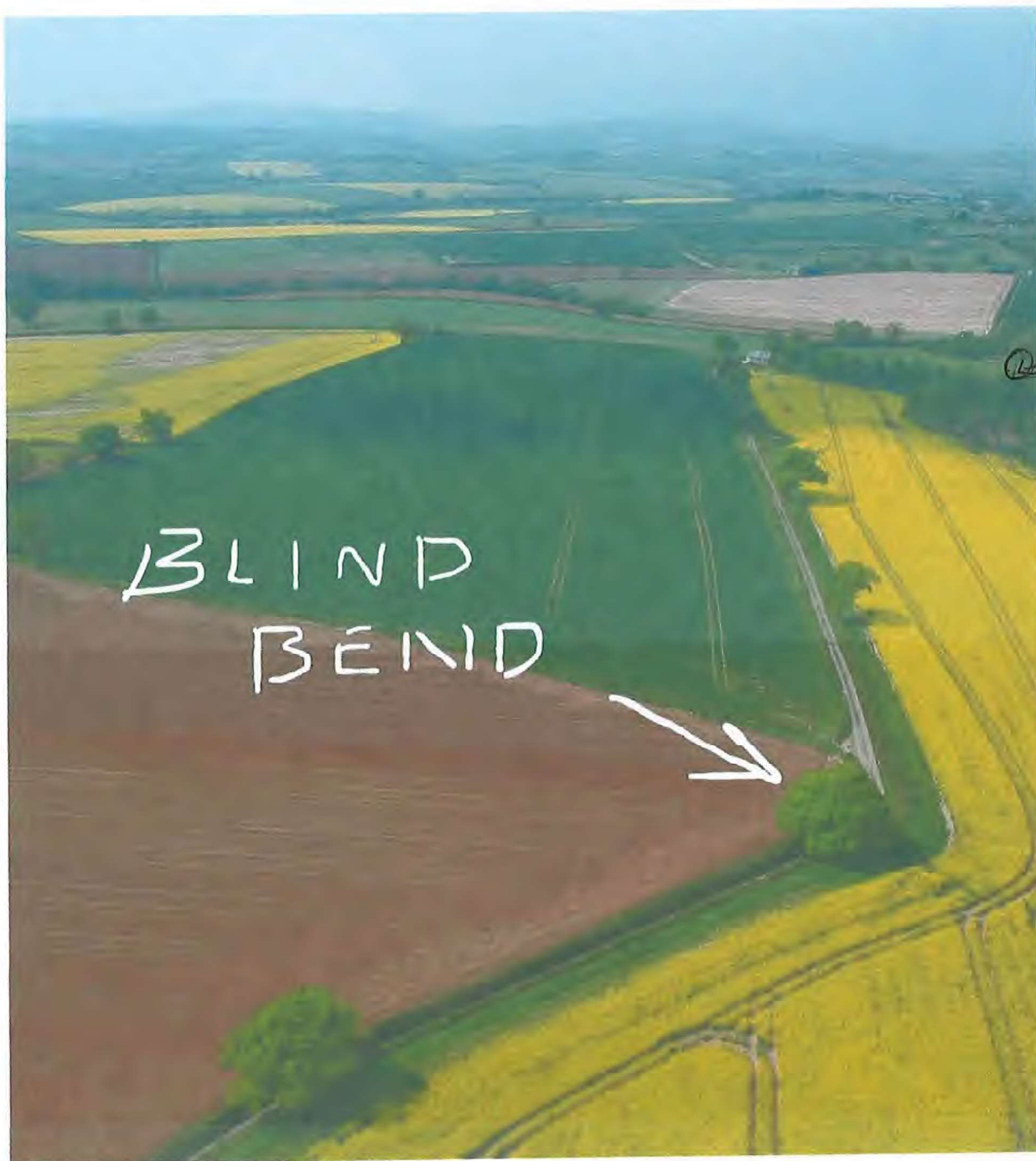

Sent from my iPhone



HEREFORDSHIRE COUNCIL
Licensing Act 2003

REPRESENTATION FORM – INTERESTED
PARTIES

On making your representation please have regard to the 'Making Representations Guidance Notes' which further explains the process and the information that can be considered by the licensing authority.

When completing this form please print clearly and legibly.

Please return this form, and any additional information within the statutory period to:
The Licensing Section,
Herefordshire Council,
8 St Owen Street,
Hereford,
HR1 2PJ
licensing@herefordshire.gov.uk

Your Name: [REDACTED]	Contact Telephone No [REDACTED]
[REDACTED]	E-mail address: [REDACTED]
	Please state your interest in the premises you are making a representation about: Close neighbour to Gillow Manor resident/local business
Name & Address of premises you are making a representation about: Mr. D. Fletcher Gillow Manor/ Gillow Cider St Owens Cross HEREFORD HR2 8LE	

DATA PROTECTION ACT 1998. Please indicate by ticking here if you are not content for your personal details to be circulated as necessary prior to any hearing .

A representation must reflect one or more of the licensing objectives, therefore please write the details of your representation in the relevant boxes below:

To Prevent Crime & Disorder

Due to previous events happening at Gillow Cider Festival drinking alcohol in such a rural area is not a good idea.

/

Public Safety

The access to Gillow Manor is down a very narrow lane any one walking to or from the venue would have great difficulty avoiding any vehicles either in or out. This lane then comes onto a bad bend onto the A4137 where there has in the past been a site of a fatality.

To Prevent Public Nuisance

Local residents and businesses have tolerated the high noise levels during the annual festival. The music can be heard over 2 kms away, local residents are unable to sit in their

gardens and even indoors TV's have to be turned up. Music for a longer period is excessive and a disruptive nuisance.

To Protect Children from Harm
Our Grand children live next door and others visit regularly How are they supposed to sleep and get their rest to be at school next day.

Signed [redacted]
22 July 2020

If you have any queries about this form
are unsure of when the statutory
period ends please contact the
Licensing Helpline on 01432 261761

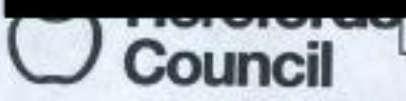

HEREFORDSHIRE COUNCIL
Licensing Act 2003

REPRESENTATION FORM – INTERESTED PARTIES

On making your representation please have regard to the 'Making Representations Guidance Notes' which further explains the process and the information that can be considered by the licensing authority.

When completing this form please print clearly and legibly.

Please return this form, and any additional information within the statutory period to:
**The Licensing Section,
Herefordshire Council,
8 St Owen Street,
Hereford,
HR1 2PJ
licensing@herefordshire.gov.uk**

Your Name: [REDACTED]	Contact Telephone No. [REDACTED]
Address: [REDACTED]	E-mail address: [REDACTED]
	Please state your interest in the premises you are making a representation about: I live in a residential property in close proximity to Gillow Manor and would be greatly affected by the granting of this license.
Name & Address of premises you are making a representation about: Dave Fletecher, Gillow Cider, Gillow Manor, St Owens Cross, Hereford HR2 8LE	

DATA PROTECTION ACT 1998. Please indicate by ticking here if you are not content for your personal details to be circulated as necessary prior to any hearing .

A representation must reflect one or more of the licensing objectives, therefore please write the details of your representation in the relevant boxes below:

<p>To Prevent Crime & Disorder</p> <p>I am of the understanding that the Police have been called to past Gillow Cider Festival events at the above named premises. Multiple Gillow Cider Festival attendees have tried to make access to the event via the private drive way which runs to my property, often intoxicated and displaying anti-social behaviour.</p>
<p>Public Safety</p> <p>Gillow Manor should be accessed via a narrow lane which has no passing places, it also has sharp bends. Access onto the A4137 due to poor visibility creates an accident hot spot. My safety concern is for the residents of numbers 4 and 5 Gillow Cottages who use this narrow lane access both for pedestrian and vehicular access to their properties.</p>
<p>To Prevent Public Nuisance</p> <p>The above named premises has run a Cider Festival for the past few years, this has been a very disruptive event with loud amplified music played late into the night. I have tolerated this event to the best of my ability but last year had to move myself and my two young daughters to my parent's property in North Herefordshire as the loud music prevented my daughters from sleeping and disrupted our family greatly. This was for 2 nights but with the proposed license</p>

wishing to play music seven days a week and to 1am on weekends and bank holidays, I feel this would be very unreasonable and disruptive to family life. Loud music along with the drinking of alcohol on the Gillow Cider site would have a negative impact on not only my family but the surrounding local community. This is a beautiful rural area and I feel the granting of the proposed license would greatly impact on the enjoyment of this.

To Protect Children from Harm

As the mother of two young children (9 and 6) I am concerned about the safety of my children and those family and friends with children who visit us as vehicles trying to access Gillow Cider often try and access Gillow Manor through our property. Vehicles often use our private drive at excessive speeds, thus leaving it unsafe for my children and those visiting to play on our property. On occasion the behaviour and language used by those accessing Gillow Manor via my property has been inappropriate, especially in the presence of children. I believe such a presence of behaviour and language often alcohol fuelled could pose as a safeguarding issue for my children. Sleep deprivation and disruption to family life caused by the playing of music, I feel would be unacceptable as this could be for 7 days a week, all year round and not just as previous Gillow Cider Festivals which I have tolerated. If this license was to be granted I feel it would have a detrimental impact on the enjoyment of living and bringing up a family in this lovely rural location.

Signed:
Date:

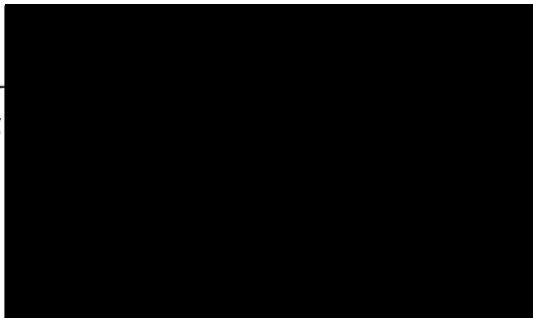

If you have any queries about this form or are unsure of when the statutory period ends please contact the **Licensing Helpline on 01432 261761**

HEREFORDSHIRE COUNCIL
Licensing Act 2003

**REPRESENTATION FORM – INTERESTED
PARTIES**

On making your representation please have regard to the 'Making Representations Guidance Notes' which further explains the process and the information that can be considered by the licensing authority.

When completing this form please print clearly and legibly.

Please return this form, and any additional information within the statutory period to:
**The Licensing Section,
Herefordshire Council,
8 St Owen Street,
Hereford,
HR1 2PJ
licensing@herefordshire.gov.uk**

Your Name: [REDACTED]	Contact Telephone No. [REDACTED]
Address: [REDACTED]	E-mail address: [REDACTED]
	Please state your interest in the premises you are making a representation about: Local Resident
Name & Address of premises you are making a representation about: Gillow Cider, Gillow Manor, St Owens Cross, Hereford, HR2 8LE	

DATA PROTECTION ACT 1998. Please indicate by ticking here if you are not content for your personal details to be circulated as necessary prior to any hearing .

A representation must reflect one or more of the licensing objectives, therefore please write the details of your representation in the relevant boxes below:

To Prevent Crime & Disorder

My comments are based on events in the settlement St Owens Cross, about 500 metres from Gillow Cider. During the Gillow Cider Festival – an annual three day event, there is an increase in anti-social behaviour. Some attendees leave the festival site to wander through St Owens Cross while clearly inebriated. Petty damage and theft result. We have had examples of rough sleeping in our fields where the music can be heard very clearly but people do not want to pay the entry fee. A farming acquaintance has been obliged to employ security staff to chase attendees from their buildings and property. There is nothing to suggest that this behaviour will not be repeated during other outdoor events at Gillow Cider.

Public Safety

Access to the Gillow Cider site is from the A4137 previously identified as the fourth most dangerous road in England. In a recent speed survey for Herefordshire County Council, average road speeds exceeded 52mph in the 40mph limit in St Owens Cross. The Gillow Cider site is accessed just after a blind bend in this road. Cars leaving the site must turn out of the same road. An FOI request shows that the emergency services have attended seven road traffic collisions at this blind bend in the last five years.

Public safety considerations should also extend to their wellbeing and fitness for work. In common with the many agricultural workers in St Owens Cross, I need to be in bed by 9pm in order to get up early. The incessant noise generated at Gillow Cider precludes sleep and leaves workers vulnerable to tiredness and, therefore, making serious errors when working with machinery.

The Gillow Festival website encourages visitors to 'bring a toilet roll'. The inadequacy of toilet provision on the site has resulted in used toilet paper forming part of the increased litter in St Owens Cross after the cider festival.

To Prevent Public Nuisance

The three days of the Gillow Cider Festival are tolerated but not welcomed in St Owens Cross. Gillow Manor is not miles away from habitation; it is less than 500 metres from private dwellings. The noise from live and recorded music, played outside, makes it impossible to enjoy sitting in the garden and having a conversation. Even indoors, the sound level is sufficient to drown out a television at normal volume. The music prevents my enjoyment of my environment. At best, music is played under a canvas marquee that does nothing to reduce sound levels. This music is played late into the night or early morning and is a public nuisance. The application seeks authorisation to make this disturbance possible every day of the year. That cannot be an acceptable situation to the Licensing Authority.

To Protect Children from Harm

Comments above relating to lost sleep and the dangers of increased traffic also, of course, affect our children in the community.

Signed:

Date:

21/7/20

If you have any queries about this form or are unsure of when the statutory period ends please contact the Licensing Helpline on 01432 261761



Representation Form – Interested Parties Suggested Conditions

Premise: Gillow Cider/Gillow Manor Your name: [REDACTED]

It would help us with this application if you could suggest conditions you would be happy for the premise to operate under to rectify the problems you are experiencing.

All suggested conditions shall be considered in line with the Herefordshire Council Licensing Policy, the Licensing Act 2003 and the Licensing Objectives.

To Prevent Crime and Disorder

The applicant has not demonstrated that it is acting responsibly. No security policy or proposals are included with the application. Gillow Cider would need to employ security staff to regulate arrivals and departures from events. Once out of the event, attendees are not under Gillow Cider control, so extra policing will be required in St Owens Cross during events.

Public Safety

The applicant has not demonstrated that it is acting responsibly. No proposals to control access to and from the site have been made by Gillow Cider/Gillow Manor. The application has not been well thought out. Access to and egress from Gillow Cider/Gillow Manor needs to be regulated and a traffic management plan put in place with the Police and Local Authority. This comment applies equally to the movement of large vehicles making home deliveries of Gillow cider, as proposed in the application. A litter collection plan should be instigated by Gillow Cider/Gillow Manor to preserve the cleanliness of St Owens Cross and the surrounding area.

Prevent Public Nuisance

The applicant has not demonstrated that it is acting responsibly. No noise management plan has been submitted with the application. This is indicative of the lack of consideration Gillow Cider/Gillow Manor have for the local community. The noise can be heard over 1.5 kilometres away and is extremely intrusive at 1 kilometre distance from the site. Sound levels should be reduced after 2000 hours and music should cease altogether by 2200 hours except where a specific event can be authorised under the TEN system. No sound mitigation plan has been proposed. Unless the Licensing Authority exercise their powers to severely curtail the proposed music duration and volume, local residents will be contacting the Police and Environmental Health Department to handle their complaints.

Protect Children from Harm

Comments relating to public nuisance and public safety apply equally to the protection of children in the area.

Signed: [REDACTED]

Date: 21/7/20

If you have any queries about this form or are unsure of when the statutory period ends please contact the Licensing Helpline on 01432 261761

HEREFORDSHIRE COUNCIL
Licensing Act 2003

**REPRESENTATION FORM – INTERESTED
PARTIES**

On making your representation please have regard to the 'Making Representations Guidance Notes' which further explains the process and the information that can be considered by the licensing authority.

When completing this form please print clearly and legibly.

Please return this form, and any additional information within the statutory period to:
**The Licensing Section,
Herefordshire Council,
8 St Owen Street,
Hereford,
HR1 2PJ
licensing@herefordshire.gov.uk**

Your Name: [REDACTED]	Contact Telephone No. [REDACTED]
Address: [REDACTED] [REDACTED] [REDACTED] [REDACTED]	E-mail address: [REDACTED] Please state your interest in the premises you are making a representation about: Local Resident
Name & Address of premises you are making a representation about: Gillow Cider, Gillow Manor, St Owens Cross, Hereford, HR2 8LE	

DATA PROTECTION ACT 1998. Please indicate by ticking here if you are not content for your personal details to be circulated as necessary prior to any hearing .

A representation must reflect one or more of the licensing objectives, therefore please write the details of your representation in the relevant boxes below:

To Prevent Crime & Disorder

My comments are based on events in the settlement St Owens Cross, about 500 metres from Gillow Cider. During the Gillow Cider Festival – an annual three day event, there is an increase in anti-social behaviour. Some attendees leave the festival site to wander through St Owens Cross while clearly inebriated. There is an increase in petty damage.. We have had examples of rough sleeping in our fields where the music can be heard very clearly but people do not want to pay the entry fee. A farming acquaintance has been obliged to employ security staff to chase attendees from their buildings and property. There is nothing to suggest that this behaviour will not be repeated during other outdoor events at Gillow Cider.

Public Safety

Access to the Gillow Cider site is from the A4137 previously identified as the fourth most dangerous road in England. In a recent speed survey for Herefordshire County Council, *average* road speeds exceeded 52mph in the 40mph limit in St Owens Cross. The Gillow Cider site is accessed just after a blind bend in this road. Cars leaving the site must turn out of the same road. A Freedom of Information request shows that the emergency services have attended seven road traffic collisions at this blind bend in the last five years, together with many more accidents that the emergency services have not been involved.

Public safety considerations should also extend to their wellbeing and fitness for work. I am on call every 3rd week to maintain the countries Critical National Infrastructure, either remotely or having to drive up to 8 hours to site anywhere in the country, to repair faults. The incessant noise generated at Gillow Cider precludes sleep and leaves residents vulnerable to tiredness and, therefore, making serious errors when working with highly complex sophisticated Telecommunications networks, that in the worse case could lead to a black out of the emergency services communications networks.

The Gillow Festival website encourages visitors to 'bring a toilet roll'. The inadequacy of toilet provision on the site has resulted in used toilet paper forming part of the increased litter in St Owens Cross after the cider festival.

To Prevent Public Nuisance

The three days of the Gillow Cider Festival are tolerated but not welcomed in St Owens Cross. Gillow Manor is not miles away from habitation; it is less than 500 metres from private dwellings. The noise from live and recorded music, played outside, makes it impossible to enjoy sitting in the garden and having a conversation. Even indoors, the sound level is sufficient to drown out a television at normal volume. The music prevents my enjoyment of my environment. At best, music is played under a canvas marquee that does nothing to reduce sound levels. This music is played late into the night or early morning and is a public nuisance. The application seeks authorisation to make this disturbance possible every day of the year. That cannot be an acceptable situation to the Licensing Authority.

To Protect Children from Harm

Comments above relating to lost sleep and the dangers of increased traffic also, of course, affect our children in the community.

Signed: [REDACTED]
Date: 21/07/2020



If you have any queries about this form or are unsure of when the statutory period ends please contact the Licensing Helpline on 01432 261761

Representation Form – Interested Parties Suggested Conditions

Premise: Gillow Cider/Gillow Manor **Your name:**

It would help us with this application if you could suggest conditions you would be happy for the premise to operate under to rectify the problems you are experiencing.

All suggested conditions shall be considered in line with the Herefordshire Council Licensing Policy, the Licensing Act 2003 and the Licensing Objectives.

To Prevent Crime and Disorder

The applicant has not demonstrated that it is acting responsibly. No security policy or proposals are included with the application. Gillow Cider would need to employ security staff to regulate arrivals and departures from events. Once out of the event, attendees are not under Gillow Cider control, so extra policing will be required in St Owens Cross during events.

Public Safety

The applicant has not demonstrated that it is acting responsibly. No proposals to control access to and from the site have been made by Gillow Cider/Gillow Manor. The application has not been well thought out. Access to and egress from Gillow Cider/Gillow Manor needs to be regulated and a traffic management plan put in place with the Police and Local Authority. This comment applies equally to the movement of large vehicles making home deliveries of Gillow cider, as proposed in the application. A litter collection plan should be instigated by Gillow Cider/Gillow Manor to preserve the cleanliness of St Owens Cross and the surrounding area.

Prevent Public Nuisance

The applicant has not demonstrated that it is acting responsibly. No noise management plan has been submitted with the application. This is indicative of the lack of consideration Gillow Cider/Gillow Manor have for the local community. The noise can be heard over 1.5 kilometres away and is extremely intrusive at 1 kilometre distance from the site. Sound levels should be reduced after 2000 hours and music should cease altogether by 2200 hours except where a specific event can be authorised under the TEN system. No sound mitigation plan has been proposed. Unless the Licensing Authority exercise their powers to severely curtail the proposed music duration and volume, local residents will be contacting the Police and Environmental Health Department to handle their complaints.

Protect Children from Harm

Comments relating to public nuisance and public safety apply equally to the protection of children in the area.

Signed:

If you have any queries about this form or are unsure of when the statutory period ends please contact the Licensing Helpline on 01432 261761

Date:

RECEIVED
22 JUL 2020
BY: _____

HEREFORDSHIRE COUNCIL
Licensing Act 2003

Please return this form, and any additional information within the statutory period to:
**The Licensing Section,
Herefordshire Council,
8 St Owen Street,
Hereford,
HR1 2PJ
licensing@herefordshire.gov.uk**

REPRESENTATION FORM – INTERESTED PARTIES

On making your representation please have regard to the 'Making Representations Guidance Notes' which further explains the process and the information that can be considered by the licensing authority.

When completing this form please print clearly and legibly.

Your Name: [REDACTED]	Contact Telephone No. [REDACTED]
Address: [REDACTED]	E-mail address: [REDACTED]
	Please state your interest in the premises you are making a representation about: Local Resident
Name & Address of premises you are making a representation about: Gillow Cider, Gillow Manor, St Owens Cross, Hereford, HR2 8LE	

DATA PROTECTION ACT 1998. Please indicate by ticking here if you are not content for your personal details to be circulated as necessary prior to any hearing .

A representation must reflect one or more of the licensing objectives, therefore please write the details of your representation in the relevant boxes below:

To Prevent Crime & Disorder

My comments are based on events in the settlement St Owens Cross, about 500 metres from Gillow Cider. During the Gillow Cider Festival – an annual three day event, there is an increase in anti-social behaviour. Some attendees leave the festival site to wander through St Owens Cross while clearly inebriated. Petty damage and theft result. We have had examples of rough sleeping in our fields where the music can be heard very clearly but people do not want to pay the entry fee. A farming acquaintance has been obliged to employ security staff to chase attendees from their buildings and property. There is nothing to suggest that this behaviour will not be repeated during other outdoor events at Gillow Cider. Nothing in the application addresses these issues or suggests that they will not be perpetuated.

Public Safety

Access to the Gillow Cider site is from the A4137 previously identified as the fourth most dangerous road in England. In a recent speed survey for Herefordshire County Council, average road speeds exceeded 52mph in the 40mph limit in St Owens Cross. The Gillow Cider site is accessed just after a blind bend in this road. Cars leaving the site must turn out of the same road. An FoI request shows that the emergency services have attended seven road traffic collisions at this blind bend in the last five years.

Public safety considerations should also extend to their wellbeing and fitness for work. In common with the many agricultural workers in St Owens Cross, I need to be in bed by 9pm in order to get up early. The incessant noise generated at Gillow Cider precludes sleep and leaves workers vulnerable to tiredness and, therefore, making serious errors when working with machinery.

The Gillow Festival website encourages visitors to 'bring a toilet roll'. The inadequacy of toilet provision on the site has resulted in used toilet paper forming part of the increased litter in St Owens Cross after the cider festival. Nothing in the application addresses these issues or suggests that they will not be perpetuated.

To Prevent Public Nuisance

The three days of the Gillow Cider Festival are tolerated but not welcomed in St Owens Cross. Gillow Manor is not miles away from habitation; it is less than 500 metres from private dwellings. The noise from live and recorded music, played outside, makes it impossible to enjoy sitting in the garden and having a conversation. Even indoors, the sound level is sufficient to drown out a television at normal volume. The music prevents my enjoyment of my environment. At best, music is played under a canvas marquee that does nothing to reduce sound levels. This music is played late into the night or early morning and is a public nuisance. The application seeks authorisation to make this disturbance possible every day of the year. That cannot be an acceptable situation to the Licensing Authority. Nothing in the application addresses these issues or suggests that they will not be perpetuated.

To Protect Children from Harm

Comments above relating to lost sleep and the dangers of increased traffic also, of course, affect our children in the community.

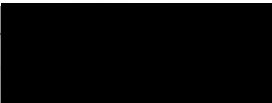
Signed: 

Date: 21-07-2020

If you have any queries about this form or are unsure of when the statutory period ends please contact the Licensing Helpline on 01432 261761



Representation Form – Interested Parties Suggested Conditions

Premise: Gillow Cider/Gillow Manor Your name: [REDACTED]

It would help us with this application if you could suggest conditions you would be happy for the premise to operate under to rectify the problems you are experiencing.

All suggested conditions shall be considered in line with the Herefordshire Council Licensing Policy, the Licensing Act 2003 and the Licensing Objectives.

To Prevent Crime and Disorder

The applicant has not demonstrated that it is acting responsibly. No security policy or proposals are included with the application. Gillow Cider would need to employ security staff to regulate arrivals and departures from events. Once out of the event, attendees are not under Gillow Cider control, so extra policing will be required in St Owens Cross during events.

Public Safety

The applicant has not demonstrated that it is acting responsibly. No proposals to control access to and from the site have been made by Gillow Cider/Gillow Manor. The application has not been well thought out. Access to and egress from Gillow Cider/Gillow Manor needs to be regulated and a traffic management plan put in place with the Police and Local Authority. This comment applies equally to the movement of large vehicles making home deliveries of Gillow cider, as proposed in the application. A litter collection plan should be instigated by Gillow Cider/Gillow Manor to preserve the cleanliness of St Owens Cross and the surrounding area.

Prevent Public Nuisance

The applicant has not demonstrated that it is acting responsibly. No noise management plan has been submitted with the application. This is indicative of the lack of consideration Gillow Cider/Gillow Manor have for the local community. The noise can be heard over 1.5 kilometres away and is extremely intrusive at 1 kilometre distance from the site. Sound levels should be reduced after 2000 hours and music should cease altogether by 2200 hours except where a specific event can be authorised under the TEN system. No sound mitigation plan has been proposed. Unless the Licensing Authority exercise their powers to severely curtail the proposed music duration and volume, local residents will be contacting the Police and Environmental Health Department to handle their complaints.

Protect Children from Harm

Comments relating to public nuisance and public safety apply equally to the protection of children in the area.

Signed: [REDACTED]

Date: 21-07-2020

If you have any queries about this form or are unsure of when the statutory period ends please contact the Licensing Helpline on 01432 261761

HEREFORDSHIRE COUNCIL
Licensing Act 2003

REPRESENTATION FORM – INTERESTED
PARTIES

On making your representation please have regard to the 'Making Representations Guidance Notes' which further explains the process and the information that can be considered by the licensing authority.

When completing this form please print clearly and legibly.

Please return this form, and any additional information within the statutory period to:
The Licensing Section,
Herefordshire Council,
8 St Owen Street,
Hereford,
HR1 2PJ
licensing@herefordshire.gov.uk

Your Name: ██████████	Contact Telephone No. ██████████
Address: ██████████ ██████████ ██████████ ██████████	E-mail address: ██████████
	Please state your interest in the premises you are making a representation about: Local Resident – the hamlet of Michaelchurch
Name & Address of premises you are making a representation about: David Stuart FLETCHER Gillow Manor; St Owen's Cross; Hereford HR2 8LE	

DATA PROTECTION ACT 1998. Please indicate by ticking here if you are not content for your personal details to be circulated as necessary prior to any hearing .

A representation must reflect one or more of the licensing objectives, therefore please write the details of your representation in the relevant boxes below:

BACKGROUND TO COMMENTS BELOW.

The Gillow 'Music Festival' has been running for some years now and on the basis that this was a once-a-year event, we have managed to rub along with the increased noise, traffic and general presence and disruption to a normally secluded, deeply rural location. The application sought would allow such events to be run constantly through the year. This is unacceptable.

The event is attended by visitors from far afield. Herefordshire residents find tackling our narrow, unmarked lane challenging and those from further away are even less skilled or comfortable in these conditions.

To Prevent Crime & Disorder

Each year the festival has been held, the organisers have placed bill posters all over Herefordshire. These are not removed after the event by the organisers leaving tatty signs on boards, lamp-posts, road signs and elsewhere that eventually rot away or have to be collected at public expense by Balfour Beatty on behalf of Herefordshire Council.

Public Safety

The lane to Gillow Manor is a single-track lane, with 3 passing places along it's approx 1/2 mile length to the Manor driveway from the A4137. These passing places are unmarked, natural let-ins along the route. At the main road end there are several sharp bends. Local residents know the road and will normally reverse when they know they are closest to a passing area. When visitors to the Manor descend for Festival and other events, they are quite unused to the road conditions; they are either incapable of reversing or simply too lazy.

Visitors unused to the conditions tend to be travelling at an inappropriate speed.

The lane is used by local residents and farm vehicles – often towing. Their progress is limited or stopped by traffic to the Manor during events.

The turning into Gillow Lane, is from the A4137 shortly before it joins the A49. Accidents on this stretch of road, with adverse camber, tricky bends and speeding traffic are constant. The turning is very small, with room for only one vehicle and it is unmarked. This is not a suitable access route for event traffic nor for large numbers of visitors wishing to purchase cider.

Local residents and families frequently walk along the lane – enjoying the quiet location and pleasant views as part of local circular walks. Extra traffic unused to the conditions makes this a dangerous occupation.

To Prevent Public Nuisance

The noise from Gillow Music Festival is constant throughout the weekend and loud enough in my garden to overpower the sound of birdsong. This noise from continues long after the 1am close time which in all events is far too late to be reasonable for surrounding households.

The licence applied for seeks permission for such events to be run every weekend and for weekdays on an only slightly shorter time limit.

So disturbing is the sound from the annual event that I normally seek to be away for the weekend, and I understand that others do likewise. We cannot be forced to exit our homes constantly to avoid the intrusion of a late night business in an entirely unsuitable location.

To Protect Children from Harm

Extra traffic traveling the lane at unsuitable speeds is a danger to children and families who regularly walk along the lane as part of local walks.

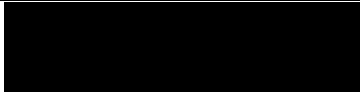
Signed 
Date: 16 July 2020

If you have any queries about this form or are unsure of when the statutory period ends please contact the **Licensing Helpline** on **01432 261761**



Representation Form – Interested Parties Suggested Conditions

Premise: Michaelchurch Cottage Your name: 

It would help us with this application if you could suggest conditions you would be happy for the premise to operate under to rectify the problems you are experiencing.

All suggested conditions shall be considered in line with the Herefordshire Council Licensing Policy, the Licensing Act 2003 and the Licensing Objectives.

To Prevent Crime and Disorder

Mandatory and monitored removal of all posters around the County (and beyond) with heavy fines for failure to comply.

Public Safety

The access is so entirely unsuited to this sort of use an alternative access would be necessary.

Prevent Public Nuisance

Protect Children from Harm

Signed 

Date: 16 July 2020

If you have any queries about this form or are unsure of when the statutory period ends please contact the **Licensing Helpline** on **01432 261761**

Please return this form, and any additional information within the statutory period to:
**The Licensing Section,
 Herefordshire Council,
 8 St Owen Street,
 Hereford,
 HR1 2PJ**
 licensing@herefordshire.gov.uk

HEREFORDSHIRE COUNCIL
 Licensing Act 2003

RECEIVED
 15 JUL 2020
 BY:

REPRESENTATION FORM – INTERESTED PARTIES

On making your representation please have regard to the 'Making Representations Guidance Notes' which further explains the process and the information that can be considered by the licensing authority.

When completing this form please print clearly and legibly.

Your Name:	Contact Telephone No
Address:	From address
	are making a representation about: eg local resident/local business Local resident
Name & Address of premises you are making a representation about: David Fletcher Gillow manor St. Owens cross, Hereford HR2 8LE	

DATA PROTECTION ACT 1998. Please indicate by ticking here if you are not content for your personal details to be circulated as necessary prior to any hearing .

A representation must reflect one or more of the licensing objectives, therefore please write the details of your representation in the relevant boxes below:

To Prevent Crime & Disorder
Public Safety
To Prevent Public Nuisance
To Protect Children from Harm

with Ross-on-wye 5 miles away. Hereford 10 and mammoth 9 this would create alot of traffic down narrow country lanes and alot of people walking on already high fatality roads

Signature
 Date

If you have any queries about this form or are unsure of when the statutory period ends please contact the Licensing Helpline on 01432 261761

**Representation Form – Interested Parties
Suggested Conditions**

Premise: _____ Your name: _____

It would help us with this application if you could suggest conditions you would be happy for the premise to operate under to rectify the problems you are experiencing.

All suggested conditions shall be considered in line with the Herefordshire Council Licensing Policy, the Licensing Act 2003 and the Licensing Objectives.

To Prevent Crime and Disorder

Drinking and Driving to and from Venue

Public Safety

Single Access on Country lanes and Access onto A4137 and A49

Prevent Public Nuisance

mentioned below

Protect Children from Harm



Signed: _____

Date: 13/7/20

1
ELI REPRES - 1 Representation Form – Interested Parties

If you have any queries about this form or are unsure of when the statutory period ends please contact the Licensing Helpline on 01432 261761

with reference to the Application at Gillow Manor for a licence to sell Alcohol and use premises for camping as stated. We have not seen any evidence of planning for a shower & toilet block which has recently been erected.

The entrance off the busy main road (4137) which is always already a accident hot spot, and then into a narrow long single track lane with no passing places down to Gillow Manor is totally not viable.

The lane is used by the few residents i.e. postman and deliveries due to its location in the country so to have a busy (nightclub!) with loud noise and music at all hours is incomprehensible.

The last public gathering held at Gillow Manor we were woken at 4.0 clock in the morning by a person that had attended it walking around our property and when approached said he was trying to get to crossway but was very incoherent and obviously under the influence of something! he proceeded to walk the main road.

HEREFORDSHIRE COUNCIL
Licensing Act 2003

REPRESENTATION FORM – INTERESTED PARTIES

On making your representation please have regard to the 'Making Representations Guidance Notes' which further explains the process and the information that can be considered by the licensing authority.

When completing this form please print clearly and legibly.

Please return this form, and any additional information within the statutory period to:
The Licensing Section,
Herefordshire Council,
8 St Owen Street,
Hereford,
HR1 2PJ
licensing@herefordshire.gov.uk

[Redacted]	[Redacted]
[Redacted]	Please state your interest in the premises you are making a representation I am a very close neighbour of Gillow Manor. I would be greatly affected by this licensing application. <small>resident/local business</small>
Name & Address of premises you are making a representation about:	
MR. D. Fletcher Gillow Manor/Gillow Cider St. Owens Cross Hereford HR2 8LE	

DATA PROTECTION ACT 1998. Please indicate by ticking here if you are not content for your personal details to be circulated as necessary prior to any hearing.

A representation must reflect one or more of the licensing objectives, therefore please write the details of your representation in the relevant boxes below:

To Prevent Crime & Disorder

Drinking alcohol to excess can lead to fighting and other undesirable behaviour. I believe the police have been called to cider festival in the past. In such a remote rural area if there was a problem it could take a long time for the emergency services to arrive.

Public Safety

Gillow Manor is accessed down a very narrow lane, which has very few passing places. This lane is accessed off the A4137 off a sweeping corner which has a history of accidents; I know this because my parents used to live on this junction. During the cider festival I have cars trying to access the festival, using my private farm drive which they have no right.

To Prevent Public Nuisance

The consumption of alcohol on site together with loud music would cause a large effect on the local area. We have tolerated the loud music during the annual cider festival but for the music to be played for seven days a week until up to 1am is totally unreasonable. The noise carries for well over a mile plus. To want to play music at such high noise levels for such a long period is excessive. We are unable to sleep properly even with double glazing during the festival so life would be impossible if the application was even 25% successful

To Protect Children from Harm

Two of my grandchildren live next door and the others visit regularly. As I have described above strangers cars try to access Gillow Manor by trying to drive through down our private drive sometimes at excessive speed. Also noise how are children supposed to sleep and get their rest with the loud music till late. Any children walking down the narrow lane to or from Gillow Manor would be in great danger of a collision with a car. Just a thought what is the possibility of underage drinking because this is a remote rural area?

Signed:

Date:

[Redacted Signature]

20/01/20

If you have any queries about this form or are unsure of when the statutory period ends please contact the Licensing Helpline on 01432 281761



Herefordshire Council

Form – Interested Parties Suggested

Conditions

Premise: _____ **Your name:** _____

It would help us with this application if you could suggest conditions you would be happy for the premise to operate under to rectify the problems you are experiencing.

All suggested conditions shall be considered in line with the Herefordshire Council Licensing Policy, the Licensing Act 2003 and the Licensing Objectives.

HEREFORDSHIRE COUNCIL
Licensing Act 2003

REPRESENTATION FORM – INTERESTED PARTIES

On making your representation please have regard to the 'Making Representations Guidance Notes' which further explains the process and the information that can be considered by the licensing authority.

When completing this form please print clearly and legibly.

Please return this form, and any additional information within the statutory period to:
**The Licensing Section,
Herefordshire Council,
8 St Owen Street,
Hereford,
HR1 2PJ
licensing@herefordshire.gov.uk**

Your Name: [REDACTED]	Contact Telephone No. [REDACTED]
Address: [REDACTED]	E-mail address: [REDACTED]
	Please state your interest in the premises you are making a representation about: I am a close resident and business owner to Gillow Manor. I would be greatly affected by the granting of this license.
Name & Address of premises you are making a representation about: Dave Fletcher, Gillow Cider, Gillow Manor, St Owens Cross, Hereford, HR2 8LE	

DATA PROTECTION ACT 1998. Please indicate by ticking here if you are not content for your personal details to be circulated as necessary prior to any hearing .

A representation must reflect one or more of the licensing objectives, therefore please write the details of your representation in the relevant boxes below:

To Prevent Crime & Disorder

I believe the Police have been called to past cider festival events that have been held, by Gillow Cider. We have had to employ security to protect our property and prevent theft or damage during the festival, we have had intoxicated people entering our premise. We have had to deal with anti-social people trying to get into and from the festival using our private access.

Public Safety

The correct access to Gillow Manor is along a narrow lane, with sharp bends and no passing places. The access onto the A4137 is at an accident trouble spot with poor visibility. I am concerned for the safety for the residents of Gillow Cottage 4 and 5, as they travel along this lane by foot and vehicle to access their property.

To Prevent Public Nuisance

We have tolerated the annual festival for the last few years with loud music played late at night that we are unable to sleep, but with application to be able to

play seven days a week and up to 1am is completely unreasonable. The drinking of alcohol on site along with loud music would cause a big impact on the local community. Our enjoyment of this beautifully rural area would be greatly impacted by this application.

To Protect Children from Harm

I have two young children (9 and 6) and we have friends with children visiting regularly. I have cars trying to access Gillow Manor through our property, many of which drive at excessive speeds, leaving it unsafe for our children to play on our own property. My children are unable to sleep during the festival due to the excessive noise, if the license were to be granted this could be every night of the week all year round. This license application would severely impact our family life and the upbringing of our children in a beautiful rural location.

Signed:

Date:

20/7/2020

If you have any queries about this form or are unsure of when the statutory period ends please contact the Licensing Helpline on 01432 261761

HEREFORDSHIRE COUNCIL
Licensing Act 2003

REPRESENTATION FORM – INTERESTED PARTIES

On making your representation please have regard to the 'Making Representations Guidance Notes' which further explains the process and the information that can be considered by the licensing authority.

When completing this form please print clearly and legibly.

Please return this form, and any additional information within the statutory period to:
The Licensing Section,
Herefordshire Council,
8 St Owen Street,
Hereford,
HR1 2PJ
licensing@herefordshire.gov.uk

Your Name: [REDACTED]	Contact Telephone No. [REDACTED]
Address: [REDACTED] [REDACTED] [REDACTED] [REDACTED]	E-mail address: [REDACTED]
Please state your interest in the premises you are making a representation about: Local Resident/business	
Name & Address of premises you are making a representation about: Gillow Cider, Gillow Manor, St. Owens Cross, Hereford HR2 8LE	

DATA PROTECTION ACT 1998. Please indicate by ticking here if you are not content for your personal details to be circulated as necessary prior to any hearing .

A representation must reflect one or more of the licensing objectives, therefore please write the details of your representation in the relevant boxes below:

To Prevent Crime & Disorder See comments under Public Nuisance and emails.
Public Safety We note from the application plan that there are two buildings referred to. Although we are uncertain as to exactly when these were constructed, we have searched the planning applications from 2006 to 2020 and can find no applications listed for Gillow Manor which would have allowed these to be built. If, in fact, these had no planning approval, then it is entirely possible that they have not been inspected for compliance with building and safety regulations and this should be investigated by the planning authority prior to any determination.
To Prevent Public Nuisance We have previously complained about excessive noise levels from the annual Cider Festival (see attached emails). We now have to go away, on that weekend and any weekend that there is a wedding party there, in order to get some sleep, returning in the daytime to work. Granting of such a permanent licence for every day of the year and later on every weekend/ bank holiday and Sundays prior to bank holidays, together with the other specific occasions mentioned will have a devastating effect on the local area and residents. The noise and drunken behaviour of the festival/party goers is intolerable and the events always exceed any time constraints stipulated, so these factors are obviously not policed by the owners. It states in the application that live music will be both inside and out. We are aware that all previous events have included a large marquee with music and entertainment, so obviously the sound cannot be contained and carries a long distance, particularly at night. In addition to the venue, there is also an adjacent field which is used as a campsite. This has the effect of prolonging the activities even later as the people do not have to leave the venue by a certain time, unlike public houses and village halls for

example.

In addition to this, the constant additional traffic on very small roads to access the venue has and will cause a frequent nuisance and danger to local residents. As you will note from our emails, we have experienced a violent threat on our own property from a festival goer, even before the event had begun.

We have for the past 15 years held a number of caravan rallies on our property throughout the year, but following complaints from the caravanners about the noise level late at night coming from Gillow Cider, we now have to avoid booking any rallies at the same time as the festival weekend. In the future, we would not know when any events with live or recorded music are taking place, and so could not necessarily avoid them. We fear this will destroy our successful business, as people come here to enjoy the peace and quiet of the Herefordshire countryside, which we have previously been able to afford them.

As mentioned in our emails, this is a rural community and consequently, many residents are employed in agriculture, which is not a 9 – 5 job and is not confined to weekdays, so those people need to work every day of the week and should not be frequently disturbed with loud music. We feel such licensing would be detrimental to the unspoilt area and environment.

To Protect Children from Harm

N/A

Signed: 

Date: 06.07.2020



Representation Form – Interested Parties Suggested Conditions

Premise: Gillow Manor Your name: [REDACTED]

It would help us with this application if you could suggest conditions you would be happy for the premise to operate under to rectify the problems you are experiencing.

All suggested conditions shall be considered in line with the Herefordshire Council Licensing Policy, the Licensing Act 2003 and the Licensing Objectives.

To Prevent Crime and Disorder See below
Public Safety
Prevent Public Nuisance The new licensing as described in the application should not be granted. However, we do not have a problem with them selling alcohol to the public in the daytime and their online delivery business.
Protect Children from Harm N/A

Signed: [REDACTED]
Date: 06.07.2020

Re: Noise Nuisance at Gillow Farm, St. Owens Cross

[REDACTED]
Mon 25/06/2018 20:30

To: Ethelpline <ethelpline@herefordshire.gov.uk>

Following our initial complaint, we did receive a phone message from someone in the department, but due to work commitments, we were unable to get back to them in office hours. We did, however, try twice during last week, but there was only a voice mail.

We have now **suffered** the three night Cider Festival (which is really a disguise for a 'Music Festival'). On every night and noise went on way beyond the advertised times. We did try to contact the owners, but there was always an answerphone on! We are aware that many other local people are not happy with this situation, particularly going into a third night and a **Sunday night**. There was also a church service at the nearby Michaelchurch, redundant church, which only happens once a year, and the music was playing loudly throughout this. We have had a caravan rally on our field during the last week, as we do from time to time throughout the season, and some of those who were due to leave today, went on Saturday, following the Friday night festival. This, of course, had an impact on our income for this rally and it may mean that they are put off from coming again. Our visitors spend considerable amounts of money in the local area whilst they are here, on food and days out.

In addition to this, on Saturday afternoon, 'festival goers' in a vehicle came onto our property to turn round and when we asked them what they were doing, we were told it was none of our business and then we were subjected to verbal abuse and swearing. We know that they were going to the festival because we then observed them turn into the site.

Once again, we would ask you to investigate this event, as to its suitability to be held at this venue, given the high level of noise which comes from it in a working rural area. We belong to various organisations and when we attend events which involve outdoor activities or in, say, a village hall, we are always mindful of the surrounding area and the impact this may have on residents. In the case of village halls, barn venues etc., we are bound by their rules as to finishing times, and abide by them! There does not seem to be any policing of these types of festivals although they **must surely** have been given strict finishing times by the Local Authority. If these rules are not enforced, then the event will only get bigger and cause even more of a nuisance as the years go by.

[REDACTED]

From: Ethelpline <ethelpline@herefordshire.gov.uk>

Sent: 29 May 2018 10:10

[REDACTED]
Subject: RE: Noise Nuisance

[REDACTED]

<https://outlook.live.com/mail/search/id/AOMkADAwATY0MDABLW13NmEtNmFh...> 26/06/2020

Thank you for your email.

I am passing it on to the duty officer for the noise team. Please email a contact telephone number so that he can discuss the matter with you in more detail.



Sent: 28 May 2018 20:31
To: Ethelpline <ethelpline@herefordshire.gov.uk>
Subject: MBO. Noise Nuisance

We are contacting you to complain about the noise nuisance from loud music after 11.00p.m. at The Gillow Farm, St. Owens Cross, Hereford.

As you be aware, there has been for the last couple of years a Cider Festival at this venue over a three day period. The weekend this year is scheduled for 22-25 June. The marquees are already at the venue and on Saturday 26 May 2018 we believe there was a wedding reception held there. We contacted the owner at 10.30p.m. that evening as there had been loud music coming from the venue most of the afternoon and all evening. We were told it was a wedding and would finish at 1.00p.m.

As we are only about a quarter of a mile from the venue, we can hear the music, even with all the windows closed, making it impossible to sleep until after it stops.

Although we appreciate that all necessary licences etc. may have been sought from the Council to hold this event and the Cider Festival in June, we are very concerned about the level of noise that will ensue over the three day period late at night and early hours of the morning. In particular, on looking at various websites on the subject, the ending time of each night seems to vary between 11.00p.m. and 1.00a.m., depending on which website you visit. This means that potentially, and in our experience, most likely, on all three nights, Friday, Saturday and Sunday, the events will not finish until at least 1.00p.m. This appears to be an event which is getting larger each year, borne out by the longer list of groups playing over that period. It is fast becoming a 'mini Glastonbury'!

As we are part of the farming community, we do not have the luxury of having a lie-in the following morning, to make up for the lost sleep at the beginning of the night, as we do not have a 'weekend' or 'day off' when there isn't work to do first thing the next morning.

Can you please, therefore, look into this situation and ensure that the time constraints which, presumably, have been put in place are enforced. We realise that people wish to enjoy the event, but feel that excessive noise after 11.00p.m., particularly on Sunday/Monday is not something which should be allowed. The Gillow Farm website boasts that people can come and enjoy the 'unspoilt' countryside of Herefordshire over this weekend - well it was unspoilt before this type of event started taking place.

HEREFORDSHIRE COUNCIL
Licensing Act 2003

**REPRESENTATION FORM – INTERESTED
PARTIES**

Please return this form, and any additional information within the statutory period to:
**The Licensing Section,
Herefordshire Council,
8 St Owen Street,
Hereford,
HR1 2PJ
licensing@herefordshire.gov.uk**

On making your representation please have regard to the 'Making Representations Guidance Notes' which further explains the process and the information that can be considered by the licensing authority.

When completing this form please print clearly and legibly.

Your Name: [REDACTED]	Contact Telephone No.0 [REDACTED]
Address: [REDACTED] [REDACTED].	E-mail address: [REDACTED]
	Please state your interest in the premises you are making a representation about: Local resident
Name & Address of premises you are making a representation about: Gillow Manor, St Owens Cross. (Gillow Coder)	

DATA PROTECTION ACT 1998. Please indicate by ticking here ...X.. if you are not content for your personal details to be circulated as necessary prior to any hearing .

A representation must reflect one or more of the licensing objectives, therefore please write the details of your representation in the relevant boxes below:

To Prevent Crime & Disorder
Public Safety If more events are staged at the premises it will increase the volume of traffic in the village. Sat nav's will not necessarily take people the route the organiser anticipates. I currently walk along the B4521 with my dogs, I've lost track of how many times I've nearly been hit by a car.
To Prevent Public Nuisance The current festival can easily be heard from my property. The noise level and its duration disrupts my entire weekend, particularly robbing me of sleep. During the summer months, most people sleep with a window open, its impossible not to hear the festival. I would strongly be against any more live or recorded music coming from this premises. The B4521 is also used as an alternative route when there is an accident or roadworks nearby. This is additional noise in our village, usually during the night. From my property I also hear music from (presumably) the Red Lion Pub. Then there is the constant drone of the bio digester over the road. People move to the country side for peace and quiet.

To Protect Children from Harm

Signed: [redacted] 20.07.2020
Date:



If you have any queries about this form or are unsure of when the statutory period ends please contact the Licensing Helpline on 01432 261761

Representation Form – Interested Parties Suggested Conditions

Premise: _____ Your name: _____

It would help us with this application if you could suggest conditions you would be happy for the premise to operate under to rectify the problems you are experiencing.

All suggested conditions shall be considered in line with the Herefordshire Council Licensing Policy, the Licensing Act 2003 and the Licensing Objectives.

To Prevent Crime and Disorder
Public Safety
Prevent Public Nuisance
Protect Children from Harm

[Empty rectangular box for signature]

Signed:

Date:

If you have any queries about this form or are unsure of when the statutory period ends please contact the **Licensing Helpline on 01432 261761**

HEREFORDSHIRE COUNCIL
Licensing Act 2003

**REPRESENTATION FORM – INTERESTED
PARTIES**

On making your representation please have regard to the 'Making Representations Guidance Notes', which further explains the process and the information that can be considered by the licensing authority.

When completing this form please print clearly and legibly.

Please return this form, and any additional information within the statutory period to:
**The Licensing Section,
Herefordshire Council,
8 St Owen Street,
Hereford,
HR1 2PJ
licensing@herefordshire.gov.uk**

Your Name: [REDACTED]	Contact Telephone No. [REDACTED]
Address: [REDACTED] [REDACTED] [REDACTED] [REDACTED]	E-mail address: [REDACTED]
	Please state your interest in the premises you are making a representation about: Residents in neighbouring property
Name & Address of premises you are making a representation about: Gillow Cider Gillow Manor St Owen's Cross HR2 8LE	

DATA PROTECTION ACT 1998. Please indicate by ticking here if you are not content for your personal details to be circulated as necessary prior to any hearing .

A representation must reflect one or more of the licensing objectives, therefore please write the details of your representation in the relevant boxes below:

To Prevent Crime & Disorder

Given that **no other venues** serving alcohol in the local area are open as late as the proposed timings for this venue (until 1am on weekends), we are concerned that it could attract customers late at night from other pubs in the area, giving rise to the potential for disorderly or anti-social behaviour both at and around the venue (including close to our house).

Public Safety

The significant increase in traffic on the route from the A4137 to Gillow manor would pose a risk of a rise in road traffic accidents and congestion.

The junction at the usual route to Gillow Manor from the A4137 requires people to cue on this busy road if a vehicle is trying to exit the lane, which is an unclassified single-track lane with only two passing places.

The junction from the unclassified lane onto the private road to Gillow manor is a blind junction whether turning in or out of the road to Gillow manor.

To Prevent Public Nuisance

We object to the licensing application on Public Nuisance grounds for two primary reasons: (1) noise from vehicles attending the venue and (2) noise and light pollution emanating from the venue and events held there.

The proposed licencing conditions would permit regular events such as music festivals, wedding receptions, or other parties on any day of the year. We do not feel this is necessary or reasonable given the proposed activities (a taproom and once-annual festival).

(1) All vehicles visiting the proposed venue would drive directly past our house, which has bedroom windows overlooking a small lane. For context, this house (where we have lived for 35 years) is in an extremely quiet area of rural Herefordshire with almost no traffic. The only vehicles using the access road to Gillow Manor are normally Gillow Manor residents and their guests. The traffic noise to the proposed venue – which according to this licence application would be from 8am – 11pm every day, and 8am – 1am on Saturdays, bank holidays, and other occasions - would therefore be extremely disruptive. Additionally, the lane to reach the proposed venue is single track, with the only passing or turning place directly outside our house or on our own driveway, which will cause further noise and nuisance.

(2) [REDACTED]. Any noise from Gillow Manor (vehicles, music, people) is easily heard in our garden and we know from previous years that music played outside or in a tent at this location can be heard **inside** our house even with doors and windows closed. Commercial lighting solutions (e.g. for a large event) can also be seen from our property.

While the current annual festival causes public nuisance due to the above, its infrequency means that we can plan to be absent during this one weekend. This is how we have managed the nuisance from the noise and traffic in previous

years. However, this would not be possible if events were held more regularly.

Under the conditions of the proposed licence, the currently annual Cider Festival could be held every day. We see no reason why the annual cider festival cannot continue under a Temporary Event Notice, with a separate licensing application **under more limited conditions (see below)** for a taproom or similar venue.

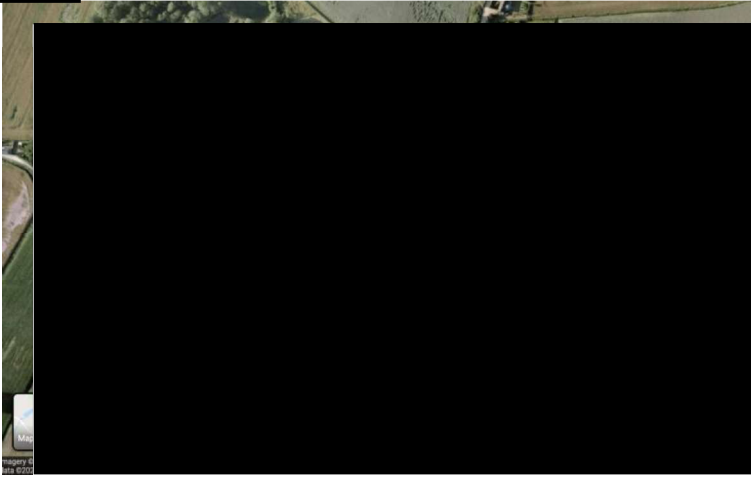

To Protect Children from Harm

Signed:

Date:

[Redacted Signature]

19th July 2020

If you have any queries about this form or are unsure of when the statutory period ends please contact the **Licensing Helpline** on **01432 261761**



Representation Form – Interested Parties Suggested Conditions

Premise: Gillow Manor_: [REDACTED]_____

It would help us with this application if you could suggest conditions you would be happy for the premise to operate under to rectify the problems you are experiencing.

All suggested conditions shall be considered in line with the Herefordshire Council Licensing Policy, the Licensing Act 2003 and the Licensing Objectives.

To Prevent Crime and Disorder

We **do not** feel that any licence should be granted that exceeds the hours of other pubs in the area (for example, the Harewood End Inn or Red Lion), except on an ad hoc basis (e.g. 2-3 times per year).

See below for suggested hours of operation.

Public Safety

We do not feel there are any ways to ameliorate the hazards of a significant rise in traffic to Gillow Manor that granting this licence would cause.

Prevent Public Nuisance

In our view, a licence for a regularized venue (e.g. a taproom or regular events) would **only** be reasonable if the following conditions are met:

- The venue only operates for a limited period of time during the day; we would suggest 11am-9pm, and **only** at weekends and bank holidays. While still highly disruptive to the quiet character of the area, this will at least limit the impact of traffic noise on our daily lives.
- The taproom venue is primarily indoors, with no music permitted outdoors or in a temporary structure such as a marquee or open barn. This is because any music played outdoors will be heard at neighbouring properties including our own.

We would accept that the annual Cider Festival Event could still continue under a Temporary Event Notice, and we would accept that an event such as this or similar (e.g. a wedding reception or party) could take place for a maximum of 2-3 occasion per year.

This would limit the public nuisance to only a few occasions per year.
We raise no objection to Gillow cider growing its business by continuing to sell cider to other retail outlets, at local food fairs or through expanding their off Sales via Internet, Mail Order, or telephone with additional Home Delivery Service.

Protect Children from Harm

Signed: [REDACTED]

Date: 19th July 2020

If you have any queries about this form or are unsure of when the statutory period ends please contact the **Licensing Helpline** on **01432 261761**

Your Name:	Contact Telephone No. [REDACTED]
Address:	E-mail address: [REDACTED]
	Please state your interest in the premises you are making a representation about: eg local local Resident.
Name & Address of premises you are making a representation about: Gillow Cider, Gillow Manor, St Oves Cross, Hereford, HR2 8LE	

DATA PROTECTION ACT 1998. Please indicate by ticking here if you are not content for your personal details to be circulated as necessary prior to any hearing.

A representation must reflect one or more of the licensing objectives, therefore please write the details of your representation in the relevant boxes below:

To Prevent Crime & Disorder
Public Safety
To Prevent Public Nuisance <input checked="" type="checkbox"/>
To Protect Children from Harm

When Gillow farm has had it's festivals in previous years, the noise has been very loud late into the night. We are fine with it happening once a year but not regularly. We have small children who were woken by it.

Signed:
Date:

If you have any queries about this form or are unsure of when the statutory period ends, please contact the Licensing Helpline on 01432 261761



**HEREFORDSHIRE COUNCIL
Licensing Act 2003**

**REPRESENTATION FORM – INTERESTED
PARTIES**

On making your representation please have regard to the 'Making Representations Guidance Notes' which further explains the process and the information that can be considered by the licensing authority.

When completing this form please print clearly and legibly.

Please return this form, and any additional information within the statutory period to:
**The Licensing Section,
Herefordshire Council,
8 St Owen Street,
Hereford,
HR1 2PJ
licensing@herefordshire.gov.uk**

Your Name: Llanwarne and District Group Parish Council, [REDACTED]	Contact Telephone No. [REDACTED]
Address: [REDACTED] [REDACTED]	E-mail address: [REDACTED]
Please state your interest in the premises you are making a representation about: Local Parish Council responding on behalf of local Parishioners who have raised concerns about the license application	
Name & Address of premises you are making a representation about: Gillow Manor, St Owens Cross, Hereford HR2 8LE	

DATA PROTECTION ACT 1998. Please indicate by ticking here if you are not content for your personal details to be circulated as necessary prior to any hearing .

A representation must reflect one or more of the licensing objectives, therefore please write the details of your representation in the relevant boxes below:

<p>To Prevent Crime & Disorder</p> <ul style="list-style-type: none"> • When the Cider Festival has taken place over a weekend in June, there has been evidence of anti social behaviour by attendees. The Police have been called in the past to deal with anti social behaviour issues at the Festival and some has then spilled out to neighbouring premises. • Local residents' premises or businesses have suffered due to anti social behaviour, resulting in damage to, and theft from, neighbouring premises. The local farm/agricultural contractor has employed security guards during the Festival weekend to deal with the anti social behaviour and theft. • There is no access to public transport or taxi services and parishioners suspect this has resulted in festival visitors drinking and driving. • Drug paraphernalia has been found in the area by local residents after the festival event, which raises suspicion of illegal drug misuse at the applicant's site.
<p>Public Safety</p> <ul style="list-style-type: none"> • Poor visibility at the access junction off the A4137 (or B4521) main road on to the narrow lane. This road is the main route linking A49 to the A40 with heavy goods vehicles as well as smaller vehicles. The junction has had numerous accidents happen here. • The lanes leading from the main road are narrow, no passing places to accommodate 2 way traffic, road suffers with potholes due to flooding and water run off during winter months. The junction and lanes are not lit. • Human faeces and drug paraphernalia found in surrounding fields and hedgerows.
<p>To Prevent Public Nuisance</p> <ul style="list-style-type: none"> • During the festival local residents and surrounding neighbourhoods can hear the loud

Representation Form – Interested Parties Suggested Conditions

Premise: Gillow Manor Your name: [REDACTED]

It would help us with this application if you could suggest conditions you would be happy for the premise to operate under to rectify the problems you are experiencing.

All suggested conditions shall be considered in line with the Herefordshire Council Licensing Policy, the Licensing Act 2003 and the Licensing Objectives.

To Prevent Crime and Disorder

- To hold a licence for only production and sale of alcohol to the public only. This would reduce amount of people attending at one time (ie a festival), reduce noise pollution from music, vehicles and people and anti social behaviour

Public Safety

- To look at ways to directing traffic to eliminate the potential congestion of traffic on narrow country lanes
- Improve visibility of access of the A4137 main road
- Good signage to find the premises off the main road

Prevent Public Nuisance

- As above to prevent crime and disorder

Protect Children from Harm

- As above to prevent crime and disorder

Signed:

[REDACTED]

[REDACTED]
Council

Llanwarne & District Group Parish

Date:

20th July 2020

From: [REDACTED]
Sent: 20 July 2020 21:21
To: Licensing <licensing@herefordshire.gov.uk>
Subject: Re: Gillow Cider - extension to licensing hours

CAUTION: This email originated from outside of the organisation. Do not click links or open attachments unless you recognise the sender and know the content is safe.

Good evening Licensing

Forgive me for not being explicit - I was forward thinking and didn't relate our representation to actual past experience. This is not speculation: when visiting friends who live next door (at St Owens Cross) a couple of years ago whilst the Gillow Cider festival was in full flow, we were easily able to hear every word of every song until late into the night. The assurance in the licence application that vibrations from music would not be heard elsewhere is absolute nonsense - who are they trying to kid?!

If nothing else, is the Licensing Office able to restrict the noise levels for the sanity of existing residents?

Yours

[REDACTED]
[REDACTED]

From: [REDACTED]
Sent: 19 July 2020 10:48
To: Licensing <licensing@herefordshire.gov.uk>
Subject: Gillow Cider - extension to licensing hours

CAUTION: This email originated from outside of the organisation. Do not click links or open attachments unless you recognise the sender and know the content is safe.

Dear Licensing Section

We have recently moved to St Owens Cross and have just found out that Gillow Cider has applied for an extension to licensing hours meaning that they will have the right to play amplified live and recorded music from 9 am to 11 pm every day of the year, except Fridays and Saturdays and stated holidays when that will extend to 1am in the morning.

We wish to make a representation against this as we feel that the noise levels will become highly disruptive to those living nearby and road safety will be compromised. The Cross is already a busy junction and this will increase significantly with the numbers of people

expected in the application, although we realise this is a maximum figure. Nevertheless, we hadn't anticipated having such a public facility on our doorstep when we moved (in December 2019) as the place was, and still is, closed. We will be most upset at having the inevitable noise level disturbing our rural peace, especially until late into the night and early morning. I often have to be up early at weekends to travel long distances the next day.

We wish this application to be refused, or seriously modified, thank you.

Yours faithfully

████████████████████

██████████

████████████████

██████████

██████████

**HEREFORDSHIRE COUNCIL
Licensing Act 2003**

**REPRESENTATION FORM – INTERESTED
PARTIES**

Please return this form, and any additional information within the statutory period to:
**The Licensing Section,
Herefordshire Council,
8 St Owen Street,
Hereford,
HR1 2PJ
licensing@herefordshire.gov.uk**

On making your representation please have regard to the 'Making Representations Guidance Notes' which further explains the process and the information that can be considered by the licensing authority.

When completing this form please print clearly and legibly.

Your Name: St Weonards Parish Council, [REDACTED] [REDACTED] [REDACTED]	Contact Telephone No. [REDACTED]
Address: [REDACTED] [REDACTED]	E-mail address: [REDACTED] [REDACTED]
Name & Address of premises you are making a representation about: Gillow Manor, St Owens Cross, Hereford HR2 8LE	

DATA PROTECTION ACT 1998. Please indicate by ticking here if you are not content for your personal details to be circulated as necessary prior to any hearing .

A representation must reflect one or more of the licensing objectives, therefore please write the details of your representation in the relevant boxes below:

<p>To Prevent Crime & Disorder</p> <ul style="list-style-type: none"> • When the Cider Festival has taken place in the past over a weekend in June, there has been evidence of anti social behaviour by attendees. The Police have been called in the past to deal with anti social behaviour and at times this has then spilled out to neighbouring premises • Neighbouring residential and business premises have suffered due to anti social behaviour such as damage or theft to their premises. The local farm/agricultural contractor has employed security guards during the Festival weekend to deal with the anti social behaviour and theft. • There is no access to public transport or taxi services and evidence of drinking and driving • Evidence of drug use has been found by local residents after the festival event
<p>Public Safety</p> <ul style="list-style-type: none"> • Poor visibility at the access junction off the A4137 (or B4521) main road on to the narrow lane. This road is the main route linking A49 to the A40 with heavy goods vehicles as well as smaller vehicles. The junction has had numerous accidents happen here • The lanes leading from the main road are narrow, no passing places to accommodate 2 way traffic, road suffers with potholes due to flooding and water run off during winter months. The junction and lanes are not lit. • Human faeces and drug paraphernalia found in surrounding fields and hedgerows
<p>To Prevent Public Nuisance</p> <ul style="list-style-type: none"> • During the festival local residents and surrounding neighbourhoods can hear the loud booming music into the early hours. The music vibrates across the neighbourhood.

- The loud noise has upset and scared farm animals in fields neighbouring Gillow Manor.
- Vehicles leaving the festival are not sympathetic to local residents and create loud noise from their vehicles and voices
- Trespassing and vandalism across neighbouring residents premises and businesses
- Rubbish thrown by attendees in the hedgerows along the roads leaving the Festival
- Human faeces found in surrounding fields and hedgerows to Gillow Manor
- Evidence of drug paraphernalia found in surrounding fields and hedgerows to Gillow Manor

To Protect Children from Harm

- Anti social behaviour witnessed by Parishioners as mentioned above
- Safeguarding concerns with the number of potential strangers roaming the neighbouring premises to neighbouring homes with children
- Disturbance of sleep due to loud music and loud noise from vehicles and voices cause fear when children are woken
- Safety of high volume of vehicles along narrow roads and by local residences premises
- Public Health issues with drug use and human faeces – as mentioned above
- Evidence of underage drinking

Signed: 

Date: 21st July 2020

Representation Form – Interested Parties Suggested Conditions

Premise: Gillow Manor Your name: St Weonards Parish Council

It would help us with this application if you could suggest conditions you would be happy for the premise to operate under to rectify the problems you are experiencing.

All suggested conditions shall be considered in line with the Herefordshire Council Licensing Policy, the Licensing Act 2003 and the Licensing Objectives.

To Prevent Crime and Disorder

- To hold a license for the production and sale of alcohol to the public only. No license for loud music. This would reduce amount of people attending at one time (ie a festival), reduce noise pollution from music, vehicles and people and anti social behaviour.

Public Safety

- To look at ways to directing traffic to eliminate the potential congestion of traffic on narrow country lanes
- Improve visibility of access of the A4137 main road
- Good signage to find the premises off the main road

Prevent Public Nuisance

- As above to prevent crime and disorder

Protect Children from Harm

- As above to prevent crime and disorder and address Safeguarding concerns

Signed: 

Date: 21st July 2020

If you have any queries about this form or are unsure of when the statutory period ends please contact the
Licensing Helpline on 01432 261761

HEREFORDSHIRE COUNCIL
Licensing Act 2003

REPRESENTATION FORM – INTERESTED PARTIES

On making your representation please have regard to the 'Making Representations Guidance Notes' which further explains the process and the information that can be considered by the licensing authority.

When completing this form please print clearly and legibly.

Please return this form, and any additional information within the statutory period to:
The Licensing Section,
Herefordshire Council,
8 St Owen Street,
Hereford,
HR1 2PJ
licensing@herefordshire.gov.uk

Your Name: ██████████	Contact Telephone No. ██████████
Address: ██████████ ██████████ ██████████ ██████████	E-mail address: ██
Please state your interest in the premises you are making a representation about: Local resident	
Name & Address of premises you are making a representation about: Mr D Fletcher- Gillow Manor/ Gillow Cider St. Owens Cross Hereford HR2 8LE	

DATA PROTECTION ACT 1998. Please indicate by ticking here if you are not content for your personal details to be circulated as necessary prior to any hearing .

A representation must reflect one or more of the licensing objectives, therefore please write the details of your representation in the relevant boxes below:

To Prevent Crime & Disorder
Public Safety The access to Gillow Manor/ Cider is via a narrow country lane which is accessed off the A4137. I am concerned about the amount of additional traffic that would be created by visitors to Gillow Cider through the day and night if this licence were to be granted. The entrance to the lane is on a dangerous corner of the A4137 and the road is already very dangerous and has seen multiple accidents over the years. I lived in a property for many years which was adjacent to the A4137 and so am familiar with the road.
To Prevent Public Nuisance The music at the Gillow Cider Festival has been very loud and so to have music playing seven days a week in a rural area would be detrimental to local residents.
To Protect Children from Harm My parents live at Gillow Farm and I have seen vehicles trying to enter the Gillow Cider Festival using the farms private drive. This would increase if the licence were to be granted. My children regularly visit and stay with my parents and I am concerned about the danger posed to them by vehicles using their drive. I am also concerned about the

loud music that would make it difficult for them to sleep.

Signed: [REDACTED]
Date: 22/07/2020



If you have any queries about this form or are unsure of when the statutory period ends please contact the Licensing Helpline on 01432 261761

Representation Form – Interested Parties Suggested Conditions

Premise: _____ Your name: _____

It would help us with this application if you could suggest conditions you would be happy for the premise to operate under to rectify the problems you are experiencing.

All suggested conditions shall be considered in line with the Herefordshire Council Licensing Policy, the Licensing Act 2003 and the Licensing Objectives.

To Prevent Crime and Disorder

Public Safety

Prevent Public Nuisance

Protect Children from Harm

Signed:

Date:

If you have any queries about this form or are unsure of when the statutory period ends please contact the Licensing Helpline on 01432 261761

HEREFORDSHIRE COUNCIL
Licensing Act 2003

**REPRESENTATION FORM – INTERESTED
PARTIES**

On making your representation please have regard to the 'Making Representations Guidance Notes' which further explains the process and the information that can be considered by the licensing authority.

When completing this form please print clearly and legibly.

Please return this form, and any additional information within the statutory period to:
**The Licensing Section,
Herefordshire Council,
8 St Owen Street,
Hereford,
HR1 2PJ
licensing@herefordshire.gov.uk**

Your Name: [REDACTED] [REDACTED]	Contact Telephone No. [REDACTED]
Address: [REDACTED] [REDACTED]	E-mail address: [REDACTED]
Please state your interest in the premises you are making a representation about: A neighbouring farming business to Gillow Manor	
Name & Address of premises you are making a representation about: Gillow Manor, St Owens Cross, Hereford HR2 8LE	

DATA PROTECTION ACT 1998. Please indicate by ticking here if you are not content for your personal details to be circulated as necessary prior to any hearing .

A representation must reflect one or more of the licensing objectives, therefore please write the details of your representation in the relevant boxes below:

To Prevent Crime & Disorder •
Public Safety <ul style="list-style-type: none">• The main public safety concerns we have is over the access to the premises via the main road and narrow country lanes. There is poor visibility at the access junction off the A4137 (or B4521) main road on to the narrow lanes leading to Gillow Manor. The A4137 road is the main route linking A49 to the A40 with heavy goods vehicles as well as smaller family vehicles. The junction has had numerous accidents witnessed here.• The lanes leading from the main road are narrow, no passing places to accommodate 2 way traffic, the road suffers with potholes due to flooding and water run off during winter months. The junction and lanes are not lit.
To Prevent Public Nuisance <ul style="list-style-type: none">• During the festival we can hear the loud booming music into the early hours. The music vibrates across our neighbourhood. You cannot escape the noise.• [REDACTED]
To Protect Children from Harm <ul style="list-style-type: none">• We have safeguarding concerns for local children with the number of potential strangers roaming the neighbouring premises to Gillow Manor.• Safety of high volume of vehicles along narrow roads and by local residences premises

Signed: [REDACTED]

Date: 21st July 2020

Representation Form – Interested Parties Suggested Conditions

Premise: Gillow Manor **Your name:** [REDACTED]
[REDACTED].

It would help us with this application if you could suggest conditions you would be happy for the premise to operate under to rectify the problems you are experiencing.

All suggested conditions shall be considered in line with the Herefordshire Council Licensing Policy, the Licensing Act 2003 and the Licensing Objectives.

To Prevent Crime and Disorder

- To hold a license for the production and sale of alcohol to the public only. No license for loud music. This would reduce amount of people attending at one time (i.e. a festival), reduce noise pollution from music, vehicles and people.

Public Safety

- To look at ways to directing traffic to eliminate the potential congestion of traffic on narrow country lanes
- Improve visibility of access of the A4137 main road
- Good signage to find the premises off the main road

Prevent Public Nuisance

Protect Children from Harm

- As above to help address Safeguarding concerns

Signed: [REDACTED]

Date: 21st July 2020

If you have any queries about this form or are unsure of when the statutory period ends please contact the **Licensing Helpline** on **01432 261761**

